

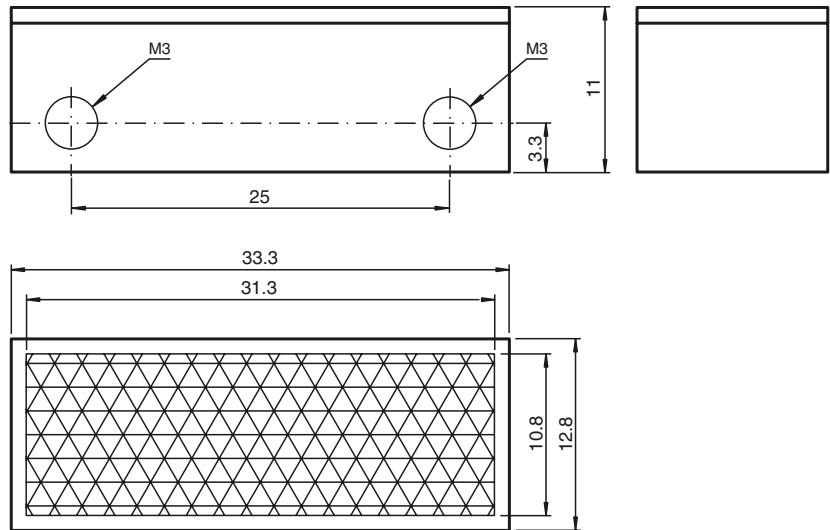

**Dimensions**



**Model Number**

**REF-H33**

Reflector with screw fixing

**Features**

- M3 metal threaded insert
- Same 25.4 mm hole spacing allows the use of ML100 mounting accessories

Threading M3

Threading M3

**Accessories**

**OMH-10**

Mounting aid

**OMH-ML100-01**

Mounting bracket

**OMH-ML100-02**

Mounting bracket

**OMH-ML100-03**

Mounting aid for round steel  $\varnothing$  12 mm or sheet 1.5 mm ... 3 mm

**OMH-ML100-04**

Mounting bracket

**OMH-ML100-05**

Mounting bracket

**Technical data**

**General specifications**

Construction type rectangular

**Ambient conditions**

Ambient temperature -25 ... 65 °C (-13 ... 149 °F)

**Mechanical specifications**

Material PMMA/ABS

Dimensions 33.3 mm x 12.8 mm x 11 mm

Mounting M3 metal threaded insert

Release date: 2014-06-03 08:27 Date of issue: 2014-06-03 232251\_eng.xml