



Datenblatt - Fiche technique - Data sheet

21.17.0002



ROLINE Keystone LWL-Adapter LC/LC Duplex, Multimode, OM4

ROLINE Raccord optique LC/LC duplex multimode, Keystone, OM4

ROLINE Fiber Optic Keystone Jack, LC/LC Duplex, Multimode, OM4

Item no.: 21.17.0002

ROLINE Fiber Optic Keystone Jack, LC Duplex, Multimode, OM4



Features:

- Keystone type adapter, LC sleeve, Duplex, multi-mode
- Material: ABS (keystone adapter) in black color
- Material: Ceramic (LC sleeve) in violet color

Page 1 of 3

keystone type LC Adapter

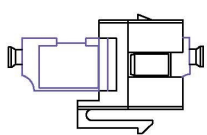
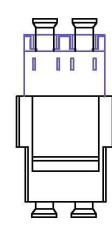
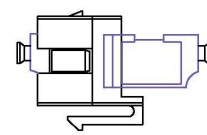
Put the LC duplex adapters into the 19" back panel

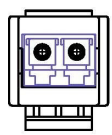
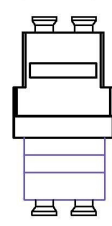
ROHS compliant

MATERIAL LIST:

| | | | | | | |
|-----|-------------------------------------------------------|-------------------------------|------------|------|---------|---------|
| ② | Keystone Type Adapter ABS Black | 1pcs | | | | |
| ① | LC Duplex Adapter (SC simplex footprint) color violet | 1pcs | | | | |
| NO. | SPECIFICATION STANDARD | QT' Y | REMARK | | | |
| | NEW | | 2012-11-29 | A | DRAWNBY | CHECKBY |
| BY | CHK | REVISION RECORD MODIFICATIONS | DATE | REV. | Fergus | |

| | | | |
|-------------------------------------------------------------|---------|----------|------------|
| Rotronic Co., Ltd. | | ITEM NO. | 21.17.0002 |
| ROLINE Fiber Optic Keystone Jack, LC Duplex, Multimode, OM4 | | | |
| DRAWNBY | CHECKBY | APPOBY | DATE |
| | | | 2012-11-29 |

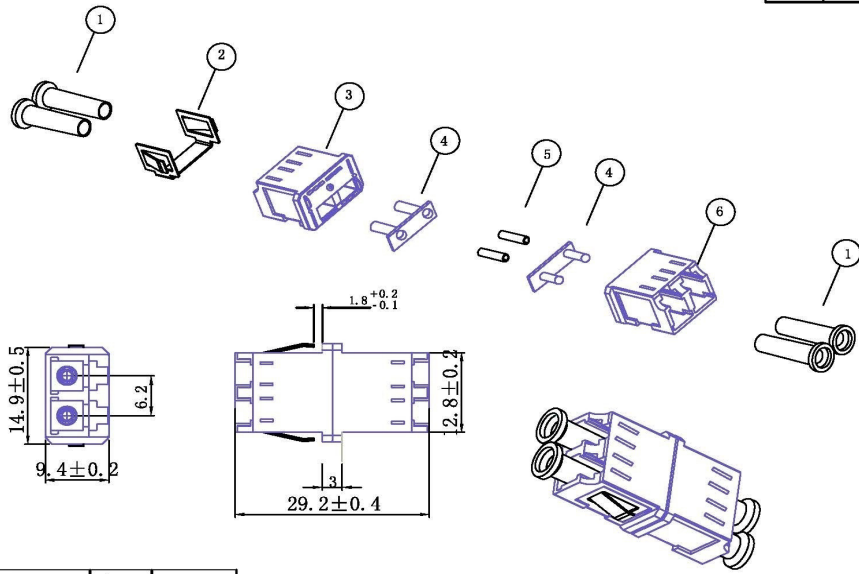

NOTE:
RoHS & Reach COMPLIANT

| | |
|-----------------------------|----------|
| Insertion Loss (dB) | ≤0.30 |
| Operating Temperature(° C) | -40 ~+85 |
| Storage Temperature(° C) | -40 ~+85 |

MATERIAL LIST:

| NO. | SPECIFICATION STANDARD | QT'Y | REMARK |
|-----|---------------------------------------|------|--------|
| ⑥ | LC Violet Body (SC simplex footprint) | 1pcs | |
| ⑤ | LC Sleeve ceramic (Multi-Mode) | 1pcs | |
| ④ | Violet bush | 2pcs | |
| ③ | LC Violet Body (SC simplex footprint) | 1pcs | |
| ② | LC Metal Mount | 1pcs | |
| ① | LC White Dust Cap | 4pcs | |

| | | | | | | | | | |
|-----|-----|-------------------------------|--|-------------------------------------------------------------|------|---------------------|---------|--------|------------|
| | | | | Rotronic Co., Ltd. | | ITEM NO. 21.17.0002 | | | |
| | | | | ROLINE Fiber Optic Keystone Jack, LC Duplex, Multimode, OM4 | | | | | |
| NEW | | | | 2012-11-29 | A | DRAWNBY | CHECKBY | APPOBY | DATE |
| BY | CHK | REVISION RECORD MODIFICATIONS | | DATE | REV. | Fergus | | | 2012-11-29 |

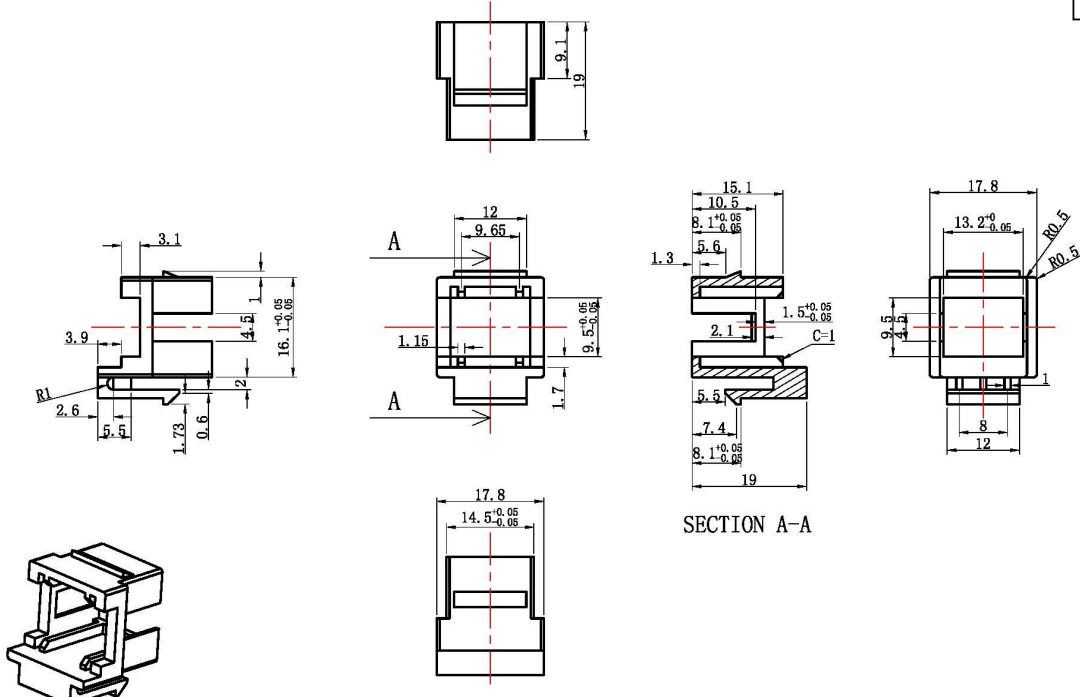

ROHS compliant
Keystone Type Adapter ABS Black

| | | | | | | | | | |
|-----|-----|-------------------------------|--|-------------------------------------------------------------|------|---------------------|---------|--------|------------|
| | | | | Rotronic Co., Ltd. | | ITEM NO. 21.17.0002 | | | |
| | | | | ROLINE Fiber Optic Keystone Jack, LC Duplex, Multimode, OM4 | | | | | |
| NEW | | | | 2012-11-29 | A | DRAWNBY | CHECKBY | APPOBY | DATE |
| BY | CHK | REVISION RECORD MODIFICATIONS | | DATE | REV. | Fergus | | | 2012-11-29 |