

Part number

# M7APE 16.32



## Brief description:

surface mounting housing with 2 levers, size "77.27", high construction, M32, E-Xtreme® version, IP66/IP67/IP69

| Product description              |  | General ordering information |                   |
|----------------------------------|--|------------------------------|-------------------|
| Version                          | E-Xtreme® V-TYPE version                             | EAN13 code                   | 8015747250481     |
| Series                           | Surface mounting housings with two levers            | <b>Packaging Information</b> |                   |
| Product type                     | with 2 stainless steel levers                        | Packaging length             | 475,00 mm         |
| Style                            | high construction                                    | Packaging height             | 220,00 mm         |
| Family                           | C7 - CV and M7 - MV enclosures, V-Type lever version | Packaging width              | 175,00 mm         |
| Size                             | size "77.27"   | Packaging weight             | 0,01 kg           |
| <b>Technical data</b>            |  | Packaging volume             | 18,29 dm³         |
| Material                         | metal  | Packaging description        | Carton box        |
| IP degree of protection          | IP66/IP67/IP69                                       | Packaging quantity           | 10 Pcs            |
| Cable entry                      | M32  | Packaging EAN code           | 8015747250597     |
| <b>Further technical details</b> |  | Sub-packaging weight         | 0,01 kg           |
| Weight                           | 1,00 g   | Sub-packaging description    | Plastic packaging |
|                                  |  | Sub-packaging quantity       | 5 Pcs             |
|                                  |  | Sub-packaging EAN barcode    | 8015747250603     |

Part number

# M7APE 16.32



## Catalogue drawings

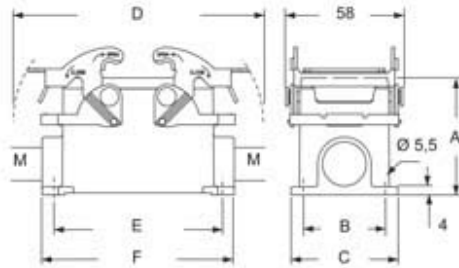

| type     | A  | B  | C  | D     | E   | F   |
|----------|----|----|----|-------|-----|-----|
| M7PE 16  | 63 | 45 | 57 | 142,5 | 105 | 117 |
| M7APE 16 | 77 | 45 | 57 | 142,5 | 105 | 117 |