





## GDM Series Rectangular Receptacle Connectors, Type A

### Technical Information

Product Description		
Order Designation	GSA 2000 A	GSA 3000 A
		
<b>Description</b>	Male appliance connector with retaining nut, no screws, longitudinal holes, closed nut	Male appliance connector with retaining nut, 2 screws M3 x 10 and 1 screw M3 x 5, open nut
<b>RoHS-Compliant (2011/65/EU)</b>	Yes	
<b>(Construction Type) Standard</b>	DIN EN 175 301-803-A	
<b>Approvals</b>	UR, VDE, SEV, CSA	
Technical Data		
<b>No. of Pins</b>	2 + PE	3 + PE
<b>Ambient Temperature</b>	-40 °C to +125 °C	
<b>Housing/Grip/Screw Coupling</b>	PA	
<b>Contact Holder</b>	PA	
<b>Contact</b>	SN	
Mechanical Data		
<b>Degree of Protection</b>	IP65 (gasket required; only when mounted and mated with Hirschmann/Lumberg counterparts)	
<b>Terminal Type</b>	Solder (ground contact: screw)	
Electrical Data		
<b>Circuit</b>	No protection circuit	
<b>Contact Resistance</b>	≤ 4 mΩ	
<b>Rated Voltage</b>	400 V AC/DC	
<b>Rated Current</b>	16 A	
<b>Pollution Degree</b>	3	
Accessories		
<b>Scope of Delivery or Accessories (incl.)</b>	Items supplied in one package: 200	
<b>Accessories to be Ordered Separately</b>	(NBR) flat gasket GSA 200-4, Order No. 730843002 (EPDM) flat gasket GSA 200-7, Order No. 730268003	

### Technical Drawing

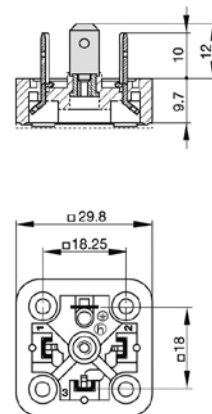
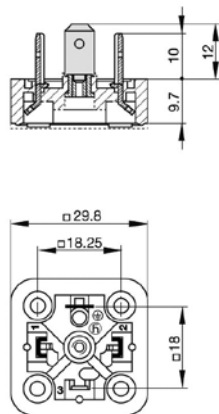

# Be Certain with Belden

## Order Information

Order No.	Order Designation	No. of Pins	Terminal Type
932592500	GSA 2000 A black	2 + PE	solder (ground contact: screw)
932598500	GSA 3000 A black	3 + PE	solder (ground contact: screw)