

# VSP003

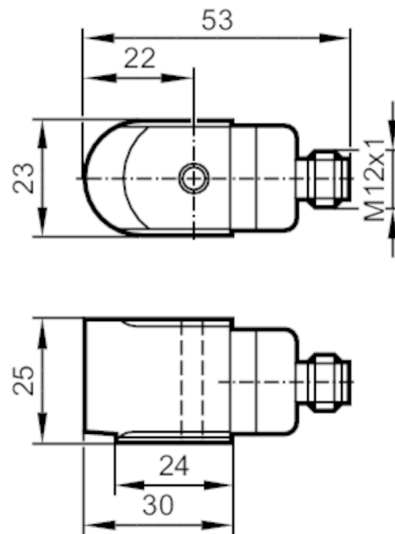

## Acceleration sensor

VIBRATION SENSOR



### Product characteristics

Measuring range of vibration [g]	50
Frequency range [Hz]	1.5...16000
Measuring principle	piezo-electric

### Application

Design	for connection to external diagnostic electronics VSE
--------	---

### Electrical data

Operating voltage [V]	10...12 DC
Current consumption [mA]	0.5...8
Reverse polarity protection	yes

### Measuring/setting range

Measuring range of vibration [g]	50
Frequency range [Hz]	1.5...16000
Measuring principle	piezo-electric
Max. transverse sensitivity [%]	5
Minimum measuring time [s]	1
Number of measurement axes	1

### Accuracy / deviations

Accuracy	± 10 %
Measuring sensitivity	100 mV/g

### Interfaces

Communication interface	IEPE
-------------------------	------

# VSP003



## Acceleration sensor

VIBRATION SENSOR

Operating conditions		
Ambient temperature	[°C]	-55...130
Storage temperature	[°C]	-55...130
Protection		IP 67

Tests / approvals		
EMC	EN 61326-1	: 2013

Mechanical data		
Weight	[g]	135
Type of mounting		M8 x 1,25
Materials		housing: stainless steel
Tightening torque	[Nm]	8

Remarks	
Pack quantity	1 pcs.

Electrical connection	
1	not used
2	L+ white
3	not used
4	0 V black

Connector: 1 x M12

