

FEATURES

- Ideal for test & development applications
- Miniature plug termination
- IEC colour coded
- The International Electrotechnical Commission (IEC) is an international standards organisation that prepares and publishes international standards.

RS PRO PTFE Single Shot IEC Exposed Junction Thermocouple with Miniature Plug - Type K 10m (32.8ft)

RS Stock No.: 8722641

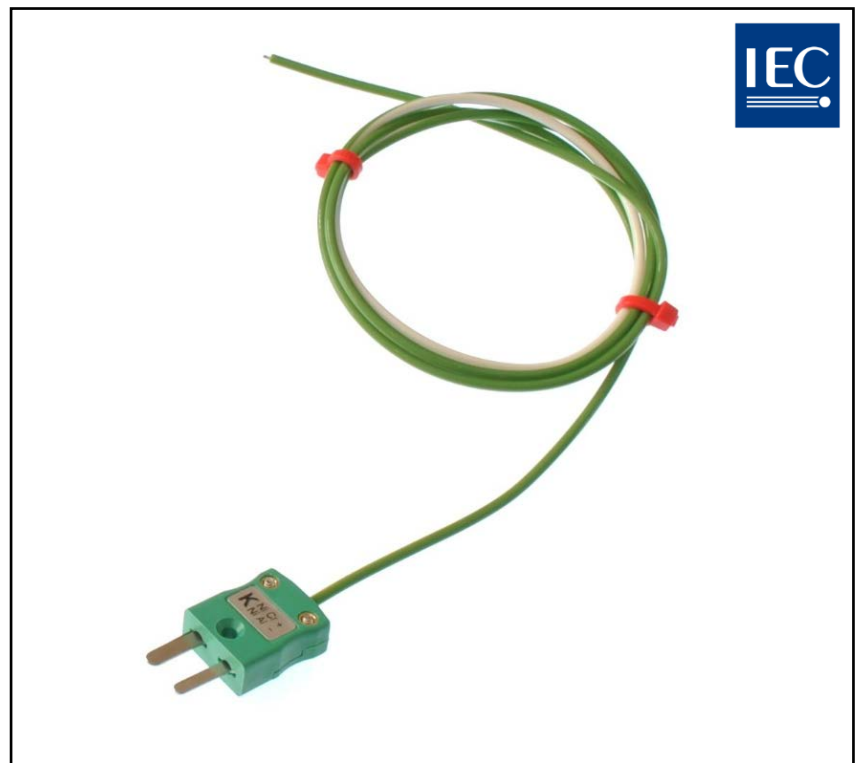

RS Professionally Approved Products bring to you professional quality parts across all product categories. Our product range has been tested by engineers and provides a comparable quality to the leading brands without paying a premium price.

Product Description

A very fast response PTFE insulated thermocouple, made from a unique single shot cable construction which provides a gas, steam and watertight insulation along the cable.

This sensor is ideally suited to temperature monitoring of test pieces in autoclave and aerospace applications.

General Specifications

General Description	Unique single shot cable construction Resistant to chemicals, oils and fluids. Suitable for aerospace applications and is widely used in autoclaves.
Sensor Type	Exposed Junction
Thermocouple Type	K
Cable Length	10m (32.8ft)
Cable Type	PTFE
Core / Strands	1/0.376mm
Termination Type	Terminated with a miniature flat pin plug (Plug max temp 220°C / 428°F)
Max. Temperature	+250°C (+482°F)
Standards Met	IEC-584-3
Connector Type	Plug
Connector Size	Miniature

Approvals

RoHS Compliant	Yes
Standards Met	IEC-584-3

Similar Products Range

Thermocouple Type	Core / Strands	1m (3.3ft)	2m (6.56ft)	3m (9.84ft)	5m (16.4ft)	10m (32.8ft)
K	1/0.376mm	8722635	8722638	2209509	8722632	8722641
T	1/0.376mm	8722644	8722648	2209510	8722657	8722650

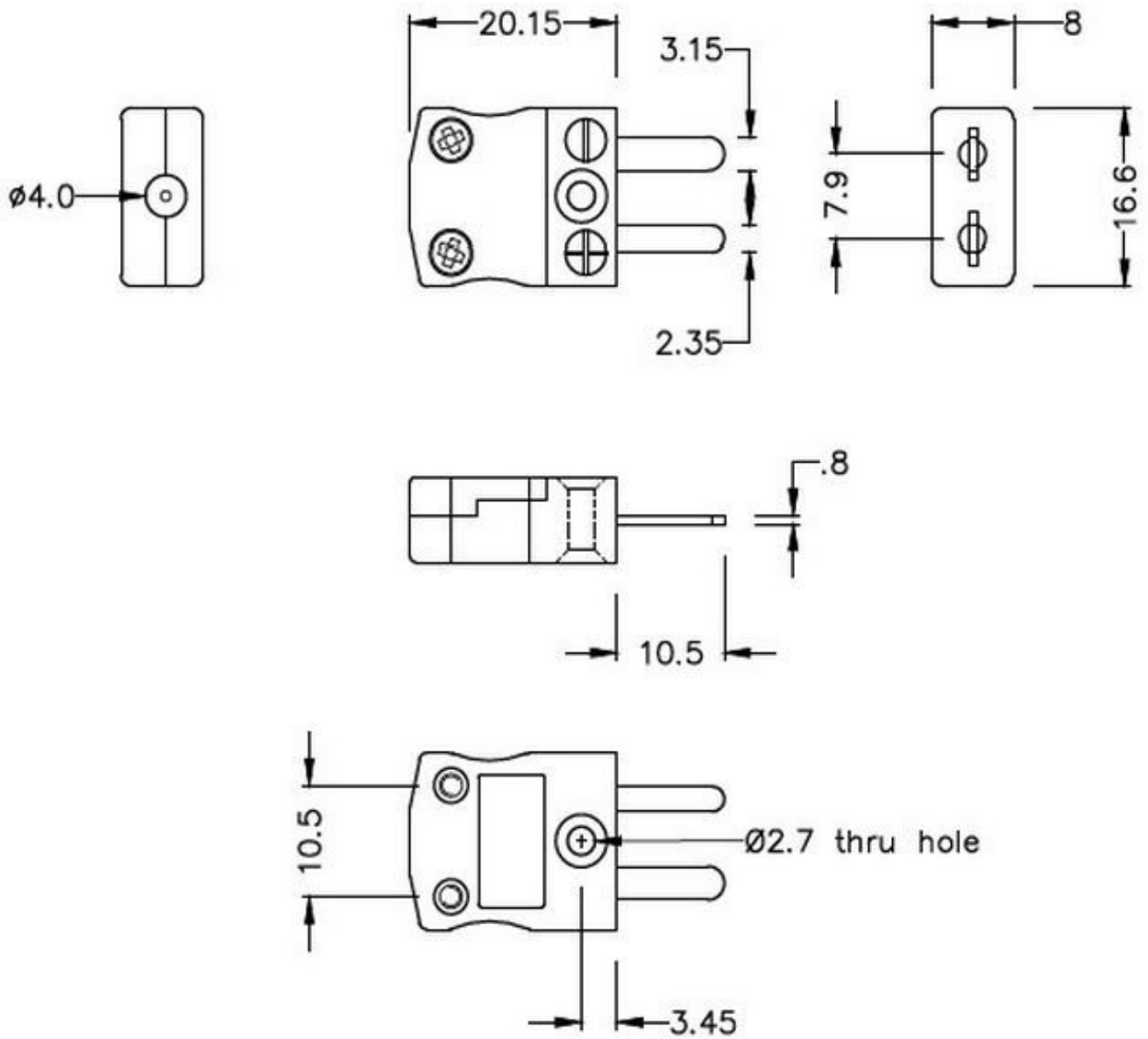

Miniature in-line Plug
(dimensions in mm)

RS Components is a leading provider for Automation and Control Gear, below is a selection of best selling products:



Temperature.
It matters

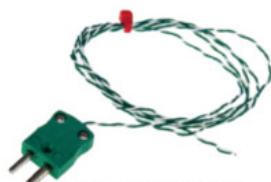

Exposed Junction Thermocouples

Including exposed junctions with fitted or moulded miniature plug and insulated leads, ideal for test and development applications. 1, 2, 3, 5 & 10m lengths available in IEC or ANSI colours.

Best Sellers



ANSI Type K Exposed Junction
RS 814-0134
Allied 70656459



ANSI Type K High Temp Exposed Junction
RS 131-4749
Allied 71080908



IEC Type K Exposed Junction
RS 363-0250
Allied 70643600



Thermocouple & PRT Cable

Thermocouple cables are available in IEC or ANSI colour codes. Insulation types include PFA, PTFE, PVC & Fibreglass. Available spool lengths include 10, 25, 50, 100 and 200m.

Best Sellers



IEC PVC Insulated Flat Pair
RS 219-4573
Allied 70641630



ANSI PFA Insulated Twin Twisted
RS 814-0030
Allied 70656106



IEC Glassfibre Insulated Flat Pair
RS 236-3836
Allied 70641730

Calibration

Whether it's existing equipment or a new purchase, you need to have confidence in the accuracy of your measurements.

That's where our calibration service can help.

Purchase new products with confidence.

A certificated calibrated sensor straight out of the box, ready to use.



RTD Detectors

Wire-wound type provides greater accuracy and stability but are vulnerable to shock.

Flat film type are resistant to shock and have quicker thermal response times.

Various lengths and diameters available, in class A, B and 1/10th Din.

Best Sellers



ANSI SYSCAL Type K Mineral Insulated Thermocouple
RS 181-7296



IEC SYSCAL Type K Mineral Insulated Thermocouple
RS 181-7288



IEC SYSCAL Type J Mineral Insulated Thermocouple
RS 181-7305

Best Sellers



PT1000 Thin Film Detector
RS 362-9907
Allied 70643582



PT100 Wire Wound Detector
RS 611-7839
Allied 70646151



PT100 Wire Wound Detector
RS 362-9799
Allied 70643577

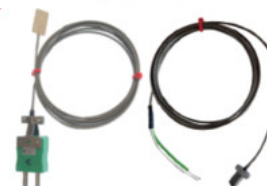

Fabricated and Specialist Thermocouples

Styles include; Magnet, Washer, Nozzle, Leaf, Bayonet & Bolt thermocouple. Various lengths and calibration types available.

Best Sellers



Magnet Thermocouple
RS 762-1115
Allied 70651739



Heavy Duty Thermocouple
RS 762-1128
Allied 70651743



Rubber Patch Thermocouple
RS 290-5036
Allied 70642886



Thermocouple Connectors

Range of miniature or standard thermocouple connectors.

Available in thermocouple types K, J, T, E, N, RS, B, and copper. IEC, ANSI & JIS colour codes available.

Best Sellers



IEC Thermocouple Plug
RS 455-9764
Allied 70644391



ANSI Thermocouple Socket
RS 769-1127
Allied 70652125



IEC Thermocouple PCB Socket
RS 381-7570
Allied 70643749

RS Components is a leading provider for Automation and Control Gear, below is a selection of best selling products:



Mineral Insulated Thermocouples

Available in various calibration types with a variety of terminations. These include; Thermocouple plugs, Terminal heads and Thermocouple cable

Best Sellers

- IEC Thermocouple with PTFE Cable**
RS 397-1236
Allied 70643843
- IEC Thermocouple with Mini Plug**
RS 397-1488
Allied 70643863
- ANSI Thermocouple with PFA Cable**
RS 847-1019
Allied 70658112



NEW PRODUCTS

NEW PRODUCTS
RS PRO, the own brand of RS Components, offers an unbeatable range of products across all industries with quality you can trust.

New products are constantly added to improve the offering of our product range.

- Brake Pad Temp Sensor**
RS 200-0601
Allied 72173869
- RTD Temp Sensor Hirschmann Style**
RS 200-0594
Allied 72173862
- Washer Thermocouple**
RS 200-0616
Allied 72173882



Sensors with Industrial Terminal Heads

Industrial sensors housed in a stainless steel sheath and terminal head protection to IP67. Available as a thermocouple or Pt100.

Best Sellers

- Type K 300mm Long**
RS 787-7829
Allied 70653306
- Type K 200mm Long**
RS 787-7816
Allied 70653303
- Type K 100mm Long**
RS 787-7804
Allied 70653235



L60 Fine Wire Thermocouple Welder

The Thermocouple Welder is a compact, simple-to-use instrument designed for thermocouple and fine wire welding. Supplied with foot switch, spare electrodes, pliers & safety glasses, impact clip and pen plate.

Best Sellers

- L60 Fine Wire Thermocouple Welder**
RS 363-0351
Allied 70825788
- Accessories for welder**

www.rspro.com



www.alliedelec.com