

THIS COPY IS PROVIDED ON A RESTRICTED BASIS AND IS NOT TO BE USED IN ANY WAY DETRIMENTAL TO THE INTERESTS OF PANDUIT CORP.

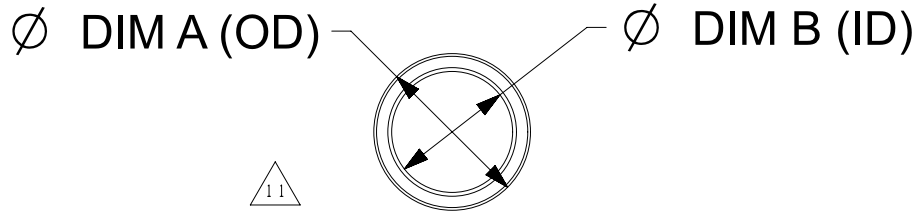

Material: Nylon 6				
SLIT PART NUMBERS	NON-SLIT PART NUMBERS	DIM A Target (OD)	DIM B Target (ID)	Wall Thickness
CLT25N-*	CLTS25N-*	0.378 [9.60]	0.281 [7.14]	.007-.023 [0.18-0.51]
CLT35N-*	CLTS35N-*	0.417 [10.59]	0.323 [8.20]	
CLT38N-*	CLTS38N-*	0.535 [13.59]	0.421 [10.69]	
CLT50N-*	CLTS50N-*	0.675 [17.15]	0.518 [13.16]	
CLT62N-*	CLTS62N-*	0.815 [20.70]	0.665 [16.89]	
CLT75N-*	CLTS75N-*	0.933 [23.70]	0.762 [19.35]	
CLT100N-*	CLTS100N-*	1.114 [28.30]	0.917 [23.29]	.008-.031 [0.20-0.79]
CLT125N-*	CLTS125N-*	1.524 [38.71]	1.303 [33.10]	
CLT150N-*	CLTS150N-*	1.728 [43.89]	1.484 [37.69]	
CLT188N-*	NA	2.157 [54.79]	1.870 [47.50]	

Material: Polyethylene				
SLIT PART NUMBERS	NON-SLIT PART NUMBERS	DIM A Target (OD)	DIM B Target (ID)	Wall Thickness
CLT25F-*	CLTS25F-*	0.378 [9.60]	0.281 [7.14]	.007-.023 [0.18-0.51]
CLT35F-*	CLTS35F-*	0.417 [10.59]	0.323 [8.20]	
CLT38F-*	CLTS38F-*	0.535 [13.59]	0.421 [10.69]	
CLT50F-*	CLTS50F-*	0.675 [17.15]	0.518 [13.16]	
CLT62F-*	CLTS62F-*	0.815 [20.70]	0.665 [16.89]	
CLT75F-*	CLTS75F-*	0.933 [23.70]	0.762 [19.35]	
CLT100F-*	CLTS100F-*	1.114 [28.30]	0.917 [23.29]	.008-.031 [0.20-0.79]
CLT125F-*	CLTS125F-*	1.524 [38.71]	1.303 [33.10]	
CLT150F-*	CLTS150F-*	1.728 [43.89]	1.484 [37.69]	
CLT188F-*	NA	2.157 [54.79]	1.870 [47.50]	



\* NOTES:

- SEE [www.panduit.com](http://www.panduit.com) FOR PART NUMBER SUFFIX DESIGNATION FOR PACKAGE SIZE, PART MATERIAL AND PART COLOR.
- FOR ROLL SIZES LARGER THAN 10 FEET, SPLICES MAY OCCUR.
- SLIT PART NUMBERS HAVE ONE CONTINUOUS SLIT ALONG ENTIRE LENGTH TUBING.

TITLE					Slit & Non-slit Corrugated Loom Tubing				
CUSTOMER DRAWING									
ITEM REVISION NAME					G03597BN/02				
DATASET FILE NAME					G03597BN_DC_GB0222BP_11/00A				
UNLESS OTHERWISE SPECIFIED, DIMENSIONAL TOLERANCES ARE: IN (mm)									
.X ± .XXX ± .050 (1.27)									
.XX ± ANGLES ±					MATERIAL: Nylon 6 or Polyethylene				
THIRD ANGLE PROJECTION					DRAWING NUMBER: GB0222BP				
DRAWN BY	DATE	CHK	SCALE						
CPE	9-18-97	VJS	NONE	SHT 1 OF 1					
				SIZE	A				

REV	DATE	BY	CHK	APR	DESCRIPTION	ECN
11	4/2/2020	RVU	DJW	JHAC	REBUILD MODEL AND REDRAWING DRAWING. ADDED NEW TWO TABLE TO INCLUDE SLIT AND NON-SLIT. CHANGED ALL A DIM AND B DIM MEASUREMENTS. UPDATED TITLE AND NOTES.	GAECN05626
10	02.10.15	BDK	VJS	RGRO	E. ADDED DUAL RIB PROFILE AND DETAIL F. REMOVED DENSITY FROM POLYETHYLENE	GB0222BP
09	5/09/14	BWG	VJS	JADE	REVISD DIMENSIONS AND WEIGHTS, REMOVED PREVIOUS REVISION BALLONS FOR CLARITY AND UPDATED TITLE BORDER, ADDED * TO PART NUMBERS, REVISED NOTE 1.	GB0222BP/09