

E 20606

FE-11-E-A-M4/2m

Einweglichtschränke

Anschluß an
Fiberoptikverstärker
Bauform OBF

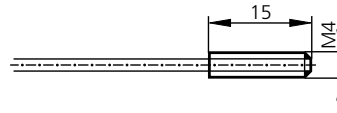

Kerndurchmesser 1 mm

Reichweite	[mm]
-------------------	-------------

200

Tastkopf	
Ummantelung	
Lichtleiter	
Umgebungstemperatur	[°C]
Gesamtlänge ¹⁾	[mm]
Minimaler Biegeradius	[mm]

Aluminium
PE (Polyethylen)
PMMA
-40 ... +70
2000
30

¹⁾ Schneidewerkzeug für Fiberoptiken (gesondert zu bestellen) siehe Datenblatt Zubehör OBF, Bestell-Nr. E 20600

E 20606

FE-11-E-A-M4/2m

Through-beam sensor

Connection to
fibre optic amplifier
type OBF

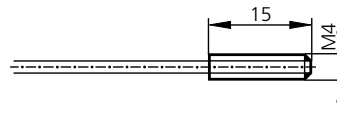

core diameter 1 mm

Range	[mm]	200
Sensing head		aluminium
Sheating		PE (polyethylene)
Fibre		PMMA
Operating temperature	[°C]	-40 ... +70
Total length ¹⁾	[mm]	2000
Minimal bending radius	[mm]	30

¹⁾ cutter for fibre optics (to be ordered separately), see data sheet E 20600

E 20606

FE-11-E-A-M4/2m

Fibre optique barrage

Raccordement
sur l'amplificateur
boîtier OBF

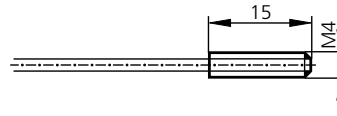

∅ fibre 1mm

Portée	[mm]	200
Tête de détection		aluminium
Revêtement		PE (polyéthylène)
Fibre		PMMA
Température ambiante	[°C]	-40 ... +70
Longueur ¹⁾	[mm]	2000
Rayon de courbure minimum	[mm]	30