



SOLID-STATE TIME-DELAY AUXILIARY SWITCH,  
OFF-DELAY WITHOUT AUXILIARY VOLTAGE RELAY  
1 CO CONTACT 24...240V AC/DC TIME RANGE  
0.05...100S FOR SNAPPING ONTO THE FRONT; FOR  
3RT2 S00-S2 CONTACTORS SCREW TERMINALS  
INTEGRATED VARISTOR FOR DAMPING  
CONTACTOR COILS

### General technical data:

|   |    |   |
|---|----|---|
| <b>product brand name</b>   |    | SIRIUS  |
| <b>Product designation</b>  |    | auxiliary switch                                  |
| <b>Design of the product</b>  |    | off-delayed without auxiliary voltage             |
| <b>Protection class IP on the front</b>                                       |    | IP20  |
| <b>Protection class IP of the terminal</b>                                    |    | IP20  |
| <b>Degree of pollution</b>  |    | 3   |
| Insulation voltage with degree of pollution 3 Rated value                     | V  | 300   |
| <b>Installation altitude at height above sea level maximum</b>                | m  | 2 000   |
| <b>Ambient temperature</b>  |    |   |
| • during storage  | °C | -40 ... +85                                       |
| • during operation  | °C | -25 ... +60                                       |
| • during transport  | °C | -40 ... +85                                       |
| EMI immunity acc. to IEC 60947-1  |    | ambience A (industrial sector)                    |
| EMC emitted interference acc. to IEC 60947-1                                  |    | CISPR11, ambience A (industrial sector)           |
| Conducted interference due to burst acc. to IEC 61000-4-4                     |    | 2 kV network connection / 1 kV control connection |
| Conducted interference due to conductor-earth surge acc. to IEC 61000-4-5     |    | 2 kV  |
| Conducted interference due to conductor-conductor surge acc. to IEC 61000-4-5 |    | 1 kV  |
| Electrostatic discharge acc. to IEC 61000-4-2                                 |    | 8 kV  |
| Field-bound parasitic coupling acc. to IEC 61000-4-3                          |    | 10 V/m  |
| <b>Shock resistance</b>   |    | 15g / 11 ms                                       |

|  |    |                        |
|--|----|------------------------|
| <b>Vibration resistance</b>  |    | 10 ... 55 Hz / 0.35 mm |
| <b>Surge voltage resistance Rated value</b>  | kV | 4                      |
| <b>Equipment marking acc. to DIN 40719 extended according to IEC 204-2 acc. to IEC 750</b> |    | K                      |
| <b>Equipment marking acc. to DIN EN 61346-2</b>  |    | K                      |
| <b>Adjustable time</b>   | s  | 0.05 ... 100           |
| <b>Switching function</b>  |    |                        |
| • ON-delay   |    | No                     |
| • OFF delay  |    | Yes                    |
| <b>Switching function</b>  |    |                        |
| • with control signal  |    |                        |
| — OFF delay  |    | No                     |
| — pulse-shaping  |    | No                     |
| • without control signal OFF delay   |    | Yes                    |
| <b>Product component semi-conductor output</b>   |    | No                     |
| <b>Product expansion</b>   |    |                        |
| • optional remote control  |    | No                     |
| • required remote control  |    | No                     |
| <b>Product function</b>  |    |                        |
| • star-delta circuit   |    | No                     |
| • at the relay outputs Switchover delayed/without delay                                    |    | No                     |

#### Control circuit/ Control:

|  |    |               |
|--|----|---------------|
| <b>Design of the surge suppressor</b>  |    | with varistor |
| Supply voltage required Auxiliary voltage                                    |    | No            |
| Type of voltage of the control supply voltage                                |    | AC/DC         |
| <b>Control supply voltage frequency 1</b>                                    | Hz | 50 ... 60     |
| <b>Control supply voltage 1</b>  |    |               |
| • for DC   | V  | 24 ... 240    |
| • with AC  |    |               |
| — at 50 Hz   | V  | 24 ... 240    |
| — at 60 Hz   | V  | 24 ... 240    |
| Operating range factor control supply voltage rated value of the magnet coil |    | 0.85 ... 1.1  |

#### Auxiliary circuit:

|  |   |     |
|--|---|-----|
| <b>Operating current of the auxiliary contacts</b> |   |     |
| • at AC-15 at 250 V                                | A | 3   |
| • at DC-13   |   |     |
| — at 24 V  | A | 1   |
| — at 125 V   | A | 0.2 |
| — at 250 V   | A | 0.1 |

### Installation/ mounting/ dimensions:

|  |    |         |
|--|----|---------|
| <b>Mounting type</b>                               |    | clip-on |
| <b>Width</b>                                       | mm | 45      |
| <b>Height</b>                                      | mm | 38      |
| <b>Depth</b>                                       | mm | 74      |
| <b>Required spacing with side-by-side mounting</b> |    |         |
| • upwards  | mm | 0       |
| • downwards  | mm | 0       |
| • forwards   | mm | 0       |
| • Backwards  | mm | 0       |
| • at the side                                      | mm | 0       |
| <b>Required spacing for grounded parts</b>         |    |         |
| • upwards  | mm | 0       |
| • downwards  | mm | 0       |
| • forwards   | mm | 0       |
| • Backwards  | mm | 0       |
| • at the side                                      | mm | 0       |
| <b>Required spacing for live parts</b>             |    |         |
| • upwards  | mm | 0       |
| • downwards  | mm | 0       |
| • forwards   | mm | 0       |
| • Backwards  | mm | 0       |
| • at the side                                      | mm | 0       |

### Connections/ Terminals:

|   |  |  |
|---|--|--|
| Type of electrical connection for auxiliary and control current circuit |  | screw-type terminals   |
| Product function removable terminal for auxiliary and control circuit   |  | Yes  |
| <b>Type of connectable conductor cross-section</b>                      |  |  |
| • for auxiliary contacts  |  |  |
| — solid   |  | 0.5 ... 4 mm <sup>2</sup> , 2x (0.5 ... 2.5 mm <sup>2</sup> )        |
| — finely stranded   |  |  |
| — with core end processing  |  | 1x (0.5 ... 2.5 mm <sup>2</sup> ), 2x (0.5 ... 1.5 mm <sup>2</sup> ) |
| • for AWG conductors for auxiliary contacts                             |  | 2x (20 ... 14)   |

### Certificates/ approvals:

|                                   |  |               |
|-----------------------------------|--|---------------|
| <b>Certificate of suitability</b> |  | CE / UL / CSA |
| • EC declaration of conformity    |  | Yes           |
| • CSA-approval                    |  | Yes           |
| • UL approval                     |  | Yes           |

## General Product Approval



CCC



CSA



UL



## Test Certificates

[Type Test  
Certificates/Test  
Report](#)

[Special Test  
Certificate](#)

## Shipping Approval



ABS



BUREAU  
VERITAS



DNV



GL



LRS



RMRS

## other

[Environmental  
Confirmations](#)

[Declaration of  
Conformity](#)

[other](#)

## UL/CSA ratings:

Contact rating of the auxiliary contacts acc. to UL

B300 / R300

## Further information

**Information- and Downloadcenter (Catalogs, Brochures,...)**

<http://www.siemens.com/industrial-controls/catalogs>

**Industry Mall (Online ordering system)**

<http://www.siemens.com/industrymall>

**Cax online generator**

<http://support.automation.siemens.com/WW/CAXorder/default.aspx?lang=en&mlfb=3RA28151AW10>

**Service&Support (Manuals, Certificates, Characteristics, FAQs,...)**

<http://support.automation.siemens.com/WW/view/en/3RA28151AW10/all>

**Image database (product images, 2D dimension drawings, 3D models, device circuit diagrams, EPLAN macros, ...)**

<http://www.automation.siemens.com/bilddb/index.aspx?attID9=3RA28151AW10&lang=en>

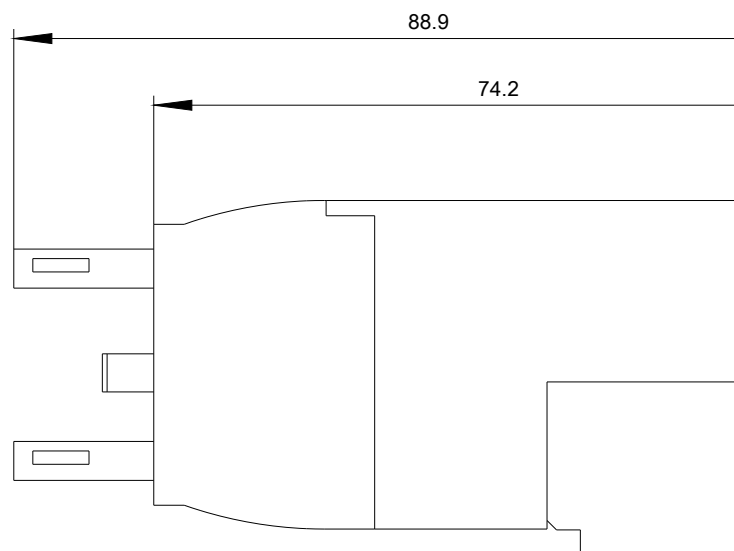
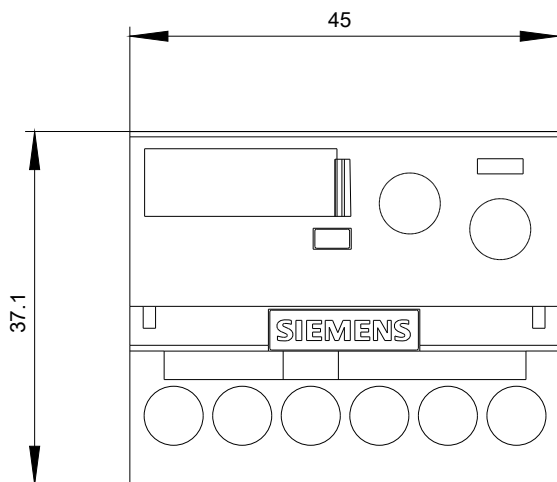

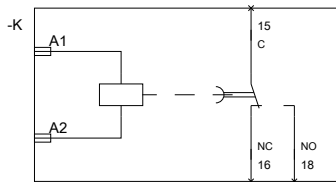

last modified:

09.03.2015