



TIME RELAY, SOLID-STATE MULTI-FUNCTION 1 CHANGEOVER CONTACT, 7 FUNCTIONS, 7 TIME SETTING RANGES 0.05S...100H, AC/DC 12... 240 V, WITH LED, SCREW TERMINAL

General technical data:		
product brand name		SIRIUS
Product designation		timing relay
Adjustable time	s	0.05 ... 360 000
Protection class IP		IP40
<ul style="list-style-type: none"> on the front of the terminal 		IP20
Shock resistance		15g / 11 ms
Degree of pollution		2
mounting position		any
Supply voltage required Auxiliary voltage		Yes
Product function		No
<ul style="list-style-type: none"> star-delta circuit with auxiliary voltage pulse-shaping at the relay outputs Switchover delayed/without delay 		No
Product component semi-conductor output		No
Product expansion		No
<ul style="list-style-type: none"> optional remote control required remote control 		No
Installation altitude at height above sea level maximum	m	2 000
Ambient temperature		-40 ... +70
<ul style="list-style-type: none"> during storage during operation 	°C	-25 ... +55

• during transport	°C	-40 ... +70
Relative humidity during operation	%	15 ... 85
EMI immunity acc. to IEC 60947-1		corresponds to degree of severity 3
EMC emitted interference acc. to IEC 60947-1		IEC61000-6-3 (residential area)
Conducted interference due to burst acc. to IEC 61000-4-4		2 kV network connection / 1 kV control connection
Conducted interference due to conductor-earth surge acc. to IEC 61000-4-5		2 kV
Conducted interference due to conductor-conductor surge acc. to IEC 61000-4-5		1 kV
Electrostatic discharge acc. to IEC 61000-4-2		4 kV contact discharge / 8 kV air discharge
Field-bound parasitic coupling acc. to IEC 61000-4-3		10 V/m
Vibration resistance		10 ... 55 Hz / 0.35 mm
Surge voltage resistance Rated value	V	4 000
Insulation voltage Rated value	V	300
Active power loss total typical	W	2
Equipment marking acc. to DIN 40719 extended according to IEC 204-2 acc. to IEC 750		K
Equipment marking acc. to DIN EN 61346-2		K

Switching Function:

Switching function		
• passing make contact		Yes
• fixed clock cycle beginning with pulse		No
• variably clocked start with interval		No
• OFF delay		No
• variably clocked start with impulse		No
• with control signal		
— passing break contact		Yes
— OFF delay		Yes
— additive ON delay		Yes
— passing break contact/instantaneous		No
— OFF delay/instantaneous		No
— ON-delay/OFF-delay/instantaneous		No
— pulse-shaping/instantaneous		No
— pulse-shaping		No
— ON-delay/instantaneous contact		No
• ON-delay/instantaneous contact		No
• passing make contact/instantaneous contact		No
• fixed clock cycle beginning with interval		Yes
• without control signal OFF delay		No
• ON-delay		Yes

- fixed clock cycle beginning with interval/instantaneous contact

No

Control circuit/ Control:

Type of voltage of the control supply voltage		AC/DC
Control supply voltage frequency 1	Hz	50 ... 60
Control supply voltage 1		
<ul style="list-style-type: none"> • with AC <ul style="list-style-type: none"> — at 50 Hz — at 60 Hz • for DC 	V	12 ... 240
	V	12 ... 240
	V	12 ... 240
Operating range factor control supply voltage rated value of the magnet coil		0.85 ... 1.1

Auxiliary circuit:

Operating current of the auxiliary contacts		
<ul style="list-style-type: none"> • at AC-15 <ul style="list-style-type: none"> — at 24 V — at 250 V • at DC-13 <ul style="list-style-type: none"> — at 24 V — at 125 V — at 250 V — maximum 	A	3
	A	3
	A	1
	A	0.22
	A	0.1
	A	1
Number of NC contacts		
<ul style="list-style-type: none"> • delayed switching • instantaneous contact 		0
		0
Number of NO contacts		
<ul style="list-style-type: none"> • delayed switching • instantaneous contact 		0
		0
Number of CO contacts		
<ul style="list-style-type: none"> • delayed switching • instantaneous contact 		1
		0

Short-circuit:

Design of the fuse link for short-circuit protection of the auxiliary switch required		fuse gL/gG: 4 A
--	--	-----------------

Installation/ mounting/ dimensions:

Mounting type		snap-on fastening on 35 mm standard rail
Width	mm	17.5
Height	mm	90
Depth	mm	66.7
Required spacing		
<ul style="list-style-type: none"> • with side-by-side mounting 		

— upwards	mm	0
— downwards	mm	0
— forwards	mm	0
— Backwards	mm	0
— at the side	mm	0
• for grounded parts		
— upwards	mm	0
— downwards	mm	0
— forwards	mm	0
— Backwards	mm	0
— at the side	mm	0
• for live parts		
— upwards	mm	0
— downwards	mm	0
— forwards	mm	0
— Backwards	mm	0
— at the side	mm	0

Connections/ Terminals:

Type of electrical connection		
• Plug-in socket		No
• for auxiliary and control current circuit		screw-type terminals
Type of connectable conductor cross-section		
• for auxiliary contacts		
— solid		1x (0.2 ... 2.5 mm ²)
— finely stranded		
— with core end processing		0.25 ... 1.5 mm ²
— without core end processing		1x (0.2 ... 1.5 mm ²)
• for AWG conductors for auxiliary contacts		1x (24 ... 14)
Connectable conductor cross-section for auxiliary contacts		
• single or multi-stranded	mm ²	0.2 ... 2.5
• finely stranded		
— with core end processing	mm ²	0.25 ... 1.5
— without core end processing	mm ²	0.2 ... 1.5
AWG number as coded connectable conductor cross section for auxiliary contacts		14 ... 24

Certificates/ approvals:

Certificate of suitability		CE
-----------------------------------	--	----



Safety related data:

Category acc. to EN 954-1	none
Protection against electrical shock	finger-safe

Further information

Information- and Downloadcenter (Catalogs, Brochures,...)

<http://www.siemens.com/industrial-controls/catalogs>

Industry Mall (Online ordering system)

<http://www.siemens.com/industrymall>

Cax online generator

<http://support.automation.siemens.com/WW/CAXorder/default.aspx?lang=en&mfb=7PV15081AW30>

Service&Support (Manuals, Certificates, Characteristics, FAQs,...)

<https://support.industry.siemens.com/cs/ww/en/ps/7PV15081AW30>

Image database (product images, 2D dimension drawings, 3D models, device circuit diagrams, EPLAN macros, ...)

http://www.automation.siemens.com/bilddb/cax_de.aspx?mfb=7PV15081AW30&lang=en

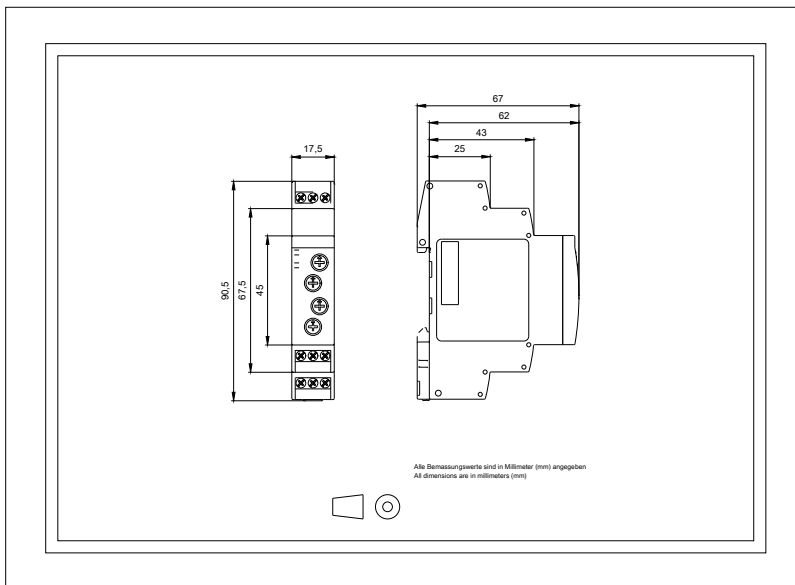

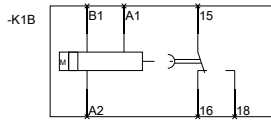
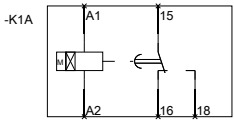

ZEITRELAIS, MULTIFUNKTION,
1 WECHSELSTÜCK,
7 FUNKTIONEN

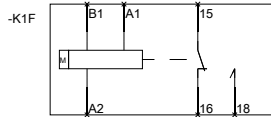
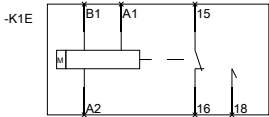
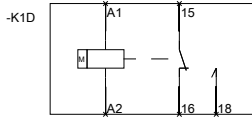
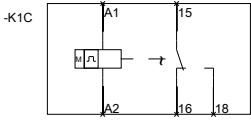

TIME RELAY, MULTIFUNCTIONAL,
1 CHANGE-OVER CONTACT,
7 FUNCTIONS

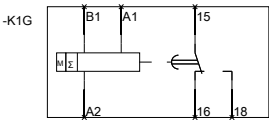

last modified:

16.03.2015