

**PLEASE CHECK WWW.MOLEX.COM FOR LATEST PART INFORMATION**

**Part Number:** **0988221020**  
**Status:** **Active**  
**Overview:** NSCC - New Standard Casing Contact  
**Description:** NSCC 3.33mm Pitch Male Pin Connector, Non-Sealed, 2 Circuits, White

**Documents:**

<a href="#">3D Model</a>	<a href="#">Application Specification 988210001-PS-CH-001 (PDF)</a>
<a href="#">Drawing (PDF)</a>	<a href="#">Packaging Specification PK-31301-635-001 (PDF)</a>
<a href="#">Product Specification PS-98821-001-001 (PDF)</a>	<a href="#">RoHS Certificate of Compliance (PDF)</a>
<a href="#">Application Specification 988210001-AS-CH-001 (PDF)</a>	

**Application tooling part link**

Application Tooling Part Link 63813-3800

**General**

Product Family	Crimp Housings
Series	<a href="#">98822</a>
Application	Wire-to-Wire
Overview	<a href="#">NSCC - New Standard Casing Contact</a>
Product Name	NSCC
Taxonomy	Connector Housings
UPC	822348816910

**Physical**

Circuits (maximum)	2
Circuits Detail	2
Color - Resin	White
Gender	Plug
Glow-Wire Capable	No
Lock to Mating Part	Yes
Material - Resin	PBT
Net Weight	4.493/g
Number of Rows	1
Packaging Type	Carton
Panel Mount	No
Pitch - Mating Interface	3.33mm
Polarized to Mating Part	Yes
Stackable	No
Temperature Range - Operating	-40° to +85°C

**Electrical**

Current - Maximum per Contact 10.0A

**Solder Process Data**

Lead-free Process Capability N/A

**Material Info**

Engineering Number 07519EV2F9

**Reference - Drawing Numbers**

Application Specification	988210001-AS-CH-001, 988210001-PS-CH-001
Packaging Specification	PK-31301-635-001
Product Specification	PS-98821-001-001
Sales Drawing	SD-98822-004-001

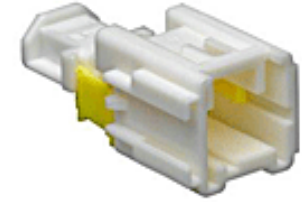

Series image - Reference only

**EU ELV**

**Compliant**

**EU RoHS**

**Compliant**

**REACH SVHC**

Not Contained per -  
D(2022)9120-DC (17  
Jan 2023)

**Halogen-Free**

**Status**

**Low-Halogen**

For more information, please visit [Contact US](#)

China ROHS

ELV

RoHS Phthalates

**China RoHS**

Green Image

Compliant

Not Contained

**Search Parts in this Series**

[98822](#) Series

**Mates With**

[98817](#) NSCC 3.33mm Pitch Female Housing

**Use With**

1.50mm Size FCI SICMA Male Terminal

**Application Tooling | [FAQ](#)**

*Tooling specifications and manuals are found by selecting the products below. Crimp Height Specifications are then contained in the Application Tooling Specification document.*

**Global**

**Description**

**Product #**

Extractor Tool for [638133800](#)

Unsealed Receptacle Connectors

This document was generated on 03/09/2023

**PLEASE CHECK [WWW.MOLEX.COM](http://WWW.MOLEX.COM) FOR LATEST PART INFORMATION**