

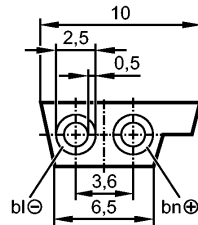

Flat cable 100 meter EPDM ye

Bus system AS-Interface



Product characteristics

AS-i flat cable

Reverse polarity protection due to special shape
for use of insulation displacement technology

Electrical data

Electrical design

AS-i

Operating voltage [V]

26.5...31.6 DC (AS-i)

Environment

Ambient temperature [°C]

-40...85

Protection

IP 67

Mechanical data

Weight [kg]

7.193

Electrical connection

Connection

/ 100 m; 2 x 1.5 mm²

Material

EPDM; halogen-free

Sheath colour

yellow

Remarks

Remarks

100 m Form supplied: coiled

Pack quantity [piece]

1