

Isolier Distanz-Rollen Kunststoff

Entretoises isolantes

Insulating spacers

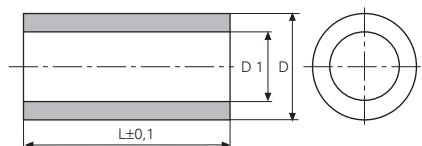

Werkstoff:
 PS=Polystyrol, schwarz
 PA=Polyamid, schwarz
 PC=Polycarbonat, grau

Matière:
 PS=polystyrène, noire
 PA=polyamide, noire
 PC=polycarbonate, gris

Material:
 PS=polystyrene, black
 PA=polyamid, black
 PC=polycarbonate, grey

Temperaturbeständigkeit:
 PS -10°C bis +80°C
 PA -40°C bis +110°C
 PC -50°C bis +135°C

Résistant à une température de:
 PS -10°C à +80°C
 PA -40°C à +110°C
 PC -50°C à +135°C

Temperature range:
 PS -10°C up to +80°C
 PA -40°C up to +110°C
 PC -50°C up to +135°C

für Bolzen pour borne for stud mm	øD mm	øD1 mm	L mm	Artikelnummer Numéro d'article Part-No.	für Bolzen pour borne for stud mm	øD mm	øD1 mm	L mm	Artikelnummer Numéro d'article Part-No.
M2.5	5	2.7	2	x05002027.pa	7	3.6	14	x07014036.ps	
	5	2.7	3	x05003027.pa		3.6	15	x07015036.pc	
	5	2.7	5	x05005027.pa		3.6	15	x07015036.ps	
	5	2.7	7.5	x05007527.pa		3.6	16	x07016036.ps	
	5	2.7	10	x05010027.pa		3.6	17	x07017036.ps	
	5	2.7	13.5	x05013527.pa		3.6	18	x07018036.pc	
	5	2.7	15	x05015027.pa		3.6	18	x07018036.ps	
	5	2.7	20	x05020027.pa		3.6	18.5	x07018536.pc	
M3	5	3.2	10	x05010032.ps		3.6	19	x07019036.ps	
	6	3.2	3	x06003032.pa		3.6	20	x07020036.pc	
	6	3.2	4.5	x06004532.pa		3.6	20	x07020036.ps	
	6	3.2	5	x06005032.pa		3.6	25	x07025036.pc	
	6	3.2	5.6	x06005632.pa		3.6	25	x07025036.ps	
	6	3.2	6.4	x06006432.pa		3.6	27	x07027036.ps	
	6	3.2	7	x06007032.pa		3.6	28.8	x07028836.pc	
	6	3.2	7.4	x06007432.pa		3.6	30	x07030036.pc	
	6	3.2	8	x06008032.pa		3.6	30	x07030036.ps	
	6	3.2	9	x06009232.pa		3.6	35	x07035036.pc	
	6	3.2	10	x06010032.pa	3.6	35	x07035036.ps		
	6	3.2	15	x06015032.pa	M4	4.1	10	x07010041.pc	
	6	3.2	20	x06020032.pa		4.5	3	x08003045.pc	
	6	3.2	30	x06030032.pa		4.5	3	x08003045.ps	
	7	3.6	2	x07002036.pc		4.5	4	x08004045.ps	
	7	3.6	3	x07003036.pc		4.5	5	x08005045.pa	
	7	3.6	3	x07003036.ps		4.5	5	x08005045.pc	
	7	3.6	4	x07004036.ps		4.5	5	x08005045.ps	
	7	3.6	5	x07005036.pc		4.5	6	x08006045.ps	
	7	3.6	5	x07005036.ps		4.5	7	x08007045.ps	
	7	3.6	6	x07006036.pc		4.5	8	x08008045.pc	
	7	3.6	6	x07006036.ps		4.5	8	x08008045.ps	
	7	3.6	6.5	x07006536.ps		4.5	9	x08009045.ps	
	7	3.6	7	x07007036.pc		4.5	10	x08010045.pa	
	7	3.6	7	x07007036.ps		4.5	10	x08010045.pc	
	7	3.6	8	x07008036.pc		4.5	10	x08010045.ps	
	7	3.6	8	x07008036.ps	4.5	11	x08011045.ps		
	7	3.6	9	x07009036.ps	4.5	12	x08012045.ps		
	7	3.6	10	x07010036.pc	4.5	13	x08013045.ps		
	7	3.6	10	x07010036.ps	4.5	14	x08014045.ps		
	7	3.6	11	x07011036.ps	4.2	15	x08015042paw		
	7	3.6	12	x07012036.ps	4.5	15	x08015045.pa		
7	3.6	13	x07013036.ps	4.5	15	x08015045.pc			

Andere Abmessungen auf Anfrage

Autres dimensions sur demande

Further dimensions on request

für Bolzen pour borne for stud mm	øD mm	øD1 mm	L mm	Artikelnummer Numéro d'article Part-No.	für Bolzen pour borne for stud mm	øD mm	øD1 mm	L mm	Artikelnummer Numéro d'article Part-No.
	8	4.5	15	x08015045.ps		10	5.5	10	x10010055.ps
	8	4.2	20	x08020042paw		10	5.5	15	x10015055.pc
	8	4.5	20	x08020045.pa		10	5.5	15	x10015055.ps
	8	4.5	20	x08020045.pc		10	5.5	20	x10020055.pc
	8	4.5	20	x08020045.ps		10	5.5	20	x10020055.ps
	8	4.5	25	x08025045.pc		10	5.5	25	x10025055.pc
	8	4.5	25	x08025045.ps		10	5.5	25	x10025055.ps
	8	4.5	30	x08030045.pa		10	5.5	30	x10030055.pc
	8	4.5	30	x08030045.pc		10	5.5	30	x10030055.ps
	8	4.5	30	x08030045.ps		10	5.5	35	x10035055.pc
	8	4.5	35	x08035045.pc		10	5.5	35	x10035055.ps
	8	4.5	35	x08035045.ps					
M5	10	5.5	2.5	x100025550pc	M6	10	6.2	5	x10005062.pa
	10	5.5	3	x10003055.pc		10	6.2	5	x10005062.ps
	10	5.5	3	x10003055.ps		10	6.2	10	x10010062.pa
	10	5.2	5	x10005052.pa		10	6.2	10	x10010062.ps
	10	5.2	5	x10005052paw		10	6.2	15	x10015062.ps
	10	5.2	10	x10010052.pa		10	6.2	20	x10020062.pa
	10	5.2	20	x10020052.pa		10	6.2	20	x10020062.ps
	10	5.2	30	x10030052.pa		10	6.2	25	x10025062.ps
	10	5.5	5	x10005055.pc		10	6.2	30	x10030062.pa
	10	5.5	5	x10005055.ps		10	6.2	30	x10030062.ps
	10	5.5	10	x10010055.pc		10	6.2	35	x10035062.ps

Andere Abmessungen auf Anfrage

Autres dimensions sur demande

Further dimensions on request