

Insulated twin cord ferrules designed to form a neat end termination to multi-strand cables and wires.

- A tinned copper hollow tube is attached to a colour coded insulating shroud

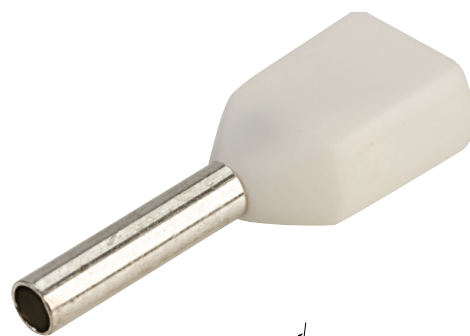

Specification: DIN 46228-4
 Terminal material: High conductivity copper
 Copper purity: >99.9%
 Coating: Tin
 Insulation material: Polyamide 66
 Temperature range: -40°C to +105°C

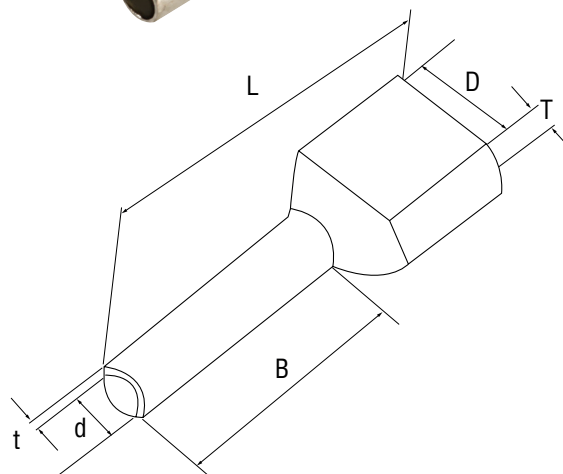

Order code	Size (mm ²)	Dimensions (mm)						Colour
		d	D	L	B	t	T	French standard
33-1312	2x 0.5	1.5	2.5/4.7	15.00	8.00	0.15	0.25	White
33-1314	2x 0.75	1.8	2.8/5.0	15.00	8.00	0.15	0.25	Grey
33-1316	2x 1.0	2.05	3.4/5.4	15.00	8.00	0.15	0.30	Red
33-1318	2x 1.5	2.3	3.6/6.6	16.00	8.00	0.15	0.30	Black
33-1320	2x 2.5	2.8	4.2/7.8	18.50	10.00	0.20	0.30	Blue
33-1322	2x 4	3.7	4.9/8.8	23.00	12.00	0.20	0.40	Grey
33-1324	2x 6	4.8	6.9/10.0	26.00	14.00	0.20	0.40	Yellow