



MASTERCcolour CDM-Tm Mini PGJ5

MMC LAMPKIT CDM-TM 20W/830

Mini, single-ended, high-efficiency Ceramic Metal Halide discharge lamp producing crisp white sparkling light

Product data

• General Information

| | |
|----------------------------|-----------------------------------|
| Cap-Base | PGJ5 [PGJ5] |
| Operating Position | UNIVERSAL [Any or Universal (U)] |
| Life To 5% Failures (Nom) | 9000 h |
| Life To 10% Failures (Nom) | 10000 h |
| Life To 20% Failures (Nom) | 11000 h |
| Life To 50% Failures (Nom) | 12000 h |

• Light Technical

| | |
|------------------------------------|---------------------|
| Color Code | 830 [CCT of 3000K] |
| Luminous Flux (Nom) | 1650 lm |
| Color Designation | Warm White (WW) |
| Lumen Maintenance 1000 h (Nom) | 80 % |
| Lumen Maintenance 10000 h (Nom) | 60 % |
| Lumen Maintenance 2000 h (Nom) | 75 % |
| Lumen Maintenance 5000 h (Nom) | 65 % |
| Chromaticity Coordinate X (Nom) | 0.433 |
| Chromaticity Coordinate Y (Nom) | 0.392 |
| Correlated Color Temperature (Nom) | 2975 K |
| Luminous Efficacy (rated) (Nom) | 75 lm/W |
| Color Rendering Index (Min) | 84 |

| | |
|-----------------------------|----|
| Color Rendering Index (Nom) | 87 |
|-----------------------------|----|

• Operating and Electrical

| | |
|------------------------------|--------|
| Power (Rated) (Nom) | 20.0 W |
| Lamp Current Run-Up (Max) | .5 A |
| Re-Ignition Time (Min) (Max) | 15 min |
| Ignition Time (Max) | 30 s |
| Voltage (Max) | 108 V |
| Voltage (Min) | 95 V |
| Voltage (Nom) | 100 V |

• Controls and Dimming

| | |
|-----------------------|-------|
| Dimmable | No |
| Run-Up Time 90% (Max) | 3 min |

• Mechanical and Housing

| | |
|-------------|------------|
| Bulb Finish | Clear (CL) |
|-------------|------------|

• Approval and Application

| | |
|-------------------------------|--------|
| Energy Efficiency Label (EEL) | A |
| Mercury (Hg) Content (Nom) | 2.4 mg |
| Energy Consumption kWh/1000 h | 24 kWh |

PHILIPS

MASTERColour CDM-Tm Mini PGJ5

• UV

| | |
|--------------------------|-----------|
| Pet (Niosh) (Min) | 8 h/500lx |
| Damage Factor D/fc (Max) | 0.5 |

• Luminaire Design Requirements

| | |
|----------------------------|--------|
| Bulb Temperature (Max) | 380 °C |
| Cap-Base Temperature (Max) | 250 °C |

• Product Data

| | |
|---------------------------------|-------------------------------|
| Full product code | 871150020766115 |
| Order product name | MMC LAMPKIT CDM-TM 20W/830 |
| EAN/UPC - Product | 8711500207661 |
| Order code | 914499996230 |
| Numerator - Quantity Per Pack | 1 |
| Numerator - Packs per outer box | 12 |
| Material Nr. (12NC) | 914499996230 |
| Net Weight (Piece) | 5.000 g |
| ILCOS Code | MT/UB-20/830-H/L-PGJ5-13.3/52 |

Warnings and Safety

- Use only in totally enclosed luminaire, even during testing (IEC61167, IEC 62035, IEC60598)
- The luminaire must be able to contain hot lamp parts if the lamp ruptures
- Use only with electronic control gear
- Control gear must include end-of-life protection (IEC61167, IEC 62035)

- For 20W PGJ5 lamp, use only Philips electronic control gear HID PV mini PGJ5 20W
- For 35W PGJ5 lamp, use only Philips electronic control gear HID PV mini PGJ5 35W
- A lamp breaking is extremely unlikely to have any impact on your health. If a lamp breaks, ventilate the room for 30 minutes and remove the parts, preferably with gloves. Put them in a sealed plastic bag and take it to your local waste facilities for recycling. Do not use a vacuum cleaner.

Dimensional drawing

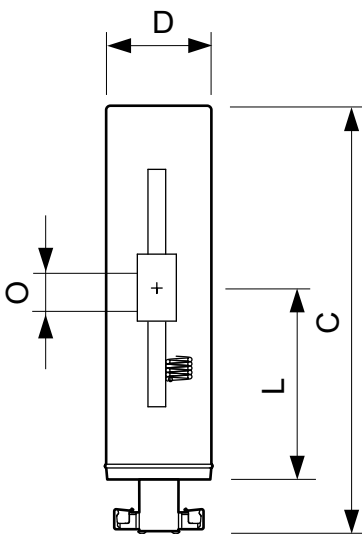

MASTERColour CDM-Tm PGJ5 T13.3

CDM-Tm 20W/830 PGJ5 Lamp Kit

| Product | D | D | O | L | L | L | C |
|----------------------------|---------|---------|------|---------|---------|---------|-------|
| MMC LAMPKIT CDM-TM 20W/830 | 13.3 mm | 0.44 in | 3 mm | 22.3 mm | 22.9 mm | 22.6 mm | 52 mm |

Dimensional drawing

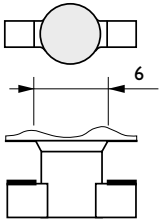

Photometric data

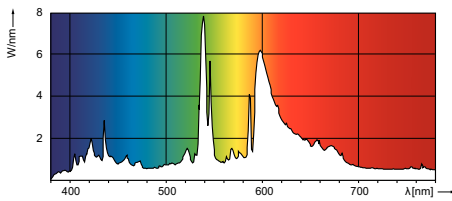

© 2016 Philips Lighting Holding B.V.
All rights reserved.

Specifications are subject to change without notice. Trademarks are the property of Koninklijke Philips N.V. (Royal Philips) or their respective owners.

www.philips.com/lighting

2016, February 11
data subject to change