

KINGNUT® stecken statt schrauben

bis zu 50% Kosteneinsparung
leicht in der Handhabung

Material: PA 6.6
Farbe: schwarz
Temperatur: -10 °C bis +75 °C

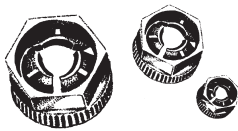
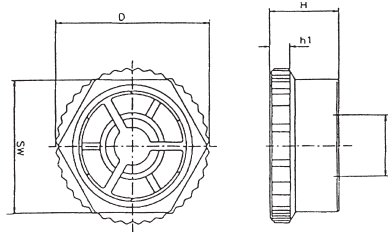
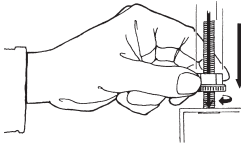

Artikel-Nr.	Gewinde/d1	Maße SW	D	H	h1	MOQ Stück
KN 30	M3	7	8,2	4,0	1,5	100
KN 40	M4	8	9,4	4,7	1,5	100
KN 50	M5	10	11,7	5,8	2,0	100
KN 60	M6	13	15,2	7,0	2,5	100

Kunststoffmuttern

Material: PA 6.6 (SK-02)
Temperatur: -30 °C bis +120 °C
Festigkeit: bis 600 kg/cm²

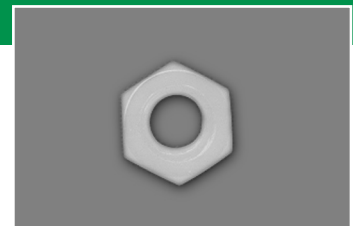

Mutter DIN 934, ISO 4032

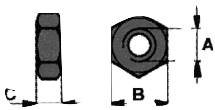

Hutmutter DIN 1587

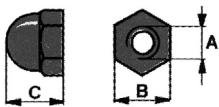

Flügelmutter

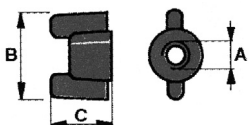

Artikel-Nr.	Farbe	Maße A	B	C	MOQ Stück
051 0200 000 02	natur	M2	4,0	1,3	100
051 0250 000 02	natur	M2,5	5,0	2,0	100
051 0300 000 02	natur	M3	5,5	2,4	100
051 0400 000 02	natur	M4	7,0	3,2	100
051 0500 000 02	natur	M5	8,0	4,0	100
051 0600 000 02	natur	M6	10,0	5,0	100
051 0800 000 02	natur	M8	13,0	6,5	100
051 1000 000 02	natur	M10	17,0	8,0	100
051 1200 000 02	natur	M12	18,0	10,0	100
051 1600 000 02	natur	M16	24,0	13,0	100
052 0300 000 02	natur	M3	5,5	6,5	250
052 0400 000 02	natur	M4	7,0	8,0	250
052 0500 000 02	natur	M5	8,0	10,0	250
052 0600 000 02	natur	M6	10,0	12,0	100
052 0800 000 02	natur	M8	13,0	15,0	100
052 1000 000 02	natur	M10	17,0	18,0	100
052 1200 000 02	natur	M12	19,0	16,0	50
052 1600 000 02	natur	M16	24,0	21,0	50
053 0400 600 02	weiß	M4	25,0	14,0	100
053 0500 600 02	weiß	M5	25,0	14,0	100
053 0600 600 02	weiß	M6	25,0	14,0	100
053 0800 000 02	natur	M8	26,0	16,0	100