



Model Number

UB-PROG4-V15

Programming unit for ultrasonic sensors with Teach-in input at pin 2

Dimensions

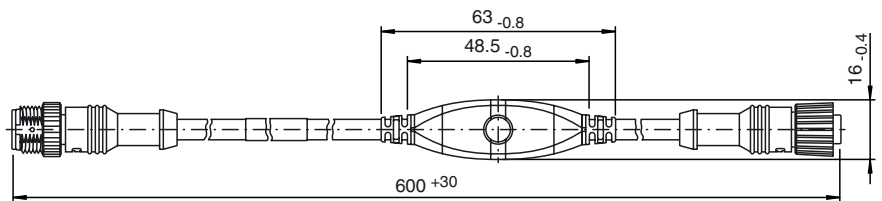

Technical data

Mechanical specifications

Connection type	M12 x 1 , 5-pin
Material	
Housing	PVC
Cable	PVC
Mass	50 g

Note

For the teach-in process, the programming unit is connected between the cable connection box and the plug connection on the sensor. The button starts the Teach-in process. Pressing the button connects plug pins 2 and 3 to each other.

For a detailed description of the Teach-in process, refer to the sensor data sheet. The taught values are stored in the non-volatile memory. They are retained in the sensor after removing the programming unit and/or turning off the operating voltage.