



STAND-ALONE INSTALLATION SUPPORT FOR
3RU21/3RB30/3RB31/3RR2 SZ S00, STAND-ALONE
INSTALLATION MAIN CIRCUIT: SCREW TERMINAL
AUX. CIRCUIT: --

General technical data:

product brand name		SIRIUS
Product designation		individual mount
Size of overload relay		S00
Ambient temperature		
• during storage	°C	-50 ... +80
• during operation	°C	-20 ... +70

Installation/ mounting/ dimensions:

Mounting type		screw and snap-on mounting onto 35 mm standard mounting rail
Width	mm	45
Height	mm	86
Depth	mm	75

Connections/ Terminals:

Type of electrical connection		screw-type terminals
• for main current circuit		
Type of connectable conductor cross-section		
• for main contacts		
— solid		0.5 ... 4 mm ²
— finely stranded		
— with core end processing		0.5 ... 2.5 mm ²
• for AWG conductors		
— for main contacts		1x (20 ... 12)

Certificates/ approvals:

General Product Approval	Test Certificates	Shipping Approval
--------------------------	-------------------	-------------------



[Type Test Certificates/Test Report](#)



Shipping Approval	other
-------------------	-------



[Environmental Confirmations](#)

Further information

Information- and Downloadcenter (Catalogs, Brochures,...)
<http://www.siemens.com/industrial-controls/catalogs>

Industry Mall (Online ordering system)
<http://www.siemens.com/industrymall>

Cax online generator
<http://support.automation.siemens.com/WW/CAXorder/default.aspx?lang=en&mlfb=3RU29163AA01>

Service&Support (Manuals, Certificates, Characteristics, FAQs,...)
<http://support.automation.siemens.com/WW/view/en/3RU29163AA01/all>

Image database (product images, 2D dimension drawings, 3D models, device circuit diagrams, EPLAN macros, ...)
<http://www.automation.siemens.com/bilddb/index.aspx?attID9=3RU29163AA01&lang=en>

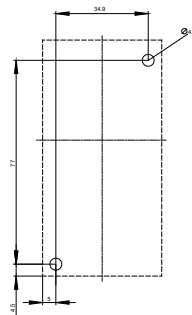
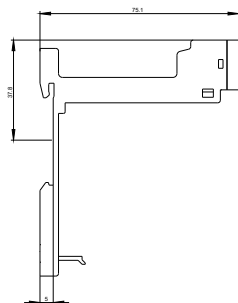
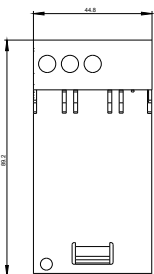

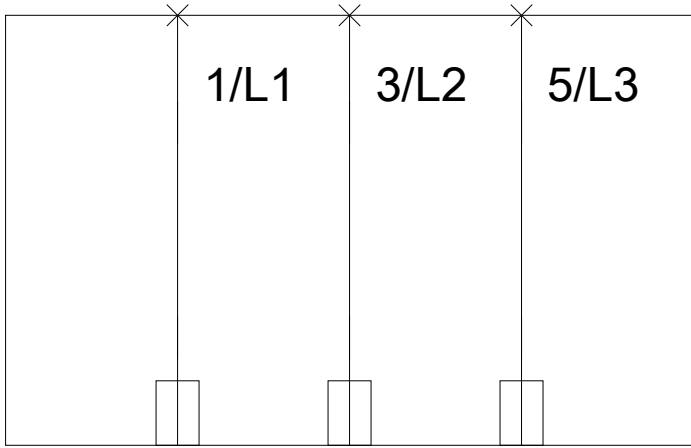

last modified:

09.03.2015