

Apparatus castors with back hole, rubber bandage TPE, light version, electrically conductive

Swivel castors

Material: Fork: sheet steel, zinc-plated.
Tread: Thermoplastic rubber, grey, electrical conductive and antistatic ($10^4 \Omega$).
Wheel body: Plastic, screwed.
Wheel bearing: Ball bearing.
Swivel bearing: Double ball ring.

For indoor use. Low-noise operation with low rolling and swivelling resistance. Trackless. The tread is slightly oily and can cause contact discolouration on sensitive surfaces.

Temperature range: -20°C to $+60^\circ\text{C}$.

Ordering Details: e.g.: Product No. 777 130 50EL,
Swivel castor, TPE light, electrically conductive, D 50 mm

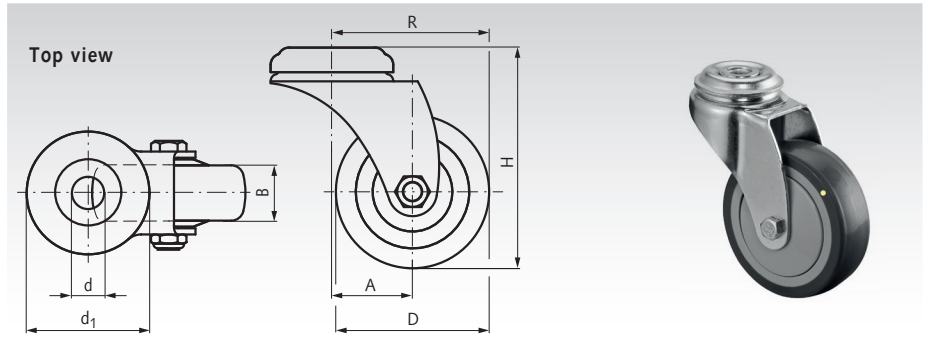

Product No.	D mm	B mm	H mm	A mm	R mm	d mm	d ₁ mm	Load capacity kg	Weight kg
777 130 50EL	50	18	73	26	51	10,2	38,1	50	0,16
777 130 75EL	75	24	103	38	75,5	10,2	43,2	60	0,26

Swivel castors with brakes

Material: Fork: sheet steel, zinc-plated.
Tread: Thermoplastic rubber, grey, electrical conductive and antistatic ($10^4 \Omega$).
Wheel body: Plastic, screwed.
Wheel bearing: Ball bearing.
Swivel bearing: Double ball ring.

For indoor use. Low-noise operation with low rolling and swivelling resistance. Trackless. The tread is slightly oily and can cause contact discolouration on sensitive surfaces.

Temperature range: -20°C to $+60^\circ\text{C}$.

Ordering Details: e.g.: Product No. 777 140 50EL,
Swivel castor with brake, TPE light, electrically conductive, D 50 mm

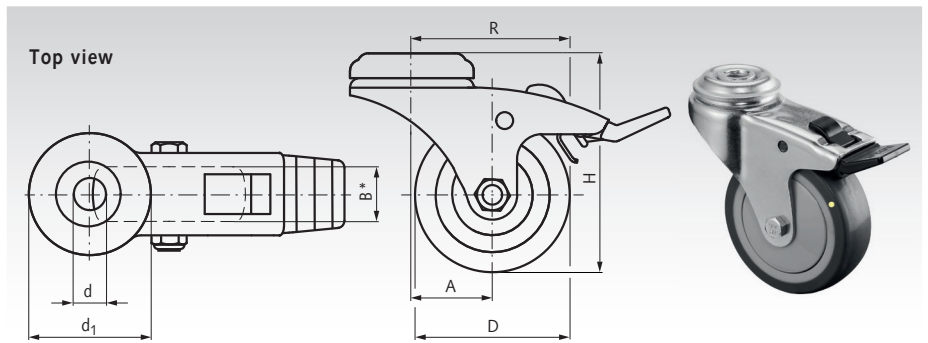

Product No.	D mm	B mm	H mm	A mm	R mm	d mm	d ₁ mm	Load capacity kg	Weight kg
777 140 50EL	50	18	73	26	51	10,2	38,1	50	0,18
777 140 75EL	75	24	103	38	75,5	10,2	43,2	60	0,32

* Wheel width

Note to electrical Antistatic and Conductivity

Wheels and castors are considered electrically antistatic, if the ohmic resistance is $10^7 \Omega$ or less.

Wheels and castors are considered electrically conductive, if the ohmic resistance is $10^4 \Omega$ or less, even less than parts named antistatic. So, the parts which are named electrically conductive are also antistatic.