

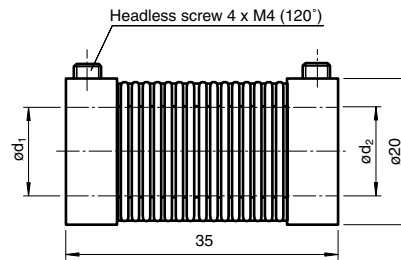

Dimensions



Model Number

9409 6*6

Bellows coupling

Features

- Bellows coupling

Technical data

Mechanical specifications

Shaft diameter	d1 = 6 mm , d2 = 6 mm
Material	CuZn20, nickel-plated
Mass	approx. 34 g
Rotational speed	max. 8000 min ⁻¹
Rated torque	0.8 Nm
Tightening torque, fixing screws	1.5 Nm
Radial offset	max. ± 0.3 mm
Axial offset	max. ± 0.5 mm
Angle error	max. ± 4 °
Moment of inertia	22 kg m ² x 10 ⁻⁷
Mounting	clamp screws