

COMPRESSED AIR TANKS

Tanks in painted steel for compressed air are supplied with Certificate of Conformity according to european directives **2014/29/UE** (Simple Pressure Vessels) or according to the directive about pressure equipment **2014/68/UE (PED)** on the base of the features of the tank.

Keep the use and maintenance manual supplied together with each tank.



Little tanks - without brackets - according to European Directives 2014/29/UE

*TAKE NOTE: tanks of 1 and 2,5 liters will be supplied only with internal test**

Technical features

Capacity	1 - 12 lt
Thread	UNI - ISO 228/1
Fluid	compressoed air
Max working pressure	11 BAR
Number of connections	2 or 4
Test and certificate	internal test - 201/29/UE
Material	carbon steel
External treatements	light blue painted

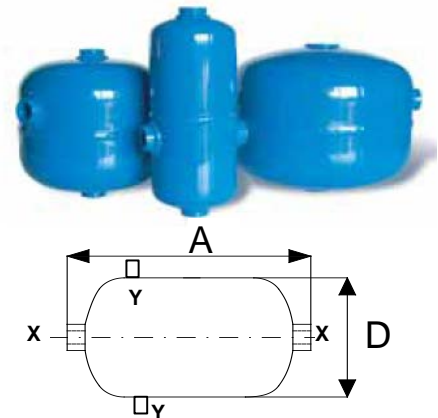

(*) as agreed with PED directives that fix the rule to have certification only for tanks with $PxV > 50$ bar/liter.

CAPACITY MAX PRESSURE 11 BAR	CONNECTIONS	A (mm)	D (mm)	THREAD X	THREAD Y	WEIGH (Kg)
1 litre	2	227	86	1/2"	-	1
	4			1/2"	1/2"	
2,5 litres	2	175	160	1/2"	-	1,4
	4			1/2"	1/2"	
4,8 litres	2	195	210	1/2"	-	1,9
	4			1/2"	1/2"	
7 litres	2	258	210	1/2"	-	2,4
	4			1/2"	1/2"	
12 litres	2	365	229	1/2"	-	4,2
	4			1/2"	1/2"	

TAKE NOTE: dimensions are indicative

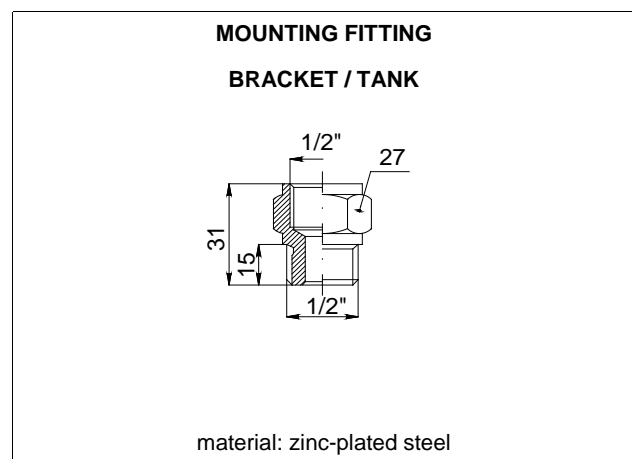
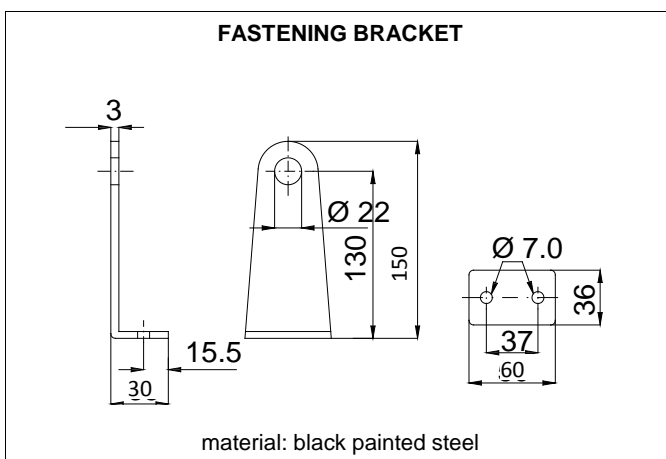

Example

TANK WITHOUT BRACKETS 12 LITERS 2 CONNECTIONS = tank without brackets according to European Directive 2014/29/UE light blue painted, with 12 liters as max capacity and 11 bar as max working pressure, 2 connections.

COMPRESSED AIR TANKS

HORIZONTAL TANKS

Technical features

Capacity	10 - 3.000 lt
Thread	UNI - ISO 228/1
Fluid	compressed air / nitrogen
Max. Pressure	see table below
Test / certificate	2014/29/UE - 2014/68/UE (PED)
Material	carbon steel
External treat.	Light blue RAL 5015, crude

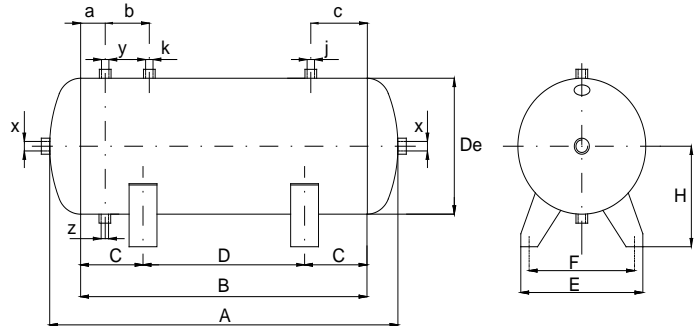

On demand hot galvanised

STANDARD HORIZONTAL TANKS (11/12 bar) with or without bracket

	CAPAC. (litri)	PRESS. (bar)	DE (mm)	A (mm)	B (mm)	C (mm)	D (mm)	E (mm)	F (mm)	H (mm)	a (mm)	b (mm)	c (mm)	x (in)	y (in)	z (in)	k (in)	j (in)
2014/29/UE	10	11	169	506	410	85	240	205	172	115	-	-	60	1"	-	3/8"	-	3/8"
	15	11	196	522	410	85	240	205	172	135	-	-	60	1"	-	3/8"	-	3/8"
	24	11	240	592	450	95	260	235	180	165	-	-	60	1"	-	3/8"	-	3/8"
	50	11	305	784	580	100	400	285	236	203	-	-	60	1"	1/2"	3/8"	-	1/2"
	100	11	370	1016	800	125	550	352	306	258	45	80	45	2"	3/8"	3/8"	1/2"	3/8"
	200	11	446	1364	1100	175	750	440	385	288	50	150	50	2"	3/8"	3/8"	1/2"	1/2"
	270	11	500	1458	1150	175	800	455	402	315	50	130	50	2"	3/8"	3/8"	1"	1/2"
	500	11	600	1858	1500	148	1204	530	470	396	60	155	60	2"	3/8"	3/8"	1"	1/2"
	720	11	750	1850	1400	200	1000	580	470	490	60	155	60	2"	3/8"	3/8"	1"	1/2"
2014/68/UE (900	11	800	1960	1500	243	1014	605	490	500	60	155	60	2"	3/4"	1/2"	1"	1/2"
	1000	12	800	2158	1700	343	1014	605	490	500	100	155	60	2"	3/4"	1/2"	1"	1/2"
	2000	12	1100	2252	1650	200	950	800	685	652	200	215	-	2"	1/2"	1/2"	1/2"	-
2014/68/UE (PED)	3000	12	1200	2850	2020	227	1265	820	710	698	230	200	-	2"	1/2"	1/2"	1/2"	-

SPECIAL HORIZONTAL TANKS - PRESSURE 15-16 BAR ONLY WITH BRACKET

	CAPAC. (litri)	PRESS. (bar)	DE (mm)	A (mm)	B (mm)	C (mm)	D (mm)	E (mm)	F (mm)	H (mm)	a (mm)	b (mm)	c (mm)	x (in)	y (in)	z (in)	k (in)	j (in)
2014/29/UE	24	16	240	592	450	95	260	235	180	165	50	-	60	1/2"	-	3/8"	-	3/8"
	50	15	305	784	600	100	400	301	249	203	60	60	60	1/2"	1/2"	3/8"	-	1/2"
	100	16	370	1016	800	125	550	352	306	258	45	80	45	1/2"	3/8"	3/8"	3/4"	3/8"
	200	15	446	1364	1100	175	750	440	385	288	50	150	50	1/2"	3/8"	3/8"	1/2"	1/2"
2014/68/UE (PED)	270	16	500	1484	1150	175	800	445	402	315	50	130	50	2"	3/8"	3/8"	1"	1/2"
	500	16	600	1858	1500	148	1204	530	470	396	60	155	60	2"	3/8"	3/8"	1"	1/2"
	1000	16	800	2158	1700	343	1014	605	490	500	100	155	60	2"	3/4"	1/2"	1"	1/2"
	2000	16	1000	2570	1950	300	1350	691	575	608	220	300	-	2"	1/2"	1/2"	1/2"	-

Example: CRUDE HORIZONTAL TANK 24 / 11 =

crude horizontal tank, capacity 24 l, max working pressure 11 bar, with certificate

Dimensions are indicative

Technical sheet are available for every item

COMPRESSED AIR TANKS

VERTICAL TANKS

Technical features

Capacity	50 - 3.000 lt
Thread	UNI - ISO 228/1
Fluid	compressed air/ nitrogen
Max pressure	11 bar (standard) or 16 bar (special)
Test/certificate	2014/29/UE - 2014/68/UE (PED)
Material	carbon steel
External treat.	Light blue RAL 5015 painted, crude

On demand available hot galvanised

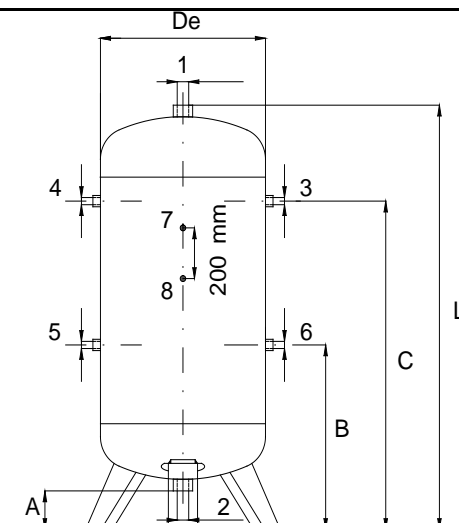

STANDARD VERTICAL TANKS - PRESSURE 11-12 BAR

	CAPAC. (litri)	PRESS. (bar)	DE (mm)	A (mm)	B (mm)	C (mm)	L (mm)	1 (in)	2 (in)	3 (in)	4 (in)	5 (in)	6 (in)	7 (in)	8 (in)
2014/29/UE	50	11	305	145	297	777	929	1/2"	1/2"	-	1/2"	-	1/2"	3/8"	-
	100	11	370	180	355	1055	1213	1/2"	1/2"	-	3/4"	-	3/4"	3/8"	3/8"
	200	11	446	175	400	1225	1557	1/2"	1/2"	-	1"	-	1"	3/8"	3/8"
	270	11	500	175	599	1304	1648	1/2"	1/2"	1"	-	1"	1"	3/8"	-
	500	11	600	155	785	1665	2050	1/2"	1/2"	1"	1"	1"	1"	3/8"	-
	720	11	750	135	880	1705	2030	2"	2"	2"	2"	2"	2"	3/8"	3/8"
2014/68/UE (900	11	800	145	875	1805	2140	2"	2"	1 1/2"	1 1/2"	1 1/2"	1 1/2"	3/8"	3/8"
	1000	12	800	145	770	1720	2350	2"	2"	2"	2"	2"	2"	3/8"	3/8"
	2000	12	1100	200	770	1970	2490	2"	2"	2"	2"	2"	2"	1/2"	1/2"
	3000	12	1200	140	830	2250	2990	2"	2"	2"	2"	2"	2"	1/2"	1/2"

SPECIAL VERTICAL TANKS - PRESSURE 15-16 BAR

	CAPAC. (litri)	PRESS. (bar)	DE (mm)	A (mm)	B (mm)	C (mm)	L (mm)	1 (in)	2 (in)	3 (in)	4 (in)	5 (in)	6 (in)	7 (in)	8 (in)
2014/29/UE	50	15	305	145	297	777	929	1/2"	1/2"	-	1/2"	-	1/2"	3/8"	-
	100	16	370	180	355	1055	1213	1/2"	1/2"	-	3/4"	-	3/4"	3/8"	3/8"
	150	16	396	170	385	1210	1430	1/2"	1/2"	-	1"	-	1"	3/8"	3/8"
	200	16	446	175	400	1225	1557	1/2"	1/2"	-	1"	-	1"	3/8"	3/8"
2014/68/UE (PED)	270	16	500	175	599	1304	1648	1/2"	1/2"	1"	-	1"	1"	3/8"	-
	500	16	600	155	785	1665	2050	2"	2"	2"	2"	2"	2"	3/8"	-
	1000	16	800	145	770	1720	2350	2"	2"	2"	2"	2"	2"	3/8"	3/8"
	2000	16	1100	170	770	2185	2740	2"	2"	2"	2"	2"	2"	1/2"	1/2"
	3000	16	1200	140	830	2250	2990	2"	2"	2"	2"	2"	2"	1/2"	1/2"

Example

PAINTED VERTICAL TANK 50 / 11=

painting light blue vertical tank, capacity 50 l, max working pressure 11 bar, with certificate

Dimensions are indicative

Technical sheet are available for every item

NOTE: it's possible to request tank with max pressure of 21 bar, 32 bar, 42 bar or for vacuum.