



## **PRODUKTINFORMATION**

**Vi reserverar oss mot fel samt förbehåller oss rätten till ändringar utan föregående meddelande**

### **ELFA artikelnr**

**37-480-76 Tungelem TRC200S 15-30 AT**

**37-485-22 Tungelement CRC500H**

**37-485-48 Tungelement CTC500H**

## Reed Switch - Changeover Switches



- Changeover or normally closed application
- Inert gas atmosphere

A family of form 'C' reed switches offers moderate to medium voltage breakdown. Click [here](#) for Application Notes

			Compact Change Over			Tiny Change Over	
			Standard	High Power		TRC200B	TRC200S
Parameters		Type	CRC200H	CRC500H	CTC500H		
Contact form	-	-	C	C	C	C	C
Contact material	-	-	Rh	Rh	T	Rh	Rh
Switching capacity	max.	WVA	25	25	100#	5	5
Switching voltage	max.	V AC/DC	150	250	500	175	175
Switching current	max.	A	1.0	1.0	3.0	0.25	0.25
Carrying current	max.	A	-	-	-	0.5	0.5
Dielectric strength	min.	VDC	250	1000	1000	200	200
Initial contact resistance	max.	mohms	100	100	500	100	100
Insulation resistance	min.	ohms	10 <sup>10</sup>	10 <sup>8</sup>	10 <sup>8</sup>	10 <sup>9</sup>	10 <sup>9</sup>
Operate sensitivity	range	AT	40 ... 80	50 ... 90	60 ... 100	15 ... 30	15 ... 30
Release sensitivity	min.	AT	10	30	32	-	-
Operate time without bounce	max.	ms	3.0	3.0	3.5	0.7	0.7
Bounce time	max.	ms	1.0	1.0	1.5	-	-
Release time	max.	ms	2.0	1.0	1.0	1.0	1.0
Resonant frequency	typ.	Hz	-	-	-	11000	11000
Operating frequency	max.	Hz	-	-	-	-	-
Vibration	35 g	Hz	-	-	-	30g@50-2k Hz	30g@50-2k Hz
Shock	11 ms	g	-	-	-	50	50
Capacitance	typ.	pF	2.0	2.0	-	-	-
Operating temperature	range	°C	-40...+150	0/+125		-40/+125	
<b>Dimensions</b>							
Overall length	A max.	mm	87	87	87	53	53
Glass length	B max.	mm	35	35	35	14.8	14.8
Glass diameter	C max.	mm	5.4	5.4	5.4	2.7	2.7
Wire diameter	D max.	mm	1.0	1.0	1.0	0.51	0.51

Compact Change Over

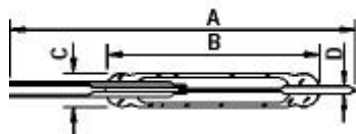

Tiny Change Over

