

SIGNALLING COLUMN REP.-FLASH LIGHT ELEMENT  
LED RED, 24V AC/DC



**General technical data:**

<b>product brand name</b>		SIRIUS
<b>Product component Light source</b>		Yes
<b>Design of the optical signal</b>		blinklight
<b>Type of voltage of the operating voltage</b>		AC/DC
<b>Operating voltage</b>		
• 1 for DC Rated value	V	24
• 1 with AC at 50 Hz Rated value	V	24
• 1 with AC at 60 Hz Rated value	V	24
<b>Equipment marking acc. to DIN EN 61346-2</b>		P

**Mechanical data:**

<b>Outer diameter of the signal column element</b>	mm	70
--	----	----

**Lamp:**

<b>Type of light source</b>		LED
-----------------------------	--	-----

**Ambient conditions:**

<b>Ambient temperature during operation</b>	°C	-20 ... +50
<b>Protection class IP</b>		IP65
<b>Height</b>	mm	65.5
<b>Width</b>	mm	70

**Certificates/ approvals:**

General Product Approval	EMC	Declaration of Conformity	Shipping Approval
--------------------------	-----	---------------------------	-------------------



Further information

Information- and Downloadcenter (Catalogs, Brochures,...)

<http://www.siemens.com/industrial-controls/catalogs>

Industry Mall (Online ordering system)

<http://www.siemens.com/industrymall>

Cax online generator

<http://support.automation.siemens.com/WW/CAXorder/default.aspx?lang=en&mlfb=8WD44205BB>

Service&Support (Manuals, Certificates, Characteristics, FAQs,...)

<https://support.industry.siemens.com/cs/ww/en/ps/8WD44205BB>

Image database (product images, 2D dimension drawings, 3D models, device circuit diagrams, EPLAN macros, ...)

[http://www.automation.siemens.com/bilddb/cax\\_de.aspx?mlfb=8WD44205BB&lang=en](http://www.automation.siemens.com/bilddb/cax_de.aspx?mlfb=8WD44205BB&lang=en)

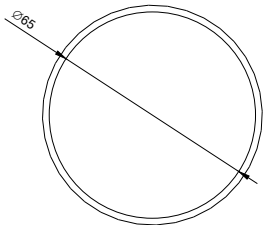
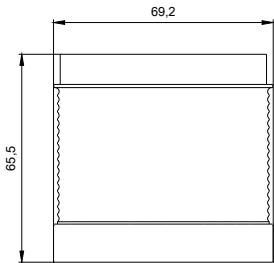

WB: 8WD44... ALL

last modified:

15.01.2015