

D-Sub Accessories / Jackscrews

TECHNICAL SPECIFICATIONS

Material (screw): Zi-plated steel
Ni-plated brass

Material (plastic knob / D-JS): Polyamide UL94 V2

Mounting torque: 50 - 130 Ncm
depending on
part number

Thread options: UNC 4-40
M2.5
M2.6
M3.0



D-JS: Jack screw with plastic screw head
D-JSS: Turned solid metal jack screw
D-JSS-NH: Turned solid metal jack screw
with slot screw head

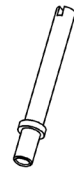

D-JSS-NH



D-JSS



D-JSS

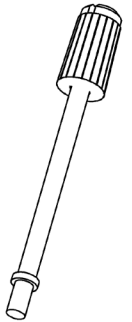

D-JS

PART NUMBERING SYSTEM

D-JS-45 - M3.0 - RED - BULK

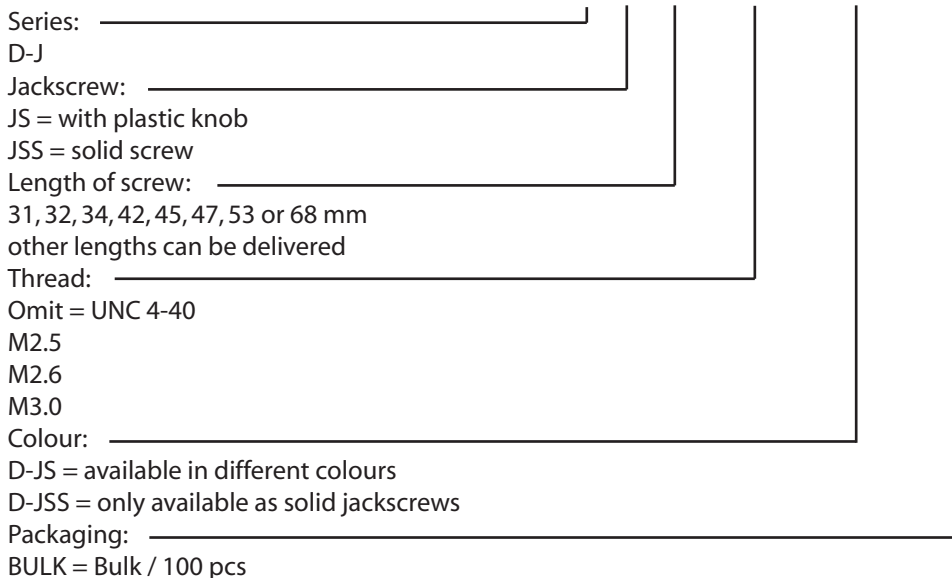

FEATURES

- Designed to be combined with Ossi D-Sub backshells
- D-JS can be delivered in different colours for coding
- D-JS delivered as solid CNC turned Ni-plated brass or Zi-plated steel jackscrews
- UNC 4-40, M2.5, M2.6 and M3.0 as thread options
- For custom designed solutions, please consult factory