



PE PICK OFF, CONNECTION MAIN CIRCUIT: SCREW TERMINAL,

| General technical data: | | |
|---|----|--|
| product brand name | | SIRIUS |
| Product designation | | PE pick-up |
| Protection class IP | | IP20 |
| Degree of pollution | | 3 |
| Installation altitude at height above sea level maximum | m | 2 000 |
| Ambient temperature | | |
| • during transport | °C | -55 ... +80 |
| • during storage | °C | -55 ... +80 |
| • during operation | °C | -20 ... +60 |
| Vibration resistance | | f = 4 to 5.8 Hz; d = 15 mm; f = 5.8 to 500 Hz; a = 2 m / s ² 10 cycles |
| Shock resistance | | Semi-sinusoidal a = 6 m/s ² at 10 ms; 3 pos. and 3 neg. Shock in all axes |
| Equipment marking acc. to DIN EN 61346-2 | | X |
| Equipment marking acc. to DIN 40719 extended according to IEC 204-2 acc. to IEC 750 | | X |









| Main circuit: | | |
|--|---|----|
| Operating current with AC at 400 V Rated value | A | 63 |

| Installation/ mounting/ dimensions: | | |
|-------------------------------------|----|----------------|
| Mounting type | | plug-in fixing |
| Width | mm | 15 |
| Height | mm | 60 |
| Depth | mm | 32 |

Connections/ Terminals:

| | | |
|--|-----------------|---|
| Type of electrical connection for main current circuit | | screw-type terminals |
| Design of screw-type connection for main contacts | | M3 |
| Wire stripping length for main contacts | mm | 10 |
| Tightening torque for main contacts with screw-type terminals | N·m | 2 ... 2.5 |
| Connectable conductor cross-section for main contacts for load-side outgoing feeder | | |
| <ul style="list-style-type: none"> • solid | mm ² | 1.5 ... 10 |
| <ul style="list-style-type: none"> • stranded | mm ² | 1.5 ... 10 |
| <ul style="list-style-type: none"> • finely stranded with core end processing | mm ² | 1.5 ... 6 |
| <ul style="list-style-type: none"> • finely stranded without core end processing | mm ² | 1.5 ... 6 |
| Type of connectable conductor cross-section for main contacts for load-side outgoing feeder | | |
| <ul style="list-style-type: none"> • solid | | 2x (1.5 ... 6 mm ²), 1x (1.5 ... 10 mm ²) |
| <ul style="list-style-type: none"> • stranded | | 2x (1.5 ... 6 mm ²), 1x (1.5 ... 10 mm ²) |
| <ul style="list-style-type: none"> • finely stranded with core end processing | | 2 x (1.5 ... 6) mm ² |
| Type of connectable conductor cross-section for AWG conductors for main contacts for load-side outgoing feeder | | 2 x (16 ... 10), 1 x (16 ... 8) |

Certificates/ approvals:

| General Product Approval | | EMC | Shipping Approval | |
|--|--|---|---|--|
|  CSA |  UL |  |  C-TICK |  BUREAU VERITAS |
| | | | |  DNV |
| Shipping Approval | | | other | |
|  LRS |  PRS |  RINA | Declaration of Conformity | Environmental Confirmations |
| | | | | other |

Safety related data:

| | |
|-------------------------------------|-------------|
| Protection against electrical shock | finger-safe |
|-------------------------------------|-------------|

Further information

Information- and Downloadcenter (Catalogs, Brochures,...)

<http://www.siemens.com/industrial-controls/catalogs>

Industry Mall (Online ordering system)

<http://www.siemens.com/industrymall>

Cax online generator

<http://support.automation.siemens.com/WW/CAXorder/default.aspx?lang=en&mlfb=3RA68704AB>

Service&Support (Manuals, Certificates, Characteristics, FAQs,...)

<http://support.automation.siemens.com/WW/view/en/3RA68704AB/all>

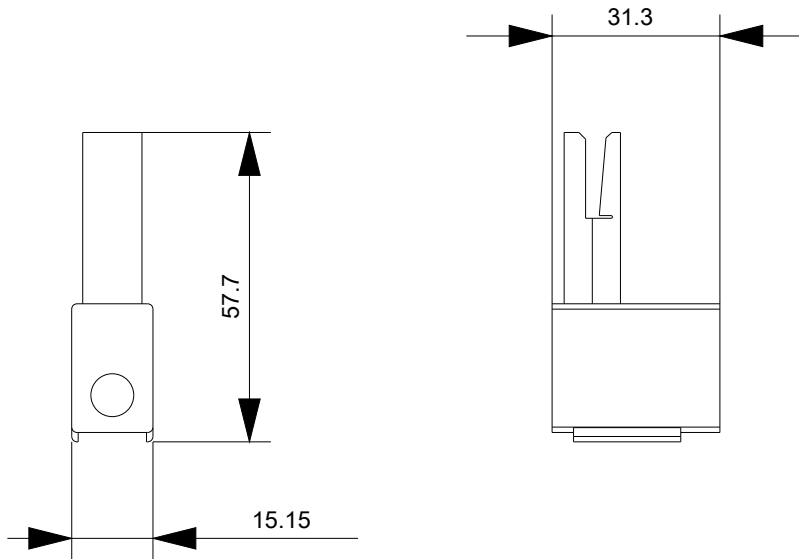

last modified:

09.03.2015