

For dimensions 1, the majority of finished components are 1% tolerance on the average condition (not 0.5% and 0.2% for components of steel, on the order of 1000 units, for manufacturers of steel, for average condition of steel, or for the use of any information in this document).

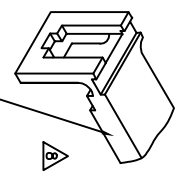
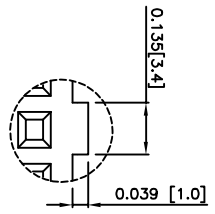
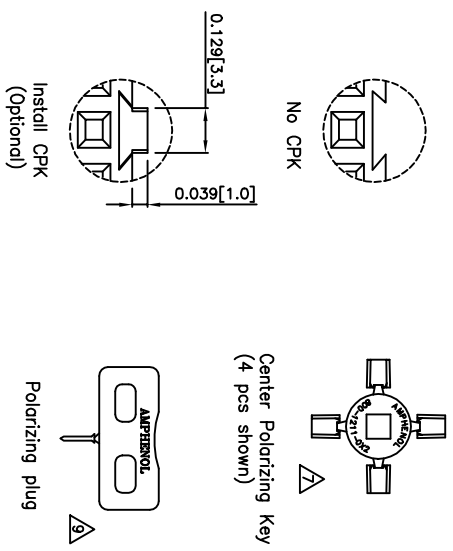
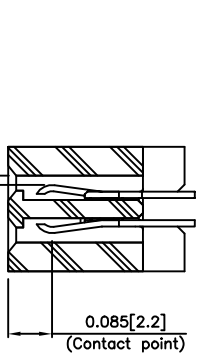
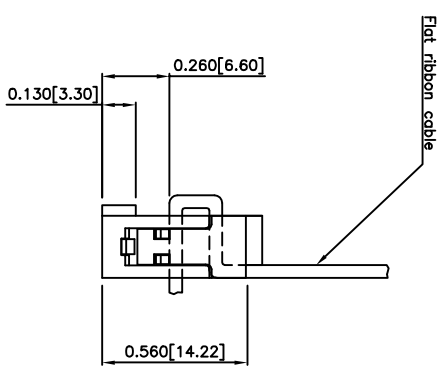
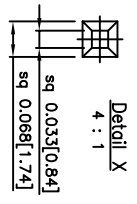
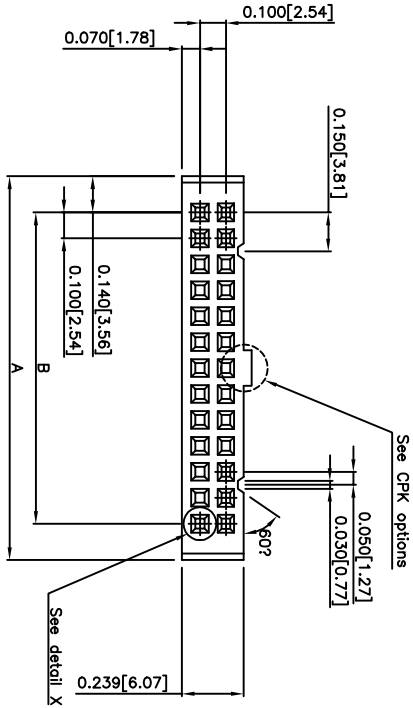
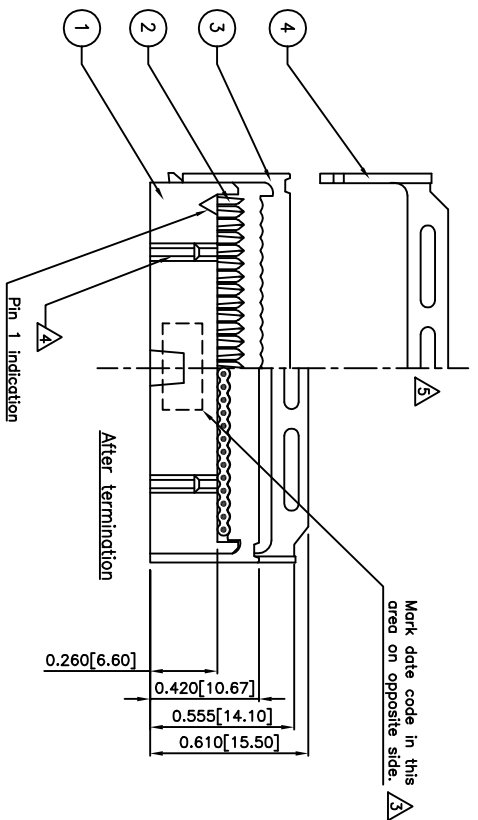

REVISIONS				
REV	ENR	DESCRIPTION	DATE	APPROVED
L	HK1406	Release to Customer	05/05/97	NELSON
M	HK3437	UPDATE DRAWING TO COMPLY WITH ROHS	07/18/05	IP

CPK Options

Accessories

Customer Drawing

ITEM NO	PART OR IDENTIFICATION NO	DESCRIPTION	QTY REQ'D
1	-	Insulator Body	1
2	-	Contact	XX
3	-	Cover	1
4	-	Strain Relief (optional)	(1)



Note: Unit in inch [mm]

APPROVAL

DATE: 07/18/05
 DRAWN: ALEX/LEE
 CHECKED: TSUI
 CHECKED:

TOLERANCES

U.S. METRIC
 X +/- .020 0.51
 XX +/- .010 0.25
 XXX +/- .005 0.13
 ANGLES +/- 2.5° 2.5°

FOR MATERIALS AND FINISHES

SEE NOTES
 DRAWING FILE: 812\C812.dwg
 DRAWING: 812\C812.dwg

DIMENSIONS

U.S. INCHES
 METRIC MM

ANGLE OF PROJECTION

REMOVE SHARP EDGES

TITLE

812 Series Connector

SIZE: A3
 DRAWING NO.: C812-XXXX-XXX
 SCALE: 2 : 1

REV. M
 SHEET 1 OF 2

For dimensions, the majority of finished components are 1% tolerance, for the connector condition field 0.5% and 0.2% for the solderable material. The tolerance for dimensions of lead wire is 0.25% for dimensions of lead wire and 0.5% for dimensions of lead wire. For dimensions of lead wire, the tolerance is 0.25% for dimensions of lead wire and 0.5% for dimensions of lead wire. For dimensions of lead wire, the tolerance is 0.25% for dimensions of lead wire and 0.5% for dimensions of lead wire.

Notes:

- Connectors purchased under this drawing will mate with MIL-C-83503/20A and MIL-C-82503/21A header connectors with latches or without latches and 816 / 821 header connectors.
- This assembly is designed to meet requirements of MIL-C-83503/7B, and European standard IEC 603-13
- For P/N with prefix "E", date code are added on back side of socket.
- This polarization key slot not available on size 10 and 14.
- Strain relief may be ordered separately. Amphenol P/N 800-1206-XXX (see table II)
- Strain relief is bagged separately.
- Center polarizing key (CPK) may be ordered separately. Amphenol P/N 800-1211-002 grey or 800-1211-012 black
- Optional closed entry cover (CEC) available. May be ordered separately. (see Table II on this sheet) assemblies ordered without standard cover and with CEC will have CEC's bagged separately.
- Polarizing plug may be ordered separately. Amphenol P/N 800-1211-004 15% GF Nylon white or 800-1211-005 30% GF PBT grey
- Termination kit P/N 357-116.
- This connector is both UL and CSA approved.
- Refer to Amphenol S-812-001 for product specification.
- Material should be fulfilled amphenol spec#SSN001.

Part Number System

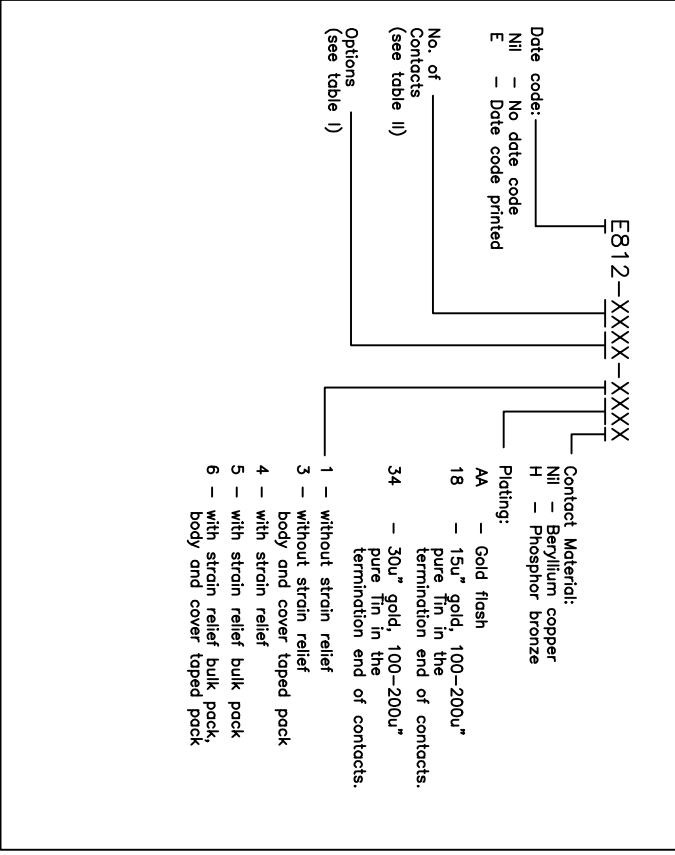

Table I - Options

- Standard product**
- 22 - Grey, no CPK
 - 33 - Grey, CPK molded-in
 - 34 - Grey, CPK molded-in, CEC even side
 - 35 - Grey, CPK molded-in, CEC odd side
 - 43 - Grey, no CPK, CEC odd side
 - 44 - Grey, no CPK, CEC even side
- Standard product with special requirement**
- 03 - Grey, no CPK, CEC bulk pack
 - 04 - Grey, CPK molded-in, CEC bulk pack
 - 12 - Grey, no CPK, cover bulk pack
 - 13 - Grey, CPK molded-in, cover bulk pack
 - 32 - Grey, CPK installed
 - 36 - Grey, CPK molded-in, CEC even side with slots
 - 37 - Grey, CPK molded-in, CEC odd side with slots
 - 38 - Grey, CPK molded-in, standard cover with slots
 - 42 - Grey, CPK Glued-in
- Non-standard product (specific quantity required)**
- 02 - Black, no CPK, non pre-latch
 - 05 - Black, no CPK, CEC bulk pack
 - 06 - Black, CPK molded-in, CEC bulk pack
 - 09 - Black, no CPK
 - 10 - Black, CPK molded-in
 - 23 - Black, no CPK
 - 45 - Black, CPK molded-in

Table II

No. of position	Strain Relief 800-1206-XXX		CEC 800-1205-XXX		In±.004	A mm±.10	In±.005	B mm±.13
	Grey	Black	Grey	Black				
10	-030	-050	-070	-090	.68	[17.27]	.40	[10.16]
14	-031	-051	-071	-091	.88	[22.35]	.60	[15.24]
16	-032	-052	-072	-092	.98	[24.89]	.70	[17.78]
20	-033	-053	-073	-093	1.18	[29.97]	.90	[22.86]
26	-034	-054	-074	-094	1.48	[37.59]	1.20	[30.48]
30	-040	-060	-080	-100	1.88	[42.67]	1.40	[35.56]
34	-035	-055	-075	-095	1.88	[47.75]	1.60	[40.64]
36	-041	-061	-081	-101	1.98	[50.29]	1.70	[43.18]
40	-036	-056	-076	-096	2.18	[55.37]	1.90	[48.26]
50	-037	-057	-077	-097	2.68	[68.07]	2.40	[60.96]
60	-038	-058	-078	-098	3.18	[80.77]	2.90	[73.66]
64	-039	-059	-079	-099	3.38	[85.85]	3.10	[78.74]



Customer Drawing

UNLESS OTHERWISE SPECIFIED		APPROVAL		DATE	
TOLERANCES		DRAWN	ALEXLEE	07/18/05	
U.S. METRIC		CHECKED	TSUI	07/18/05	
X +/-	.020	DRAWING FILE: 812\C812.dwg			
XX +/-	.010	DRAWING: 812\C812.dwg			
XXX +/-	.005	ANGLE OF PROJECTION			
ANGLES +/- 2.5°		REMOVE SHARP EDGES			
DIMENSIONS		U.S. INCHES		MM	
TITLE		SIZE		REV.	
812 Series Connector		A3		M	
DRAWING NO. C812-XXXX-XXX		SCALE		SHEET 2 OF 2	
		2 : 1			