

| | | | | | | | |
|------|---------|------------|--------|-------------------------------|---|---|---|
| 1 | 2 | 3 | 4 | 5 | 6 | 7 | 8 |
| REV. | ECN NO. | DATE | SIGN | DESCRIPTION | | | |
| A | | 2021-06-01 | Sam Ho | Rev.02 to A, Initial Released | | | |
| | | | | | | | |

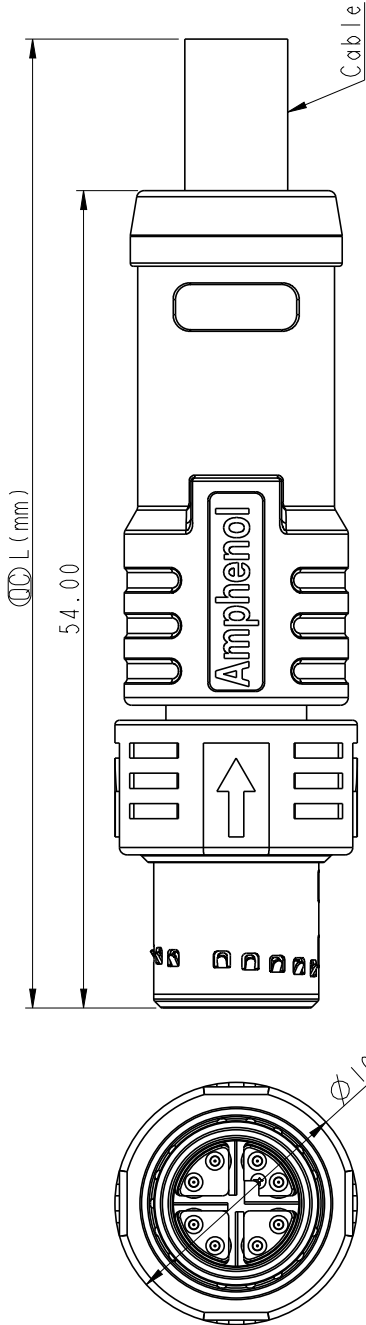

MSXS-XXBMMM-PL8XXX
 XX: No. Of Pin
 XX: 01~99Meters
 01: 01Meter
 02: 02Meters
 :
 99: 99Meters

Note:

- * \varnothing Important Dimension
- * Waterproof Rate: IPX8, Mated 1m/24h
- * Connector
- Housing: Thermoplastic, Black
- Pin: Copper Alloy, Gold Plated
- Shield & Shell & Spring: Matel
- Nut: Thermoplastic, Black
- Outer Mold: Thermoplastic, Black
- * Cable: CAT-6A, 26#*4P+AL/MY+B,
TPU Jacket, OD 6.8mm, GN.
- * Cable Length Tolerance: 1M: +50/-0 mm
 1M < L ≤ 3M: +100/-0 mm
 3M < L ≤ 5M: +150/-0 mm
 5M < L ≤ 10M: ±100 mm
 10M < L ≤ 20M: ±200 mm
 20M < L ≤ 30M: ±300 mm
 30M < L ≤ 99M: ±500 mm

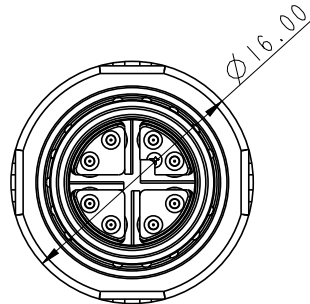

| | | |
|--------|--------------|---------|
| Shield | Braid | 編織 |
| 8 | Blue | 藍 |
| 7 | White/Blue | 白/藍 |
| 6 | Brown | 棕 |
| 5 | White/Brown | 白/棕 |
| 4 | Green | 綠 |
| 3 | White/Green | 白/綠 |
| 2 | Orange | 橘 |
| 1 | White/Orange | 白/橘 |
| Conn. | Wire Color | Pin Out |
| | | |

| | |
|-----------|---|
| UNIT: mm | ± 0.50 mm |
| TOLERANCE | |
| TITLE | N SEN, M12 X -SHLD, 08P, PUSH PULL CABLE W/O SR, M, M, MOLDING |
| SCALE | 2:1 |
| SIZE | A4 |
| REV. | A |
| NC-REV. | |
| SHEET | 1 OF 1 |
| QC | Inspection item |

Amphenol LTW
 安費諾亮泰企業股份有限公司

| | |
|-------------|--------------------|
| ITEM NO | MSXS-XXBMMM-PL8XXX |
| DWG NO | MSXS-XXBMMM-PL8XXX |
| CUSTOMER | ALTW |
| DRAWN BY | Sam Ho |
| CHECKED BY | Fred Lee |
| APPROVED BY | Fred Lee |
| DATE | 2021-04-09 |