

Crimp Fittings

Press-armaturen

Emboutis sertis

Raccordi a graffare

Racores para presión

BJ

Banjo, DIN 7642

Ringstutzen, DIN 7642

Banjo, DIN 7642

Nipplo ad occhio, DIN 7642

Banjo, DIN 7642

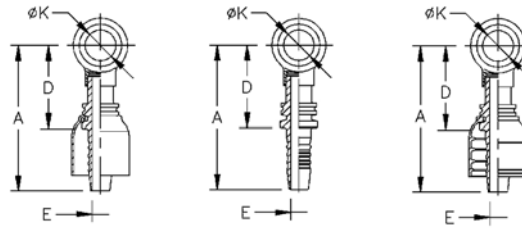

| Part Number | Part Number | Part Number | Thread T | Flange | Tube O.D. | ND | Hose Size | A | D | H | E Ø | HEX [1] | HEX [2] | K Ø |
|-------------|--------------|-------------|----------|--------|-----------|----|-----------|-------|------|----|------|---------|---------|------|
| OTC Fitting | Skive Nipple | TTC Fitting | | | mm | | | mm | mm | mm | mm | | | mm |
| 1G5BJ3 | 1S5BJ3 | 1A5BJ3 | | | 6 | 5 | -3 | 60,6 | 43,4 | | 2,5 | | | 10,1 |
| 1G6BJ4 | 1S6BJ4 | 1A6BJ4 | | | 8 | 6 | -4 | 68,8 | 45,4 | | 4,2 | | | 12,1 |
| 1G8BJ5 | 1S8BJ5 | 1A8BJ5 | | | 10 | 8 | -5 | 57,1 | 33,2 | | 5,3 | | | 14,1 |
| 1G8BJ6 | 1S8BJ6 | 1A8BJ6 | | | 10 | 10 | -6 | 76,2 | 50,9 | | 6,7 | | | 14,1 |
| 1G10BJ6 | 1S10BJ6 | 1A10BJ6 | | | 12 | 10 | -6 | 76,9 | 51,6 | | 6,7 | | | 16,1 |
| 1G12BJ6 | 1S12BJ6 | 1A12BJ6 | | | 15 | 10 | -6 | 83,2 | 57,9 | | 6,7 | | | 18,1 |
| 1G12BJ8 | 1S12BJ8 | 1A12BJ8 | | | 15 | 12 | -8 | 84,9 | 55,2 | | 9,6 | | | 18,1 |
| 1G16BJ10 | 1S16BJ10 | 1A16BJ10 | | | 18 | 16 | -10 | 90,4 | 61,1 | | 12,8 | | | 22,1 |
| 1G20BJ12 | 1S20BJ12 | 1A20BJ12 | | | 22 | 19 | -12 | 95,0 | 64,8 | | 15,5 | | | 26,1 |
| 1G25BJ16 | 1S25BJ16 | 1A25BJ16 | | | 28 | 25 | -16 | 103,8 | 69,4 | | 20,7 | | | 30,1 |