

TECHNICAL SPECIFICATIONS

D-Sub Hood:

Material: Zinc, Nickel Plated
 Operating Temperature: -40°C to +120°C
 Cable Entry: Top Entry
 Thumbscrews: UNC 4-40 (Standard)
 Cable O.D: Up to 11,5mm (Size 9-37)
 Up to 17mm (Size 50)

Male D-Sub Solder Cup:

Insulator: PBT, Black, UL94 V-0
 Shell: Steel, Tin Plated
 Contact pins: Copper Alloy
 Stamped & Formed Pins: Class 3, 100 inserts min.
 Machined Contact Pins: Class 1, 500 inserts min.
 Contact Plating: Selective Gold over Nickel
 Operating Temperature: -55°C to +105°C
 Withstanding voltage: 1000V for 1 minute
 Insulator resistance: 1000MΩ min.

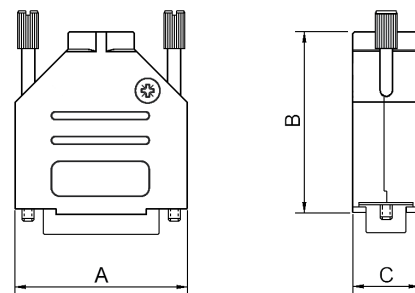

Features:

- Available in sizes 9-15-25-37-50
- Packed in Kit with MALE D-connector
- Class 3 or Class 1 connector as standard options
- Re-openable
- Full Metal Jackscrew as standard.

Size DTZK	Dim A	Dim B	Dim C
9-way	31,0	39,5	15,0
15-way	39,5	41,5	15,0
25-way	53,5	48,5	15,0
37-way	71,0	53,0	15,0
50-way	67,5	54,0	18,7

Ordering information - Black Insulator:

Size:	P/N - Kitted:	Class 3 - 100 inserts min.
9-way	6355-0002-01	DTZK09-DBP-K
15-way	6355-0002-02	DTZK15-DBP-K
25-way	6355-0002-03	DTZK25-DBP-K
37-way	6355-0002-04	DTZK37-DBP-K
50-way	6355-0002-05	DTZK50-DBP-K

Size:	P/N - Kitted:	Class 1 - 500 inserts min.
9-way	6355-0002-21	DTZK09-DMP-K
15-way	6355-0002-22	DTZK15-DMP-K
25-way	6355-0002-23	DTZK25-DMP-K
37-way	6355-0002-24	DTZK37-DMP-K
50-way	6355-0002-25	DTZK50-DMP-K

Ordering information - White Insulator:

Size:	P/N - Kitted:	Class 3 - 100 inserts min.
9-way	6355-8002-01	DTZK09-DBP-W-K
15-way	6355-8002-02	DTZK15-DBP-W-K
25-way	6355-8002-03	DTZK25-DBP-W-K
37-way	6355-8002-04	DTZK37-DBP-W-K
50-way	6355-8002-05	DTZK50-DBP-W-K

Size:	P/N - Kitted:	Class 1 - 500 inserts min.
9-way	6355-8002-21	DTZK09-DMP-W-K
15-way	6355-8002-22	DTZK15-DMP-W-K
25-way	6355-8002-23	DTZK25-DMP-W-K
37-way	6355-8002-24	DTZK37-DMP-W-K
50-way	6355-8002-25	DTZK50-DMP-W-K

