



OVERLOAD RELAY 2.8...4.0 A FOR MOTOR PROTECTION SZ S00, CLASS 10, STAND-ALONE INSTALLATION MAIN CIRCUIT: SCREW TERMINAL AUX. CIRCUIT: SCREW TERMINAL MANUAL-AUTOMATIC-RESET

| | |
|---------------------|-----------------------------|
| product brand name | SIRIUS |
| Product designation | 3RU2 thermal overload relay |

General technical data:

| | | |
|---|----|-------------|
| Active power loss total typical | W | 5.4 |
| Insulation voltage | V | 690 |
| • with degree of pollution 3 Rated value | | |
| Shock resistance | | 8g / 11 ms |
| • acc. to IEC 60068-2-27 | | |
| Surge voltage resistance Rated value | kV | 6 |
| Temperature compensation | °C | -40 ... +60 |
| Size of contactor can be combined company-specific | | S00 |
| Type of assignment | | 2 |
| Protection class IP | | IP20 |
| • on the front | | |
| • of the terminal | | IP20 |
| Equipment marking | | F |
| • acc. to DIN EN 81346-2 | | |

Main circuit:

| | | |
|--|----|-----------|
| Number of poles for main current circuit | | 3 |
| Adjustable response value current of the current-dependent overload release | A | 2.8 ... 4 |
| Operating voltage | V | 690 |
| • Rated value | | |
| • at AC-3 Rated value maximum | V | 690 |
| Operating frequency Rated value | Hz | 50 ... 60 |

| | | |
|--------------------------------------|---|---|
| Operating current Rated value | A | 4 |
| Operating current | | |
| • at AC-3 | | |
| — at 400 V Rated value | A | 4 |

Auxiliary circuit:

| | | |
|---|---|-----------------------------|
| Number of NC contacts | | |
| • for auxiliary contacts | | 1 |
| — Note | | for contactor disconnection |
| Number of NO contacts | | |
| • for auxiliary contacts | | 1 |
| — Note | | for message "Tripped" |
| Number of CO contacts | | |
| • for auxiliary contacts | | 0 |
| Design of the auxiliary switch | | integrated |
| Operating current of the auxiliary contacts at AC-15 | | |
| • at 24 V | A | 3 |
| • at 110 V | A | 3 |
| • at 120 V | A | 3 |
| • at 125 V | A | 3 |
| • at 230 V | A | 2 |
| • at 400 V | A | 1 |
| Operating current of the auxiliary contacts at DC-13 | | |
| • at 24 V | A | 2 |
| • at 110 V | A | 0.22 |
| • at 125 V | A | 0.22 |
| • at 220 V | A | 0.11 |

Protective and monitoring functions:

| | | |
|---|--|----------|
| Trip class | | CLASS 10 |
| Design of the overload circuit breaker | | thermal |

UL/CSA ratings:

| | | |
|--|---|-------------|
| Full-load current (FLA) for three-phase AC motor | | |
| • at 480 V Rated value | A | 4 |
| • at 600 V Rated value | A | 4 |
| Contact rating of the auxiliary contacts acc. to UL | | B600 / R300 |

Installation/ mounting/ dimensions:

| | | |
|--------------------------|----|--------------------------|
| mounting position | | any |
| Mounting type | | stand-alone installation |
| Height | mm | 89 |
| Width | mm | 45 |
| Depth | mm | 80 |
| Required spacing | | |

| | | |
|------------------------------|----|---|
| • with side-by-side mounting | | |
| — forwards | mm | 0 |
| — Backwards | mm | 0 |
| — upwards | mm | 6 |
| — downwards | mm | 6 |
| — at the side | mm | 6 |
| • for grounded parts | | |
| — forwards | mm | 0 |
| — Backwards | mm | 0 |
| — upwards | mm | 6 |
| — at the side | mm | 6 |
| — downwards | mm | 6 |
| • for live parts | | |
| — forwards | mm | 0 |
| — Backwards | mm | 0 |
| — upwards | mm | 6 |
| — downwards | mm | 6 |
| — at the side | mm | 6 |

Connections/ Terminals:

| | | |
|--|-----|---|
| Type of electrical connection | | |
| • for main current circuit | | screw-type terminals |
| • for auxiliary and control current circuit | | screw-type terminals |
| Arrangement of electrical connectors for main current circuit | | Top and bottom |
| Product function | | |
| • removable terminal for auxiliary and control circuit | | No |
| Type of connectable conductor cross-section | | |
| • for main contacts | | |
| — single or multi-stranded | | 2x (0,5 ... 1,5 mm ²), 2x (0,75 ... 2,5 mm ²), 2x 4 mm ² |
| — finely stranded with core end processing | | 2x (0.5 ... 1.5 mm ²), 2x (0.75 ... 2.5 mm ²) |
| • for AWG conductors for main contacts | | 2x (20 ... 16), 2x (20 ... 18), 2x 12 |
| • for auxiliary contacts | | |
| — single or multi-stranded | | 2x (0,5 ... 1,5 mm ²), 2x (0,75 ... 2,5 mm ²) |
| — finely stranded with core end processing | | 2x (0.5 ... 1.5 mm ²), 2x (0.75 ... 2.5 mm ²) |
| • for AWG conductors for auxiliary contacts | | 2x (20 ... 16), 2x (18 ... 14) |
| Tightening torque | | |
| • for main contacts with screw-type terminals | N·m | 0.8 ... 1.2 |
| Design of screwdriver shaft | | 5 to 6 mm diameter |
| Design of the thread of the connection screw | | |
| • for main contacts | | M3 |

- of the auxiliary and control contacts

M3

Safety related data:

| | | |
|--|-----|-------------|
| Proportion of dangerous failures | | |
| <ul style="list-style-type: none"> • with low demand rate acc. to SN 31920 | % | 50 |
| <ul style="list-style-type: none"> • with high demand rate acc. to SN 31920 | % | 50 |
| Failure rate [FIT] with low demand rate acc. to SN 31920 | FIT | 50 |
| MTTF with high demand rate | y | 2 280 |
| T1 value for proof test interval or service life acc. to IEC 61508 | y | 20 |
| Protection against electrical shock | | finger-safe |

Mechanical data:

| | | |
|-------------------------------|--|-----|
| Size of overload relay | | S00 |
|-------------------------------|--|-----|

Ambient conditions:

| | | |
|--|----|-------------|
| Installation altitude at height above sea level maximum | m | 2 000 |
| Ambient temperature | | |
| <ul style="list-style-type: none"> • during operation | °C | -40 ... +70 |
| <ul style="list-style-type: none"> • during storage | °C | -55 ... +80 |
| <ul style="list-style-type: none"> • during transport | °C | -55 ... +80 |
| Relative humidity during operation | % | 0 ... 90 |

Display:

| | | |
|--|--|--------------|
| Display version | | |
| <ul style="list-style-type: none"> • for switching status | | Slide switch |

Certificates/ approvals:

| | | |
|--------------------------|--------------------------------|---------------------------|
| General Product Approval | For use in hazardous locations | Declaration of Conformity |
|--------------------------|--------------------------------|---------------------------|



CCC



CSA



UL



ATEX



EG-Konf.

| | |
|-------------------|-------------------|
| Test Certificates | Shipping Approval |
|-------------------|-------------------|

[Type Test Certificates/Test Report](#)

[Special Test Certificate](#)



ABS



BUREAU VERITAS



DNV



GL

| | |
|-------------------|-------|
| Shipping Approval | other |
|-------------------|-------|



LRS



PRS



RINA



RMRS

[Environmental Confirmations](#)

Further information

Information- and Downloadcenter (Catalogs, Brochures,...)

<http://www.siemens.com/industrial-controls/catalogs>

Industry Mall (Online ordering system)

<http://www.siemens.com/industrymall>

Cax online generator

<http://support.automation.siemens.com/WW/CAXorder/default.aspx?lang=en&mfb=3RU21161EB1>

Service&Support (Manuals, Certificates, Characteristics, FAQs,...)

<http://support.automation.siemens.com/WW/view/en/3RU21161EB1/all>

Image database (product images, 2D dimension drawings, 3D models, device circuit diagrams, EPLAN macros, ...)

http://www.automation.siemens.com/bilddb/cax_de.aspx?mfb=3RU21161EB1&lang=en

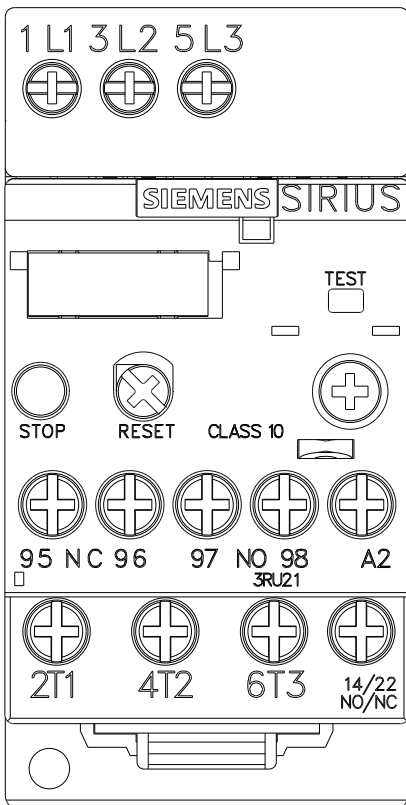
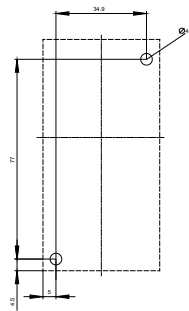
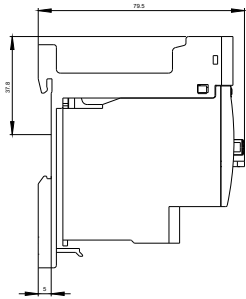
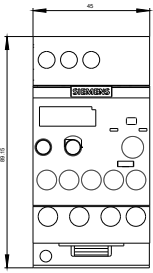

~~MEBERRASSTREZLAIS FUER~~

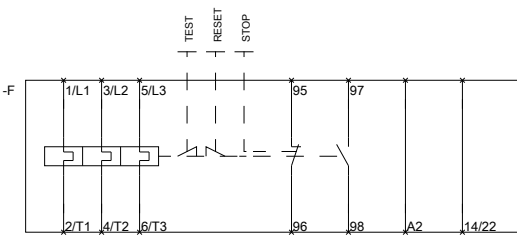

last modified:

11.03.2015

~~QVBEREOPABORIECAYONDOR~~