

CONTACTOR BASE SIZE S00/S0



General technical data:

product brand name		SIRIUS
Product designation		Contacteur base
Design of the product		for configuration of direct and reversing starters
Size of the circuit-breaker		S00, S0
Suitability for use		3RA2 load feeder

Installation/ mounting/ dimensions:

mounting position		any
Mounting type		snap-on mounting
Width	mm	44.8
Height	mm	159.8
Depth	mm	63.1
Required spacing for live parts		
• Backwards	mm	0
Required spacing for grounded parts		
• Backwards	mm	0
Required spacing with side-by-side mounting		
• Backwards	mm	0

Certificates/ approvals:

Certificate of suitability		CE / UL / CSA / CCC
----------------------------	--	---------------------



Further information

Information- and Downloadcenter (Catalogs, Brochures,...)

<http://www.siemens.com/industrial-controls/catalogs>

Industry Mall (Online ordering system)

<http://www.siemens.com/industrymall>

Cax online generator

<http://support.automation.siemens.com/WW/CAXorder/default.aspx?lang=en&mlfb=3RV29277AA00>

Service&Support (Manuals, Certificates, Characteristics, FAQs,...)

<http://support.automation.siemens.com/WW/view/en/3RV29277AA00/all>

Image database (product images, 2D dimension drawings, 3D models, device circuit diagrams, EPLAN macros, ...)

<http://www.automation.siemens.com/bilddb/index.aspx?attID9=3RV29277AA00&lang=en>

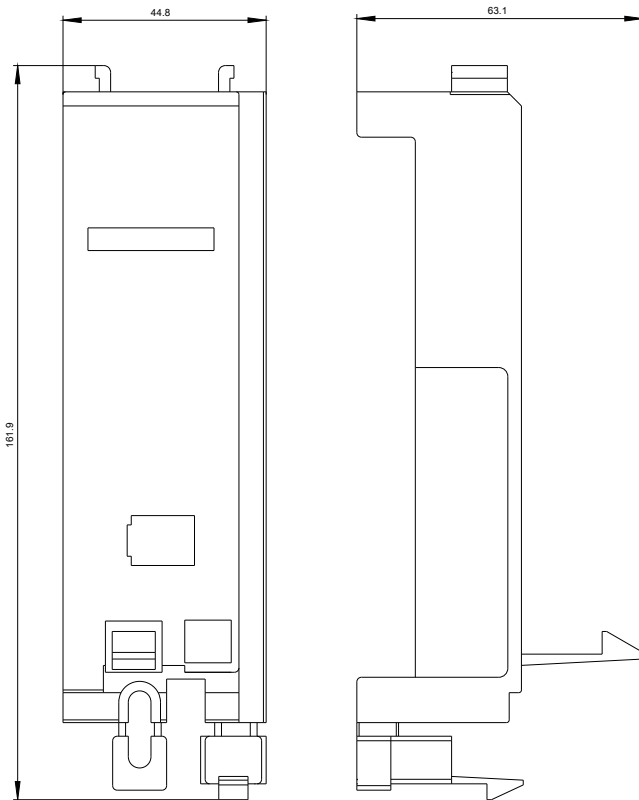

last modified:

09.03.2015