

OGS380

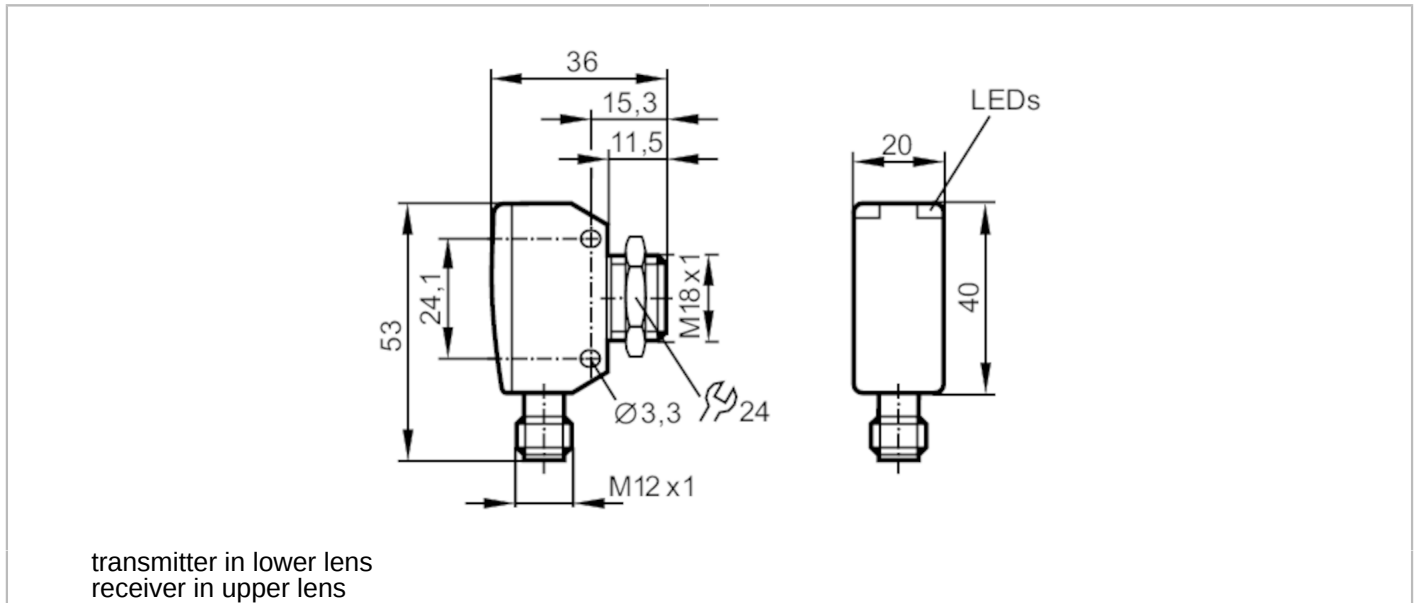

Through-beam sensor transmitter

OGS-00KG/US/V4A/CUBE



Product characteristics	
Type of light	red light
Housing	rectangular
Dimensions [mm]	M18 x 1
Application	
Function principle	Through-beam sensor
Electrical data	
Operating voltage [V]	10...30 DC
Current consumption [mA]	20
Protection class	III
Reverse polarity protection	yes
Type of light	red light
Wave length [nm]	624
Detection zone	
Transmitter / receiver	transmitter
Range [m]	< 15
Range adjustable	no
Max. light spot diameter [mm]	800
Light spot dimensions refer to	at maximum range
Operating conditions	
Ambient temperature [°C]	-25...80
Protection	IP 65; IP 67; IP 68; IP 69K
Tests / approvals	
EMC	EN 60947-5-2
MTTF [years]	1011

OGS380



Through-beam sensor transmitter

OGS-00KG/US/IV4A/CUBE

Mechanical data	
Weight [g]	78
Housing	rectangular
Dimensions [mm]	M18 x 1
Thread designation	M18 x 1
Materials	1.4542 (17-4 PH / 630); PEI
Lens material	PEI
Lens alignment	side lens

Displays / operating elements		
Display	operation	1 x LED, green

Accessories	
Accessories (supplied)	lock nut: 1 x, stainless steel

Remarks	
Remarks	operating voltage "supply class 2" according to cULus
Pack quantity	1 pcs.

Electrical connection

Connector: 1 x M12



Connection

