

# EAO – Your Expert Partner for Human Machine Interfaces

## 704.032.2 - Illuminated pushbutton round - Actuator

### 704.032.2 - Illuminated pushbutton round - Actuator



*Attention: The preview is based on a sample product. This can differ from your current configuration.*

#### Attribute

Design	raised
Front dimension	Ø 29 mm
Front form	round
Mounting cut-out	Ø 22.3 mm
Front bezel colour	Nature
Front bezel material	Aluminium
Front bezel surface	anodised
Housing colour	Grey
Housing material	Plastic
Illumination colour	Red
Illuminative colour	Red
IP front protection	IP65
Lens colour	Red
Lens illumination	illuminative
Lens material	Plastic
Lens optics	transparent
Lens shape	flush
Switching action	Momentary
Terminal	Screw terminal
Weight	0.056 kg

#### Schaltelement

max. number of switching elements	3
-----------------------------------	---

#### Function

Illuminated pushbutton

# EAO – Your Expert Partner for Human Machine Interfaces

## 704.032.2 - Illuminated pushbutton round - Actuator

### Dimensions

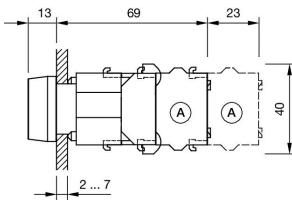

### Mounting cut-outs

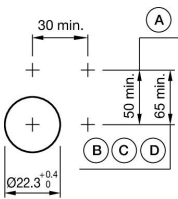

### Wiring diagrams

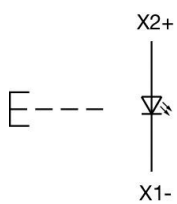

### Additional information

Frontring with protective cover to be mounted with a torque of 0.4 Nm onto actuator

Max. 3 switching elements can be clipped on

The colour of anodised aluminium parts can vary due to technical production reasons

Frontring with protective cover to be mounted with a torque of 0.4 Nm onto actuator