

### Miniature In-Line Sockets

Types K, J, T  
(ANSI Colour Code)



- Range of miniature thermocouple connectors that accept flat pins, having contact material to suit thermocouple type
- Ideal for general purpose use
- All contacts are polarised to ensure correct connection
- Connectors will accept thermocouple cable up to 4mm in diameter
- Cable clamp available for securing cable to sockets
- Available in Thermocouple types K, J, T
- For Types K, J, T contacts are made from true Thermocouple alloys
- Colour coded in accordance with ANSI specification
- Maximum continuous operating temperature 220 deg°C

T/C Type	Colour Code (ANSI)	+Positive Contact (alloy type)	-Negative Contact (alloy type)	Manufacturer's Part Number	Rapid Order Code
K	Yellow	+Nickel Chromium	-Nickel Alloy	XE-1132-001	61-3049
J	Black	+Iron	-Copper Nickel	XE-9062-001	61-3050
T	Blue	+Copper	-Copper Nickel	XE-1222-001	61-3051

#### Schematic Drawing

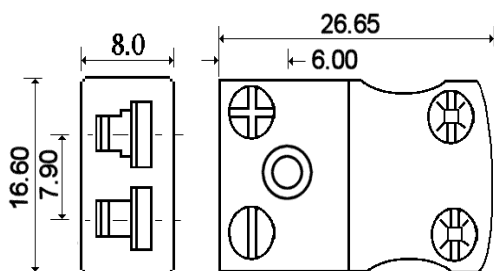

Miniature Socket