

MCM

FILE NO. 33-510

REV.

DESCRIPTION

DRAWN / DATE

APPROVED / DATE

0

INITIAL RELEASE

YANG 10/14/2014

LISA 10/14/2014

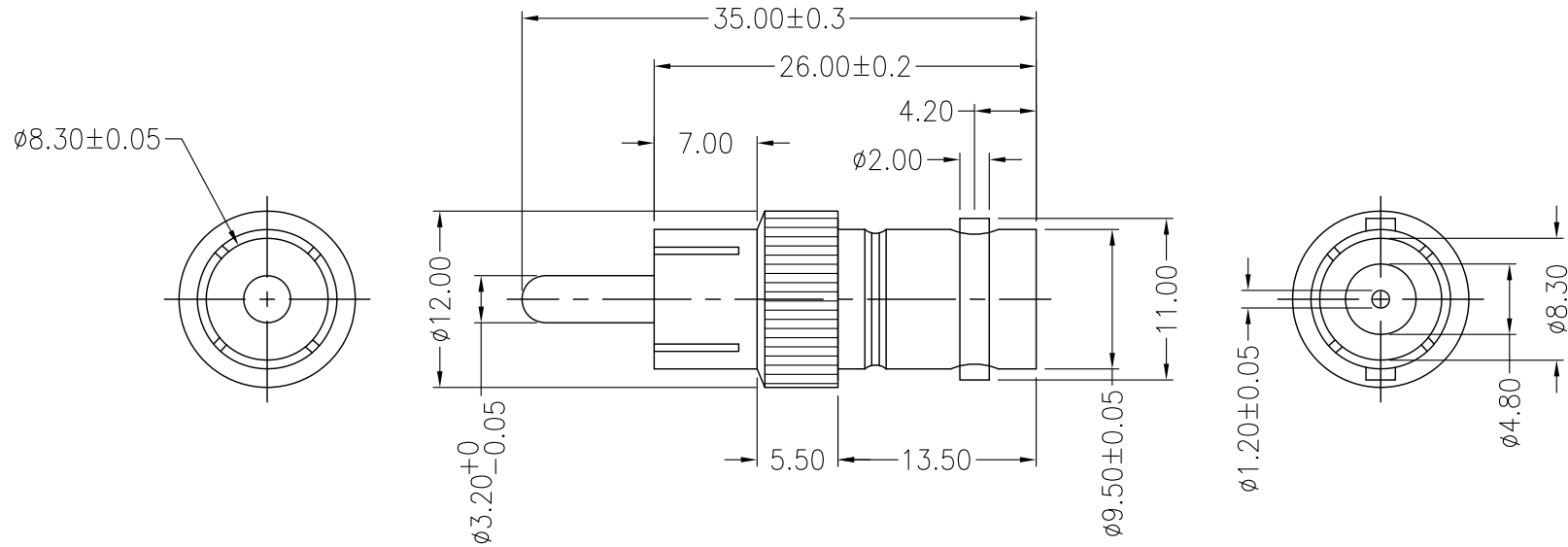

SPECIFICATION:

1. BODY: BRASS, NICKEL-PLATED
2. INSULATOR: DELRIN, WHITE
3. MALE PIN (FOR RCA): BRASS, NICKEL-PLATED
4. FEMALE PIN (FOR BNC): BRASS, NICKEL-PLATED

RoHS

www.mcmelectronics.com

DIMENSIONS ARE IN mm [INCH]	TOLERANCES ARE FRACTIONS DECIMALS ANGLES	MATERIAL	P/N	DRAWN YANG	DATE 10/14/2014
MOLD NO.	.X ± 0.20 [0.008] .XX ± 0.12 [0.005]	FINISH COLOR	PROJECT NO.		
			SCALE 2:1	SIZE A4	SHEET 1 OF 1
					MC068

BNC-Female to RCA Male
Adapter