

CONTACTOR SIZE 14, 3-POLE AC-3, 450KW,
400/380V (690V) AUXILIARY CONTACTS 44
(4NO+4NC) AC OPERATION AC 500 TO 600V
50/60HZ

General technical data:

Size of contactor		14
Protection class IP on the front		IP00
Ambient temperature during operation	°C	55 ... -25
Equipment marking acc. to DIN 40719 extended according to IEC 204-2 acc. to IEC 750		K
Equipment marking acc. to DIN EN 61346-2		Q

Main circuit:

Number of poles for main current circuit		3
Operating current at AC-1 at 400 V		
• at ambient temperature 40 °C Rated value	A	910
Number of NC contacts for main contacts		0
Number of NO contacts for main contacts		3
Operating current at AC-3 at 400 V Rated value	A	820
Operating power		
• at AC-1 at 400 V Rated value	kW	558
• at AC-3 at 400 V Rated value	kW	450

Control circuit/ Control:

Control version of the switch operating mechanism		conventional
Type of voltage of the control supply voltage		AC
Control supply voltage frequency		
• 1 Rated value	Hz	50
• 2 Rated value	Hz	60
Control supply voltage		

- with AC
 - at 50 Hz
 - Rated value
 - at 60 Hz
 - Rated value

V	500 ... 600
V	500 ... 600

Auxiliary circuit:

Number of NC contacts for auxiliary contacts		
<ul style="list-style-type: none"> • lagging switching • instantaneous contact 		0 4
Number of NO contacts for auxiliary contacts		
<ul style="list-style-type: none"> • leading contact • instantaneous contact 		0 4

Connections/ Terminals:

Type of electrical connection		
<ul style="list-style-type: none"> • for main current circuit • for auxiliary and control current circuit 		screw-type terminals screw-type terminals
Identification number and letter for switching elements		44

Mechanical data:

Mounting type		screw fixing
Mounting type Side-by-side mounting		Yes
Width	mm	230
Height	mm	295
Depth	mm	237

Certificates/ approvals:

General Product Approval	Functional Safety/Safety of Machinery
--------------------------	---------------------------------------



[Type Examination Certificate](#)

Functional Safety/Safety of Machinery	Declaration of Conformity	Test Certificates	Shipping Approval
---------------------------------------	---------------------------	-------------------	-------------------

[Type Examination](#)



[Special Test Certificate](#)

[Type Test Certificates/Test Report](#)



Shipping Approval	other
-------------------	-------



[Environmental Confirmations](#)

[other](#)

other

[Declaration of Conformity](#)

Further information

Information- and Downloadcenter (Catalogs, Brochures,...)

<http://www.siemens.com/industrial-controls/catalogs>

Industry Mall (Online ordering system)

<http://www.siemens.com/industrymall>

Cax online generator

<http://support.automation.siemens.com/WW/CAXorder/default.aspx?lang=en&mlfb=3TF69440CS7>

Service&Support (Manuals, Certificates, Characteristics, FAQs,...)

<http://support.automation.siemens.com/WW/view/en/3TF69440CS7/all>

Image database (product images, 2D dimension drawings, 3D models, device circuit diagrams, EPLAN macros, ...)

<http://www.automation.siemens.com/bilddb/index.aspx?attID9=3TF69440CS7&lang=en>

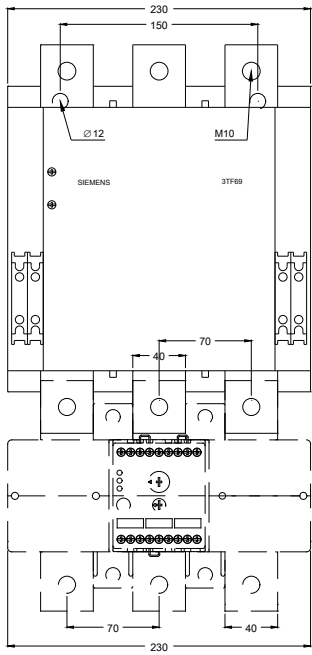

last modified:

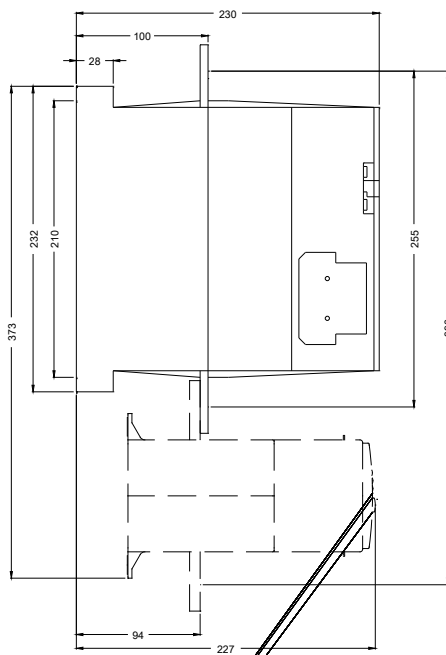

09.03.2015