

# NS5002

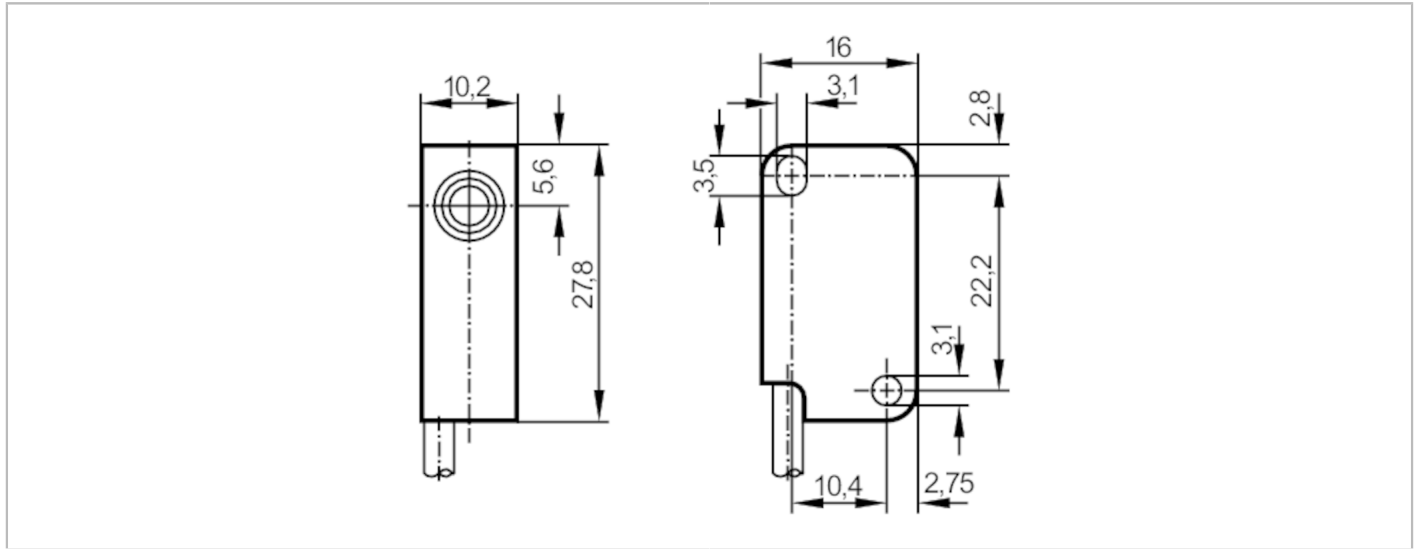

## Inductive NAMUR sensor

IS-2002-NOLED/1D/1G



### Product characteristics

Electrical design	NAMUR
Output function	normally closed
Sensing range [mm]	2
Housing	rectangular
Dimensions [mm]	28 x 10 x 16

### Electrical data

Connection to switching amplifiers	yes
Switching amplifiers	connection to certified intrinsically safe circuits with the max. values: U = 15 V / I = 50 mA / P = 120 mW
Nominal voltage DC [V]	8.2; (1k $\Omega$ )
Supply voltage DC [V]	7.5...30; (when used outside the hazardous area)
Current consumption [mA]	< 1; (disabled; conductive: > 2,1)

### Outputs

Electrical design	NAMUR
Output function	normally closed
Permanent current rating of switching output DC [mA]	30; (when used outside the hazardous area)
Switching frequency DC [Hz]	800

### Detection zone

Sensing range [mm]	2
Real sensing range Sr [mm]	2 $\pm$ 10 %

### Accuracy / deviations

Correction factor	steel: 1 / stainless steel: 0.7 / brass: 0.5 / aluminium: 0.4 / copper: 0.3
Hysteresis [% of Sr]	1...15
Switch point drift [% of Sr]	-10...10

# NS5002



## Inductive NAMUR sensor

IS-2002-NOLED/1D/1G

Operating conditions	
Ambient temperature [°C]	-20...70
Protection	IP 67
Tests / approvals	
Approval	PTB 01 ATEX 2191; BVS 04 ATEX E153; IECEx BVS 06.0003
ATEX marking	II 1G Ex ia IIB T6 Ga
	II 2G Ex ia IIC T6 Gb
	II 1D Ex ia IIIC T 90°C Da
EMC	EN 60947-5-6
Shock/vibration resistance	30 g (11 ms) / 10-55 Hz (1 mm)
MTTF [years]	4776
Safety classification	
Max. internal capacitance [nF]	80
Max. internal inductance [µH]	110
Mechanical data	
Weight [g]	84.5
Housing	rectangular
Mounting	flush mountable
Dimensions [mm]	28 x 10 x 16
Materials	PBT
Remarks	
Pack quantity	1 pcs.
Electrical connection	
Cable: 2 m, PVC; 2 x 0.14 mm <sup>2</sup>	

### Connection

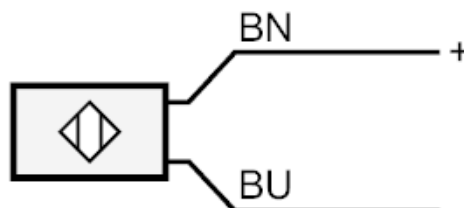

Core colours :

BN = brown  
BU = blue