



SUPPORT FOR STAND-ALONE INST. FOR
 3RU21/3RB30/3RB31/3RR2 SIZE S0, STAND-ALONE
 INSTALLATION MAIN CIRCUIT: SPRING-T. TERM.
 AUXILIARY CIRCUIT: --

General technical data:

product brand name		SIRIUS
Product designation		individual mount
Size of overload relay		S0
Ambient temperature		
• during storage	°C	-50 ... +80
• during operation	°C	-20 ... +70

Installation/ mounting/ dimensions:

Mounting type		screw and snap-on mounting onto 35 mm standard mounting rail
Width	mm	45
Height	mm	114
Depth	mm	76

Connections/ Terminals:

Type of electrical connection		screw-type terminals
• for main current circuit		
Type of connectable conductor cross-section		
• for main contacts		
— solid		1 ... 10 mm ²
— finely stranded		
— with core end processing		1 ... 6 mm ²
• for AWG conductors		
— for main contacts		1x (18 ... 8)

Certificates/ approvals:

General Product Approval				Declaration of Conformity	Test Certificates
 CCC	 CSA		 UL	 EG-Konf.	Special Test Certificate

Test Certificates	Shipping Approval				
Type Test Certificates/Test Report	 ABS	 BUREAU VERITAS	 DNV	 GL	 LRS

Shipping Approval	other
 RINA	Environmental Confirmations

Further information

Information- and Downloadcenter (Catalogs, Brochures,...)

<http://www.siemens.com/industrial-controls/catalogs>

Industry Mall (Online ordering system)

<http://www.siemens.com/industrymall>

Cax online generator

<http://support.automation.siemens.com/WW/CAXorder/default.aspx?lang=en&mlfb=3RU29263AC01>

Service&Support (Manuals, Certificates, Characteristics, FAQs,...)

<http://support.automation.siemens.com/WW/view/en/3RU29263AC01/all>

Image database (product images, 2D dimension drawings, 3D models, device circuit diagrams, EPLAN macros, ...)

<http://www.automation.siemens.com/bilddb/index.aspx?attID9=3RU29263AC01&lang=en>

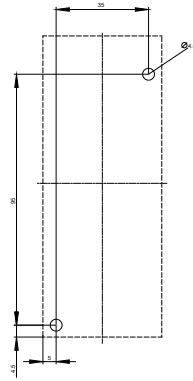
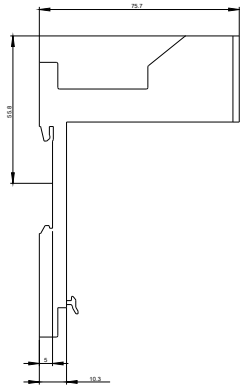
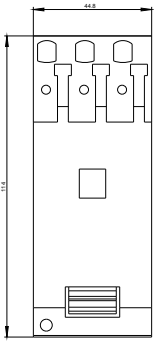

last modified:

09.03.2015