

## Cutting insert, triple-edge cutter, 60° full-profile

For universal use up to 1500 N/mm<sup>2</sup>

**ATORN**<sup>®</sup>

### Application

For producing metric right-hand and left-hand threads on CNC machines, in steel, stainless steel, non-ferrous metals, cast iron and special alloy material groups up to a strength of 1500 N/mm<sup>2</sup>.

### Version

- Three-flute cutter in full profile design (indexable inserts type A25 in four-flute cutter design)

### Advantage

- Innovative cutting geometry for excellent dimensional tolerance and process reliability
- High-quality cutting material and cutting edge finish
- Precise thread milling of profiles

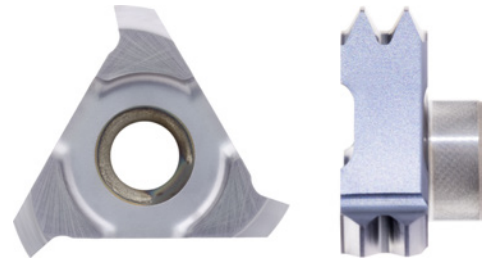

Application	Steel (N/mm <sup>2</sup> )			Stainless steel		Alu		Brass		Bronze		Plas-tics	Graphite G(C)FK	GG(G) GJMW	Titan-alloy	Nickel-alloy	Super-alloy	Hard mat.	
	<700	<1000	<1300	marten.	austen.	short	long	short	long	short	long							<55 HRC	<65 HRC
		80	60	80	60	120	180		160	80	140	140		60	30	30	30	60	

<b>Art. no.</b>	<b>13397 618</b>
<b>Pitch</b>	3.5 mm

### EAN-Code

4050293349900