



TEMPERATURE MONITORING RELAY PT100/1000, KTY83/84, NTC 2 THRESHOLDS, DIGITAL -58 DEG. F TO 932 DEG. F 24 V AC/DC 2 X 1 W + 1 NO, WIDTH 45 MM CAGE-CLAMP CONNECTION

Figure similar

General technical data:		
<b>Type of voltage</b>		AC/DC
<b>Supply voltage frequency</b>		
<ul style="list-style-type: none"> <li>• 1 for auxiliary and control current circuit</li> <li>— Initial rated value</li> <li>— Final rated value</li> </ul>	Hz	50
	Hz	60
<b>Control supply voltage</b>		
<ul style="list-style-type: none"> <li>• 1</li> <li>— with AC</li> <li>— at 50 Hz Rated value</li> <li>— at 60 Hz Rated value</li> <li>— for DC</li> <li>— Rated value</li> </ul>	V	24
	V	24
	V	24
<b>Number of measuring circuits</b>		1
<b>Number of NC contacts for auxiliary contacts</b>		0
<b>Number of NO contacts for auxiliary contacts</b>		1
<b>Number of CO contacts for auxiliary contacts</b>		2
<b>Product function</b>		
<ul style="list-style-type: none"> <li>• Fault storage</li> <li>• External reset</li> </ul>		Yes
		Yes
<b>Measurable Fahrenheit-temperature</b>		
<ul style="list-style-type: none"> <li>• initial value</li> <li>• Full-scale value</li> </ul>	°F	-58
	°F	932
<b>Equipment marking acc. to DIN EN 61346-2</b>		K

Equipment marking acc. to DIN 40719 extended according to IEC 204-2 acc. to IEC 750		K
Ambient temperature during operation	°C	-25 ... +60

#### Mechanical data:

<b>Type of electrical connection</b>		spring-loaded terminals
<ul style="list-style-type: none"> <li>• for auxiliary and control current circuit</li> <li>• Plug-in socket</li> </ul>		Yes
<b>Design of the sensor connectable</b>		PT100/1000, KTY83/84, NTC (resistance sensors)
<b>Width</b>	mm	45
<b>Height</b>	mm	108
<b>Depth</b>	mm	91

#### Certificates/ approvals:

General Product Approval	Test Certificates	other
--------------------------	-------------------	-------



[Special Test Certificate](#)

[Environmental Confirmations](#)

[Declaration of Conformity](#)

#### Further information

##### Information- and Downloadcenter (Catalogs, Brochures,...)

<http://www.siemens.com/industrial-controls/catalogs>

##### Industry Mall (Online ordering system)

<http://www.siemens.com/industrymall>

##### Cax online generator

<http://support.automation.siemens.com/WW/CAXorder/default.aspx?lang=en&mlfb=3RS20402GD50>

##### Service&Support (Manuals, Certificates, Characteristics, FAQs,...)

<http://support.automation.siemens.com/WW/view/en/3RS20402GD50/all>

##### Image database (product images, 2D dimension drawings, 3D models, device circuit diagrams, EPLAN macros, ...)

<http://www.automation.siemens.com/bilddb/index.aspx?attID9=3RS20402GD50&lang=en>

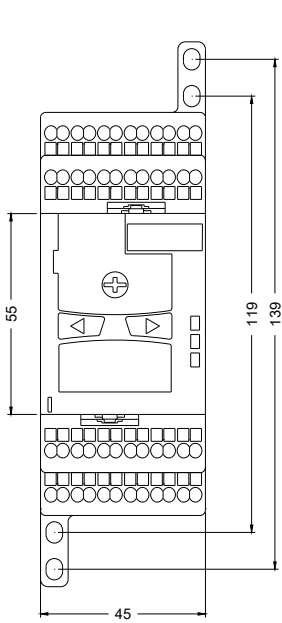

last modified:

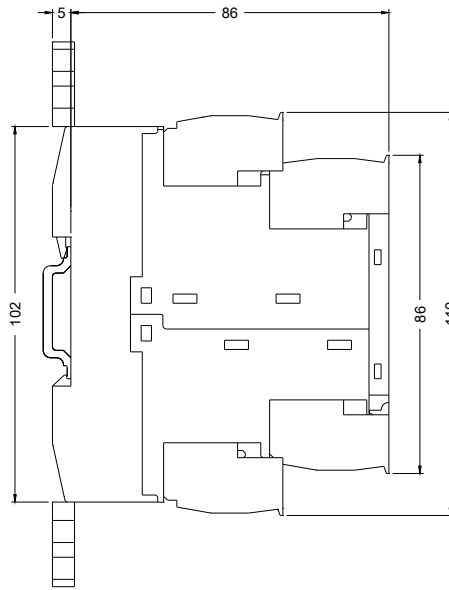

09.03.2015