

Technical requirement:

1. Unmarked tolerance dimension on the basis of SJ/T10628 - 1995 6 grade;
2. ROHS 2.0 AND REACH COMPLIANT
3. Accessory:
 - double faced adhesive tape-----1pcs
 - Nylon cable ties 2.5*80mm-----1pcs
4. Packing: 1PC/PE bag+label

MATERIAL LIST:

| | | | | |
|----|------------|--------------------|------|--------|
| ③ | SCREW | ST4*20MM | 1 | |
| ② | Base | ABS White RAL 9003 | 1 | |
| ① | roof cover | ABS White RAL 9003 | 1 | |
| NO | MAT. NAME | DESCRIPTION | QT'Y | REMARK |

| | | | | | | | | | |
|-------------------|-----|-------------------------------|------------|---------------------|------|------------|------------|------------|------------|
| SYNERGY 21 | | | | | | | | | |
| CUSTOMER | | | | ITEM NO. | | S216347 | | | |
| PRODUCT NAME | | Surface Mount Box 1port | | manufacture country | | CHINA | | UNIT | MM |
| NEW | | | 2018-10-17 | | A | DRAWNBY | | CHECKBY | |
| BY | CHK | REVISION RECORD MODIFICATIONS | | | DATE | REV. | SYNERGY 21 | | SYNERGY 21 |
| | | | | | | APPOBY | | DATE | |
| | | | | | | SYNERGY 21 | | 2018-10-17 | |

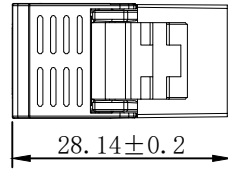
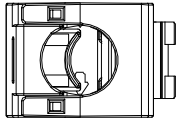
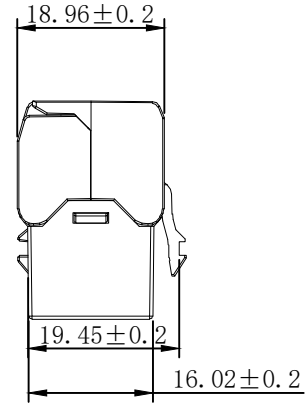
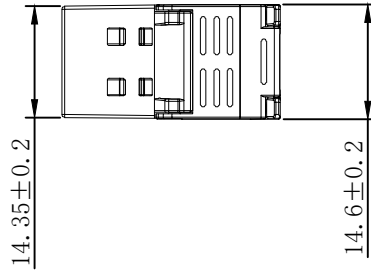

NOTE:

ELECTRICAL

1. Contact Resistance :200Ω MAX
2. Insulation Resistance :500Ω MIN @ 500V DC
3. Withstand Voltage :DC 1000V AC 700V RMS 60Hz, 1MIN

ENVIRONMENTAL:

Storage : -40°C TO+70°C
 Operation: -10°C TO+60°C

MECHANICAL

1. SHIELD MATERIAL:ZINC ALLOY (Silver)
2. IDC MATERIAL:PC UL94V0 TERMINAL: PHOSPHOR BRONZE, TIN PLATING
3. RJ45 Contact Life:750 Times Min
4. Plug inforce:<30N
5. Solid cable:1/22AWG(0.65MM)-1/24AWG(0.45MM) ID:0.8MM-1.6MM
6. Cable OD:5.0mm-8.5mm
7. PoE per IEEE 802.3af,PoE+per IEEE 802.3at

Fluke Test:Permanent Link ISO 11801 (PL 2)Class Ea
 RoHS 3.0 and REACH Compliant
 Packing:1pc+copper foil/PE bag+label

MATERIAL LIST:

| ⑦ | IDC TERMINAL | FOR 22-24AWG (0.45mm-0.65mm) CABLE | 1 | |
|-----|-------------------|------------------------------------|------------|--------|
| ⑥ | LABEL COLOR CODE | T568A/B | 2 | |
| ⑤ | IDC PIN | PHOSPHOR BRONZE & TINNED | 8 | |
| ④ | IDC BODY | FIREPROOF/PC UL 94V0 | 1 | |
| ③ | PCB | 1.2mm UL 94V0 | 1 | |
| ② | RJ-45 JACK INSERT | PHOSPHOR BRONZE 8P8C GOLD PLATED | 8 | |
| ① | MODULAR COVER | ZINC ALLOY | 1 | |
| NO. | PARTS NAME | SPECIFICATION DESCRIPTION | QT'Y | REMARK |
| | | NEW | 2022-09-30 | A |
| BY | CHK | REVISION RECORD MODIFICATIONS | DATE | REV. |

SYNERGY21

| | | | | | |
|------------------------------|--|----------------------|--|------------|------|
| CUSTOMER | | ITEM NO. | | S216380 | |
| PRODUCT NAME | | manufacture country: | | CHINA | UNIT |
| CAT. 6A FTP KEYSTONE JACK | | | | | MM |
| DRAWNBY | | CHECKBY | | APPOBY | |
| SYNERGY21 | | SYNERGY21 | | SYNERGY21 | |
| | | | | DATE | |
| | | | | 2022-09-30 | |

Installationsanleitung/Installation guide

Keystone Jack

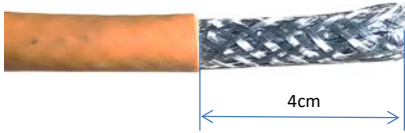

①.Stripping 4cm of sheath.



②.foldback braided and drained wire.



③.paste copper foil on the braided and ground wire and cut off the excess weave and the ground wire



④.4.Fan out all four twisted pairs, allocate each by following colorcoding label



⑤.Across the holde by the color marks of T568A or T568B

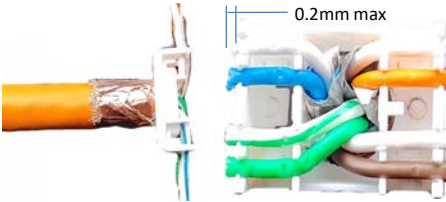

⑥. allocate each conductor into proper slots on wiring cap by following color coding



⑦.Trim the theends of conductors.

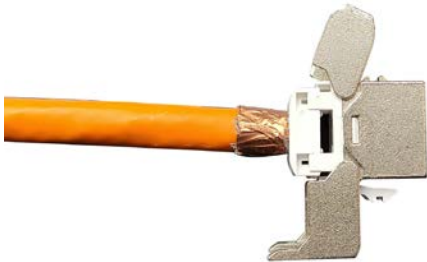

⑧.install the termination cap in direction of arrow into the keystone jack



⑨.press both covers of the keystone jack to contact the cable



⑩.Press down the retainer for 360 degree shielding