

## GE-NPT Terminale maschio diritto

Filettatura maschio NPT (SAE J476) / Estremità conica EO 24°

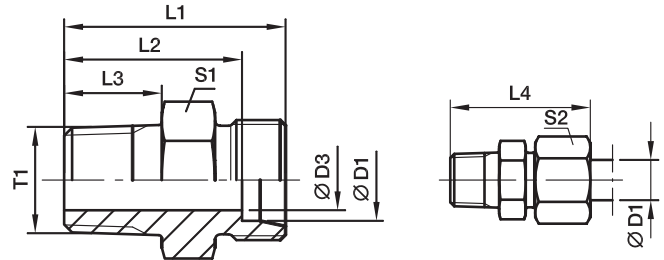

Serie	D1	T1	D3	L1	L2	L3	L4	S1	S2	Peso g/1 pezzo	Codice di ordinazione*	PN (bar) <sup>1)</sup>		
												CF	71	MS
LL <sup>2)</sup>	04	1/8-27 NPT	3,0	22,0	18,0	10,0	28	11	10	9	GE04LL1/8NPT	100	100	
	06	1/8-27 NPT	4,5	22,0	16,5	10,0	28	11	12	9	GE06LL1/8NPT	100	100	63
	08	1/8-27 NPT	5,0	24,0	18,5	10,0	30	12	14	11	GE08LL1/8NPT	100	100	63
L <sup>3)</sup>	06	1/8-27 NPT	4,0	24,0	17,0	10,0	32	12	14	12	GE06L1/8NPT	315	315	200
	06	1/4-18 NPT	4,0	30,0	23,0	14,5	38	17	14	27	GE06L1/4NPT	315	315	200
	06	3/8-18 NPT	4,0	30,0	23,0	14,5	38	19	14	32	GE06L3/8NPT	315	315	
	06	1/2-14 NPT	4,0	36,0	29,0	19,5	44	22	14	53	GE06L1/2NPT	315	315	
	08	1/8-27 NPT	4,0	25,0	18,0	10,0	33	14	17	16	GE08L1/8NPT	315	315	
	08	1/4-18 NPT	6,0	30,0	23,0	14,5	38	17	17	25	GE08L1/4NPT	315	315	200
	08	3/8-18 NPT	6,0	30,0	23,0	14,5	38	19	17	34	GE08L3/8NPT	315	315	
	08	1/2-14 NPT	6,0	36,0	29,0	19,5	44	22	17	54	GE08L1/2NPT	315	315	
	10	1/8-27 NPT	4,0	25,0	18,0	10,0	33	17	19	19	GE10L1/8NPT	315	315	
	10	1/4-18 NPT	7,0	31,0	24,0	14,5	39	17	19	25	GE10L1/4NPT	315	315	200
	10	3/8-18 NPT	7,0	32,0	25,0	14,5	40	19	19	40	GE10L3/8NPT	315	315	
	10	1/2-14 NPT	8,0	37,0	30,0	19,5	45	22	19	54	GE10L1/2NPT	315	315	
	10	3/4-14 NPT	8,0	38,0	31,0	19,5	46	30	19	93	GE10L3/4NPT	315	315	
	12	1/8-27 NPT	4,0	26,0	19,0	10,0	34	19	22	52	GE12L1/8NPT	315	315	
	12	1/4-18 NPT	7,0	32,0	25,0	14,5	40	19	22	31	GE12L1/4NPT	315	315	200
	12	3/8-18 NPT	8,0	32,0	25,0	14,5	40	19	22	37	GE12L3/8NPT	315	315	200
	12	1/2-14 NPT	10,0	37,0	30,0	19,5	45	22	22	62	GE12L1/2NPT	315	315	200
	15	3/8-18 NPT	8,0	33,0	26,0	14,5	41	24	27	53	GE15L3/8NPT	315	315	
	15	1/2-14 NPT	12,0	38,0	31,0	19,5	46	24	27	63	GE15L1/2NPT	315	315	200
	15	3/4-14 NPT	12,0	39,0	32,0	19,5	47	30	27	112	GE15L3/4NPT	315	315	
	15	1-11,5 NPT	12,0	45,0	38,0	24,5	53	36	27	158	GE15L1NPT	315	315	
	18	3/8-18 NPT	8,0	34,0	26,5	14,5	43	27	32	69	GE18L3/8NPT	315	315	
	18	1/2-14 NPT	12,0	39,0	31,5	19,5	48	27	32	79	GE18L1/2NPT	315	315	200
	18	3/4-14 NPT	15,0	39,0	31,5	19,5	48	30	32	104	GE18L3/4NPT	315	315	
	18	1-11,5 NPT	15,0	45,0	37,5	24,5	54	36	32	159	GE18L1NPT	315	315	
	22	3/8-18 NPT	8,0	36,5	29,0	14,5	45	32	36	91	GE22L3/8NPT	160	160	
	22	1/2-14 NPT	12,0	41,0	33,5	19,5	50	32	36	96	GE22L1/2NPT	160	160	
	22	3/4-14 NPT	16,0	41,0	33,5	19,5	50	32	36	108	GE22L3/4NPT	160	160	100
	22	1-11,5 NPT	19,0	47,0	39,5	24,5	56	36	36	174	GE22L1NPT	160	160	
	28	3/4-14 NPT	16,0	42,0	34,5	19,5	51	41	41	157	GE28L3/4NPT	160	160	
	28	1-11,5 NPT	21,0	47,0	39,5	24,5	56	41	41	197	GE28L1NPT	160	160	100
	28	1 1/4-11,5 NPT	24,0	49,0	41,5	25,0	58	46	41	266	GE28L11/4NPT	160	160	
	35	1-11,5 NPT	22,0	50,0	39,5	24,5	61	46	50	280	GE35L1NPT	160	160	
	35	1 1/4-11,5 NPT	28,0	51,0	40,5	25,0	62	46	50	285	GE35L11/4NPT	160	160	
	42	1 1/4-11,5 NPT	28,0	53,0	42,0	25,0	65	55	60	382	GE42L11/4NPT	160	160	
	42	1 1/2-11,5 NPT	36,0	53,0	42,0	26,0	65	55	60	377	GE42L11/2NPT	160	160	

1) Pressione indicata = Articolo disponibile

2) LL = Serie ultraleggera; 3) L = Serie leggera

$$\frac{PN \text{ (bar)}}{10} = PN \text{ (MPa)}$$

Consegna senza dado né anello. Per informazioni sull'ordinazione di raccordi completi vedere pag. 17.

\*Aggiungere i suffissi qui di seguito in base al materiale e alla superficie richiesti.

Suffissi codice di ordinazione		
Materiale	Suffisso superficie e materiale	Esempio
Acciaio, zincato, esente da CromoVI	CFX	GE18L1/2NPTCFX
Acciaio inossidabile	71X	GE18L1/2NPT71X
Ottone	MSX	GE18L1/2NPTMSX

## GE-NPT Terminale maschio diritto

Filettatura maschio NPT (SAE J476) / Estremità conica EO 24°

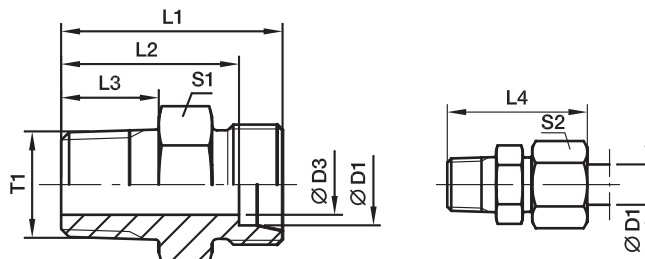

Serie	D1	T1	D3	L1	L2	L3	L4	S1	S2	Peso g/1 pezzo	Codice di ordinazione*	PN (bar) <sup>1)</sup>		
												CF	71	MS
S <sup>4)</sup>	06	1/8-27 NPT	4	28	21,0	10,0	36	14	17	21	<b>GE06S1/8NPT</b>	630	630	
	06	1/4-18 NPT	4	35	28,0	14,5	43	17	17	37	<b>GE06S1/4NPT</b>	630	630	400
	06	3/8-18 NPT	4	33	26,0	14,5	41	19	17	40	<b>GE06S3/8NPT</b>	630	630	
	06	1/2-14 NPT	4	42	35,0	19,5	50	22	17	71	<b>GE06S1/2NPT</b>	630	630	
	08	1/4-18 NPT	5	35	28,0	14,5	43	17	19	38	<b>GE08S1/4NPT</b>	630	630	400
	08	3/8-18 NPT	5	35	28,0	14,5	43	19	19	46	<b>GE08S3/8NPT</b>	630	630	
	08	1/2-14 NPT	5	42	35,0	19,5	50	22	19	73	<b>GE08S1/2NPT</b>	630	630	400
	10	1/4-18 NPT	5	35	27,5	14,5	44	19	22	45	<b>GE10S1/4NPT</b>	630	630	
	10	3/8-18 NPT	7	35	27,5	14,5	44	19	22	49	<b>GE10S3/8NPT</b>	630	630	400
	10	1/2-14 NPT	7	42	34,5	19,5	51	22	22	73	<b>GE10S1/2NPT</b>	630	630	400
	10	3/4-14 NPT	7	44	36,5	19,5	53	30	22	125	<b>GE10S3/4NPT</b>	630	630	
	12	1/4-18 NPT	5	37	29,5	14,5	46	22	24	57	<b>GE12S1/4NPT</b>	630	630	
	12	3/8-18 NPT	8	37	29,5	14,5	46	22	24	62	<b>GE12S3/8NPT</b>	630	630	400
	12	1/2-14 NPT	8	42	34,5	19,5	51	22	24	83	<b>GE12S1/2NPT</b>	630	630	400
	12	3/4-14 NPT	8	44	36,5	19,5	53	30	24	126	<b>GE12S3/4NPT</b>	630	630	
	14	3/8-18 NPT	8	39	31,0	14,5	49	24	27	77	<b>GE14S3/8NPT</b>	630	630	
	14	1/2-14 NPT	10	44	36,0	19,5	54	24	27	89	<b>GE14S1/2NPT</b>	630	630	400
	14	3/4-14 NPT	10	46	38,0	19,5	56	30	27	130	<b>GE14S3/4NPT</b>	630	630	
	14	1-11,5 NPT	10	51	43,0	24,5	61	36	27	180	<b>GE14S1NPT</b>	630	630	
	16	3/8-18 NPT	8	39	30,5	14,5	49	27	30	84	<b>GE16S3/8NPT</b>	400	400	
	16	1/2-14 NPT	12	48	39,5	19,5	58	32	30	97	<b>GE16S1/2NPT</b>	400	400	250
	16	3/4-14 NPT	12	46	37,5	19,5	56	30	30	130	<b>GE16S3/4NPT</b>	400	400	
	16	1-11,5 NPT	12	51	42,5	24,5	61	36	30	178	<b>GE16S1NPT</b>	400	400	
	20	1/2-14 NPT	12	48	37,5	19,5	59	32	36	144	<b>GE20S1/2NPT</b>	400	400	
	20	3/4-14 NPT	16	48	37,5	19,5	59	32	36	149	<b>GE20S3/4NPT</b>	400	400	250
	20	1-11,5 NPT	16	55	44,5	24,5	66	36	36	243	<b>GE20S1NPT</b>	400	400	
	25	3/4-14 NPT	16	52	40,0	19,5	64	41	46	240	<b>GE25S3/4NPT</b>	400	400	
	25	1-11,5 NPT	20	57	45,0	24,5	69	41	46	278	<b>GE25S1NPT</b>	400	400	
	25	1 1/4-11,5 NPT	20	58	46,0	25,0	70	46	46	396	<b>GE25S11/4NPT</b>	400	400	
	25	1 1/2-11,5 NPT	20	61	49,0	26,0	73	50	46	469	<b>GE25S11/2NPT</b>	400	400	
	30	3/4-14 NPT	16	54	40,5	19,5	67	46	50	307	<b>GE30S3/4NPT</b>	400	400	
	30	1-11,5 NPT	20	59	45,5	24,5	72	46	50	343	<b>GE30S1NPT</b>	400	400	100
	30	1 1/4-11,5 NPT	25	60	46,5	25,0	73	46	50	397	<b>GE30S11/4NPT</b>	400	400	
	30	1 1/2-11,5 NPT	25	60	46,5	26,0	73	50	50	440	<b>GE30S11/2NPT</b>	400	400	
	38	1-11,5 NPT	22	64	48,0	24,5	79	55	60	510	<b>GE38S1NPT</b>	315	315	
	38	1 1/4-11,5 NPT	25	65	49,0	25,0	80	55	60	535	<b>GE38S11/4NPT</b>	315	315	
	38	1 1/2-11,5 NPT	32	65	49,0	26,0	80	55	60	571	<b>GE38S11/2NPT</b>	315	315	

<sup>1)</sup> Pressione indicata = Articolo disponibile

<sup>4)</sup> S = Serie pesante

PN (bar) = PN (MPa)  
10

**Consegna senza dado né anello. Per informazioni sull'ordinazione di raccordi completi vedere pag. 17.**

\*Aggiungere i **suffissi** qui di seguito in base al materiale e alla superficie richiesti.

Suffissi codice di ordinazione		
Materiale	Suffisso superficie e materiale	Esempio
Acciaio, zincato, esente da CromoVI	CFX	GE16S1/2NPTCFX
Acciaio inossidabile	71X	GE16S1/2NPT71X
Ottone	MSX	GE16S1/2NPTMSX