

## General Purpose ABS Enclosures



### DESCRIPTION

An ABS box with pre-drilled 2.54mm pitch matrix board with copper pads.

### DISTINCTIVE FEATURES

- Attractive ABS enclosure with a light spark finish
- Includes a precut 80x52mm 2.54mm pitch matrix board with 343 holes for component mounting
- Matrix board requires no cutting to fit
- Lid features a recess for labels or displays & a cut out for wiring
- 5mm hole in lid for LED mounting
- Supplied complete with self-adhesive feet and 8 fixing screws

### APPLICATIONS

Ideal for projects and prototype applications.

ABS

RAL  
1500

PCB  
Incl

Combi  
head





## GENERAL SPECIFICATION

Series	ABS enclosures
Type	General purpose enclosure
External Features	Hole for LED mounting
Internal Features	Matrix board
Screw size	M3 x 6mm Combi head
RoHS Compliant	Yes



## MATERIALS

Material enclosure (Base)	ABS (UL94-HB)
Material lid (Cover)	ABS (UL94-HB)
Finish	Textured
Enclosure colour (Base)	Black
RAL colour code (Base)	1500
Enclosure colour (Lid)	Black
RAL colour (Lid)	1500
Screws	Steel, Zinc plated
Inserts	None
Feet	SBR (synthetic rubber)



## ENVIRONMENTAL/OPERATING SPECIFICATION

Flame Resistance	UL94-HB
------------------	---------



## DIMENSIONS/DRAWINGS

Units	mm - unless stated otherwise
Dimensions	58 x 88 x 30mm
Weight (grams)	48

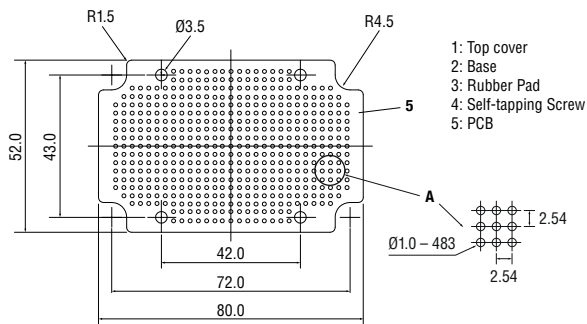

- 1: Top cover
- 2: Base
- 3: Rubber Pad
- 4: Self-tapping Screw
- 5: PCB

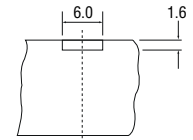
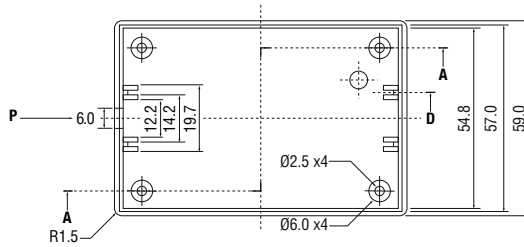

P - VIEW

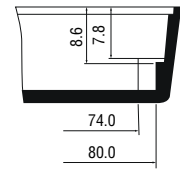

D - SEC

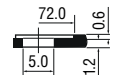

B - SEC

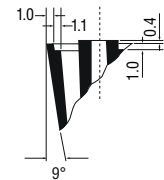

C

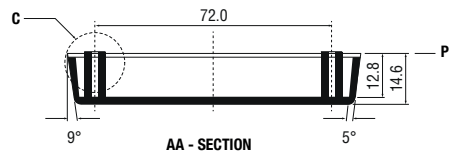

AA - SECTION

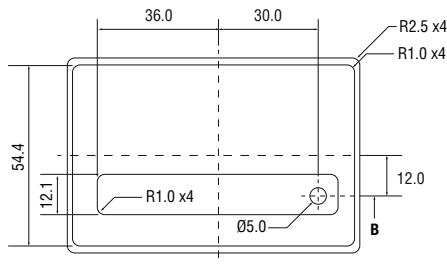

## PART NUMBER TABLE

Part Number	UNSPSC	EAN	Country Of Origin
30-1936	39121324	5053556002979	China

# R-TECH

Tried & trusted technology

**Important Notice:** This data sheet and its contents (the "Information") belong to Rapid Electronics Limited or are licensed to it. No licence is granted for the use of it other than for information purposes in connection with the products to which it relates. No licence of any intellectual property rights is granted. The Information is subject to change without notice and replaces all data sheets previously supplied. The Information supplied is believed to be accurate but Rapid Electronics Limited assumes no responsibility for its accuracy or completeness, any error in or omission from it or for any use made of it. Users of this data sheet should check for themselves the Information and the suitability of the products for their purpose and not make any assumptions based on information included or omitted. Liability for loss or damage resulting from any reliance on the Information or use of it (including liability resulting from negligence or where Rapid Electronics Limited were aware of the possibility of such loss or damage arising) is excluded. This will not operate to limit or restrict Rapid Electronics Limited's liability for death or personal injury resulting from its negligence.