

Full Metal Hoods

DTZF-LJS+Screw Type Connector

TECHNICAL SPECIFICATIONS

D-Sub Hood:

Material: Zinc, Nickel Plated
 Operating Temperature: -45°C to + 105°C
 Cable Entry: Top Entry
 Thumbscrews: UNC 4-40 (Standard)

Cable O.D - Standard:

9-Way: Up to 6,5mm with grommet - 9,5mm without grommet
 15-Way: Up to 6,5mm with grommet - 12,5mm without grommet
 25-Way: Up to 8.0mm with grommet - 12,5mm without grommet



D-Sub Screw Connector:

Insulator: Glass filled TP, UL94 V-0
 Shell: Steel, Tin Plated
 Contact pins: Machined Brass pins
 15µ" Gold plated over Ni.
 AWG Wire Size: AWG 18
 Contact Plating: Gold flash over Nickel
 Operating Temperature: -55°C to +85°C
 Withstanding voltage: >1000V Rms to 50 Hz
 for 1 minute
 Current Rating: 7.5A
 Insulator resistance: >5000MΩ min.

Features:

- Available in sizes 9-15-25
- Excellent EMI Shielding
- Re-openable
- Spring-Clip mounted Jackscrews

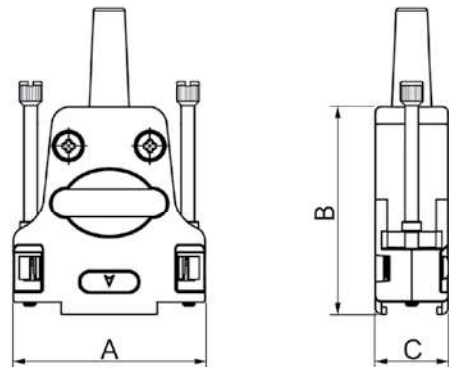

| Size DTZF | Dim A | Dim B | Dim C |
|-----------|-------|-------|-------|
| 9-way | 31,6 | 39,5 | 15,2 |
| 15-way | 40,0 | 41,0 | 15,2 |
| 25-way | 53,7 | 47,5 | 15,2 |

Ordering information:

Screw Connector D-Sub Connector Kits

| Size: | P/N - Kitted: | Description: |
|--------|------------------------------|---------------------|
| 9-way | L17DTZF09-LJS-RG+L717DE09PST | Screw type, 9-Male |
| 15-way | L17DTZF15-LJS-RG+L717DA15PST | Screw type, 15-Male |
| 25-way | L17DTZF25-LJS-RG+L717DB25PST | Screw type, 25-Male |

| Size: | P/N - Kitted: | Description: |
|--------|-----------------------------|-----------------------|
| 9-way | L17DTZF09-LJS-RG+L77DE09SST | Screw type, 9-Female |
| 15-way | L17DTZF15-LJS-RG+L77DA15SST | Screw type, 15-Female |
| 25-way | L17DTZF25-LJS-RG+L77DB25SST | Screw type, 25-Female |