

NOTES:

1. MATERIALS AND FINISHES:  
 MCX STR CRIMP PLUG - BeCu, GOLD PLATING  
 CABLE - RG 316
2. ELECTRICAL:  
 A. IMPEDANCE: 50 OHM
3. PACKAGING:  
 A. QUANTITY: SINGLE PACK  
 B. MARKING: BAG TO BE MARKED  
 "AMPHENOL RF, 255101-01-XX.XX AND DATE CODE".

THIRD ANGLE PROJ.

REVISIONS

REV	DESCRIPTION	DATE	ECO	APPR
A	RELEASE TO MFG.	--	--	--
B	FORMAT UPDATED, 18.00", 48.00" & METRIC LENGTHS ADDED	26-Jul-16	1401	NR
C	METRIC PART NUMBER UPDATED	30-Sep-16	02021	AG

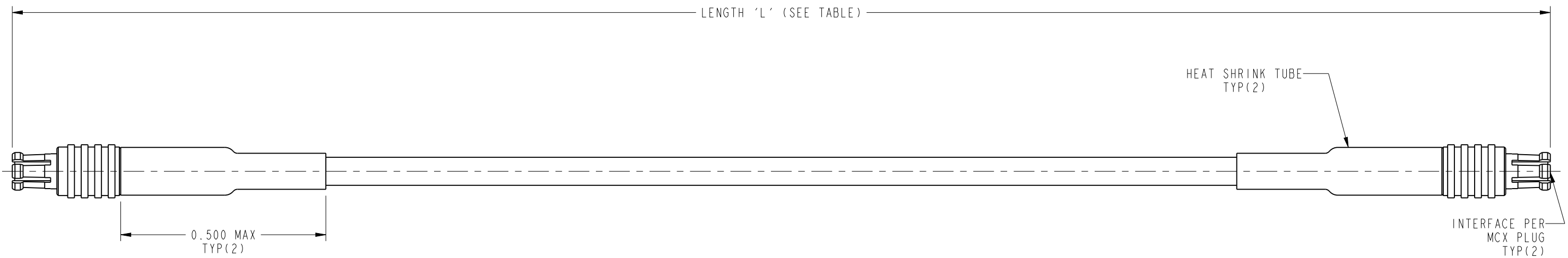
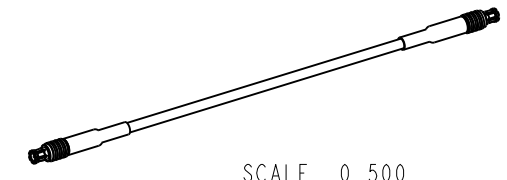

LENGTH TABLE		
PART NUMBER (IMPERIAL)	PART NUMBER (METRIC)	LENGTH 'L' IN INCHES [METERS]
255101-01-06.00	-	6.00 [0.152]
-	255101-01-M0.25	9.84 [0.250]
255101-01-12.00	-	12.00 [0.305]
255101-01-18.00	-	18.00 [0.457]
-	255101-01-M0.50	19.69 [0.500]
255101-01-24.00	-	24.00 [0.610]
-	255101-01-M0.75	29.53 [0.750]
255101-01-36.00	-	36.00 [0.914]
-	255101-01-M1.00	39.37 [1.000]
255101-01-48.00	-	48.00 [1.219]
-	255101-01-M2.00	78.74 [2.000]
-	255101-01-M4.00	157.48 [4.000]

TOLERANCE TABLE	
LENGTH IN INCHES/FT [METERS]	TOLERANCE
0" - 23.90" [0 - 0.607]	±0.25" [0.006]
24.00" - 59.00" [0.610 - 1.499]	±0.50" [0.013]
5.0' - 24.9' [1.524 - 7.617]	±2.5%
25.0' & UP [7.620 & UP]	±5.0%

DESIGN REQUIREMENTS:

- FREQUENCY : \_\_\_\_ TO \_\_\_\_ GHz      CONTINUITY  
 VSWR \_\_\_\_ : 1 MAX                      HI-POT : 750 VRMS  
 INS. LOSS : \_\_\_\_ dB MAX                OTHER

**CUSTOMER OUTLINE DRAWING**

ALL OTHER SHEETS ARE FOR INTERNAL USE ONLY

UNLESS OTHERWISE SPECIFIED, DIMENSIONS ARE IN INCHES AND TOLERANCES ARE: 2 PLACE DECIMAL     3 PLACE DECIMAL     ANGLES ±.015 (0.381 mm)     ±.005 (0.127 mm)     ± 1°	MATERIAL	DRAWN	DATE	TITLE MCX STR CRIMP PLUG TO MCX STR CRIMP PLUG USING RG 316 CABLE, VARIOUS LENGTH SCALE: 2.7:1.0   SHEET 2 OF 2	Amphenol RF www.amphenolrf.com
	SEE NOTES	RAJAGOPAL N	18-May-16		
NOTICE - These drawings, specifications, or other data (1) are, and remain the property of Amphenol corp. (2) must be returned upon request; and (3) are confidential and not to be disclosed to any person other than those to whom they are given by Amphenol Corp. the furnishing of these drawings, specifications, or other data by Amphenol Corp., or to any other person to anyone for any purpose is not to be regarded by implication or otherwise in any manner licensing, granting rights to permitting such holder or any other person to manufacture, use or sell any product, process or design, patented or otherwise, that may in any way be related to or disclosed by said drawings, specifications, or other data.	REFERENCE	ENGINEER	DATE	DRAWING NO. 255101-01-XX-XX ITEM NO. 255101-01-XX-XX	
	EAR # 7251	CLEMENT	19-May-10		
	CONFIGURATION LEVEL: In Work	APPROVED	DATE		PART NO. 255101-01-XX-XX
FINISH	K.CAPOZZI	30-Sep-16			
	CAD FILE			DWG SIZE	REV
				B	C