

No.	Changes and/or Note No.	Date	Sign	No.	Changes and/or Note No.	Date	Sign

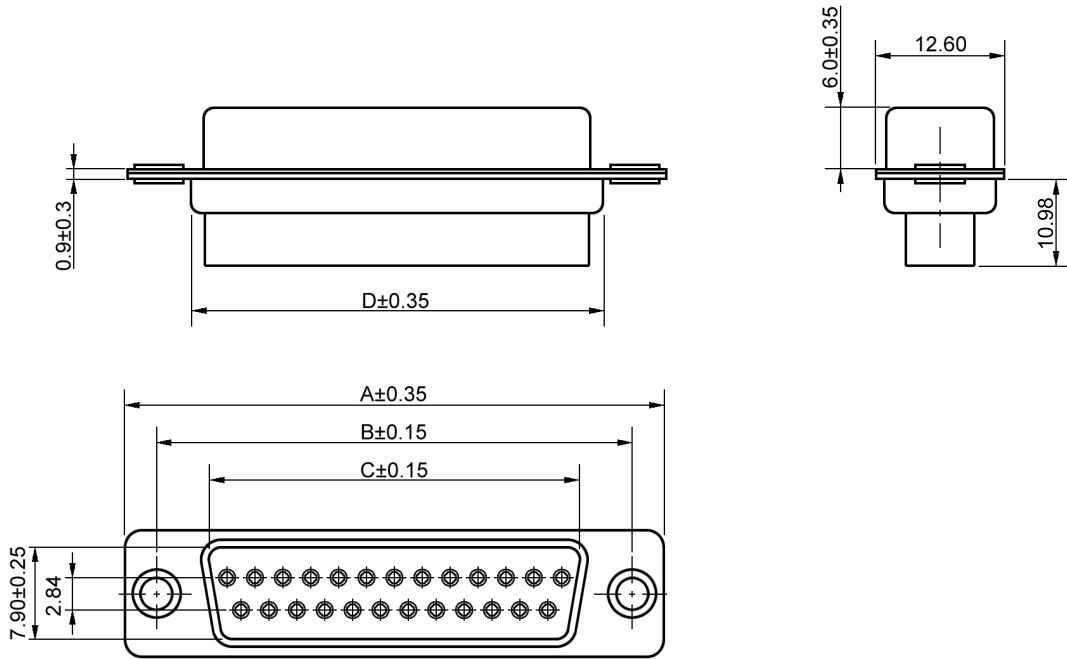

UNIT: (mm)

### DIMENSIONS

Size:	A	B	C	D	Part No:
09P	30.80	25.00	16.30	19.20	2101-0190-11
15P	39.15	33.30	24.60	27.70	2101-0190-12
25P	53.10	47.10	38.30	41.10	2101-0190-13
37P	69.40	63.50	54.80	57.30	2101-0190-14
50P	67.00	61.00	52.20	55.10	2101-0190-15

### MATERIAL SPECIFICATIONS:

Shell: Steel, Tin or Ni Plated (With Dimples)  
Zinc Plated (Without Dimples)  
Insulator: Glass Filled PBT, UL 94 V-0  
Rivet: Copper-Alloy, Ni Plated

### TECHNICAL SPECIFICATIONS:

Current Rating: 5 Amp Max.  
Contact Resistance: 15 mΩ Max.  
Insulator Resistance: 1000 MΩ Min.  
Test Voltage: 500V AC for 1 Minute  
Operating Temperature: -55°C to +105°C

DATE 2011-06-10	DRAWN MRR	SCALE	MATERIAL TYPE
	APPROVED		REPLACES



DBCxx-SS  
Sub-D Female, Crimp Housing

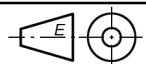

DRAWING No.

2101-0190-1x