

# GATE VALVE " SEAL F " SERIE

## DIMENSIONS

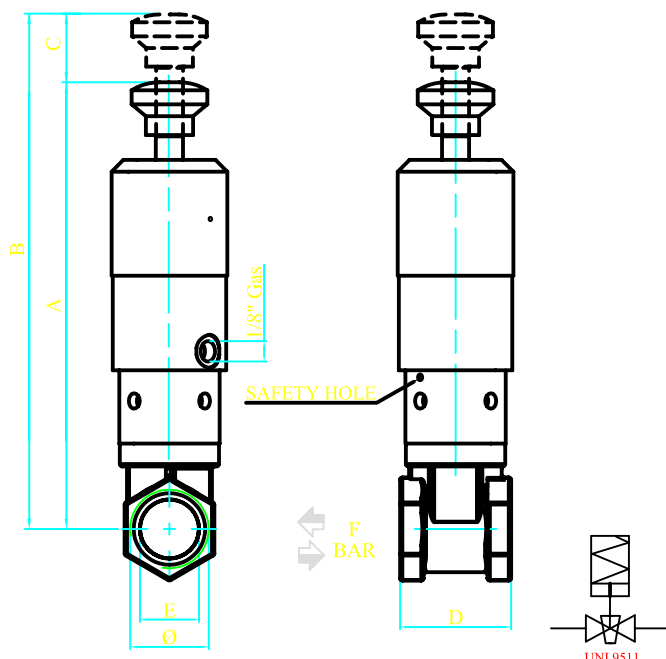

COD.	Ø	DIMENSIONS							Weight Kg
		A	B	C	D	E	F	G	
2573	3/4"	185	204.5	19.5	46	20	MAX 5		0.67
2542	1"	189.5	215.5	26	51	25	MAX 5		0.81
2501	1"1/4	200	230	30	55	32	MAX 5		1.25
2558	1"1/2	209	245.5	36.5	61	38	MAX 4		1.28
2528	2"	269.5	317	47.5	67	50	MAX 3		2.01

## SPARE PARTS

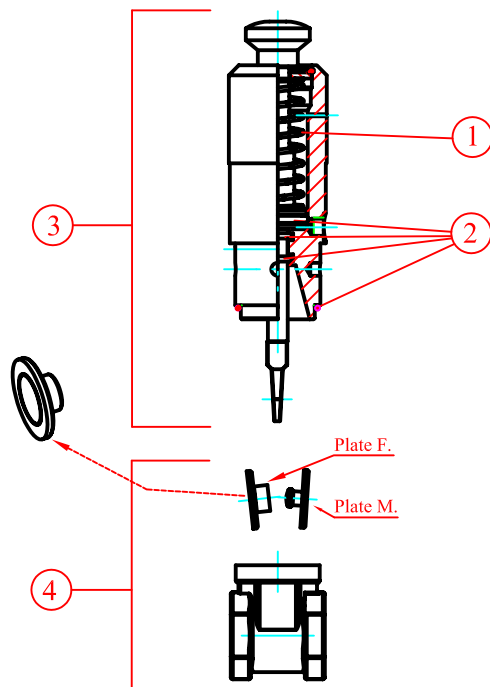

POS.	DESCRIPTION	SPARE PART FOR SIZE							
		3/4"	1"	1"1/4	1"1/2	2"	2"1/2	3"	4"
1	SPRING	112	184	184	361	129			
2	GASKET KIT	2374	2543	2502	2558	2529			
3	ACTUATOR	2576	2544	2504	2560	2531			
4	BODY GROUP	2575	2545	2503	2561	2530			

reserves the right to modify the valve without warning

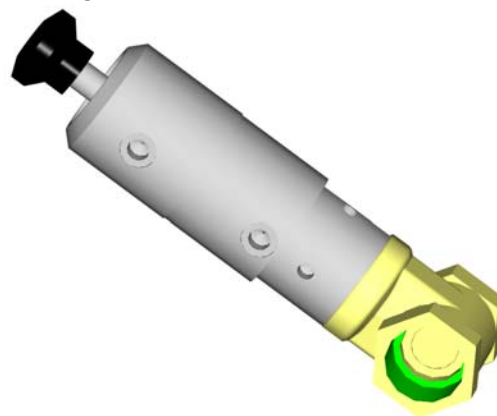

## Maintenance manual

### Application field

This valve can be used to intercept fluids and gas compatible with the valve material. Please refer to technical features "**Materials in contact with the product**".

This system makes the product economical, suitable where a minimum dripping is accepted.

The valve has a knob for a possible manual actioning, signalling also an "open or close" status.

### Installation

Connect the body valve on pipes with external threads "please refer to F BAR" dimensions.

Connect the working pressure in the proper threading of 1/8" Gas please refer to 1/8" Gas dimensions.

The valve threadings are only for what above described.

We advise to pack the threadings with liquid packing, or to use gaskets so that to avoid an excessive stress on the threadings when closing.

Everytime the actuator is unscrewed from the valve body "please refer to the spare parts" be sure the gasket is in good condition before assembling the valve again.

In case the valve intercepts a product which could sediment, it is advisable to positioning the valves on vertical pipes with the F plate "marked with a circle sign" above the M plate "please refer to spare parts".

Please avoid positioning the valve with the knob downwards so that to prevent solid sediments stagnations in contact with the gaskets.

### Maintenance

The valve has a safety hole signalling the possible bad functioning of the gaskets separating the actuator from the intercepted products.

Please check the efficiency of these O-Rings through the above-mentioned hole every 3000/4000 operations. If necessary, please proceed to replace them, please refer to the spare parts "**gaskets Kit**".

⚠ In case of maintenance, please pay attention when opening the cylinder as there is a **compressed spring** inside.

Be sure the valve is lubricated by the pneumatic system.

## Technical features

**Shutter type:** Plates on conical seat

**Threading:** GAS 55° UNI - ISO 228

**Room temperature range:** Min. 0°C; max. 100 °C

**Actuator working pressure range:** Min. 5 bar; max. 10 bar

**Actuator:** Single acting normally closed

**Cylinder material:** Alluminum 2011 alloy anodized

**Shaft material:** Stainless steel AISI 303

**Valve body material:** Brass OT-58

**Shutter material:** Brass OT-58

**Materials in contact with the product:** Brass 58, Alluminum 2011 alloy anodized, AISI 303 and NBR