

## MF30

-

## X

## X

## X

## 1

## X

-

## XX

**MF30 Series**  
3.0mm Pitch



**Type**  
S= SMT  
D= Dip  
H= Housing  
or Contact

**The body of wafer:**  
H= Horizontal  
V= Vertical  
**Housing:**  
M= Male  
F= Female  
**Terminal:**  
M= Male  
F= Female

**Wafer:**  
E= w/Ear tab  
C= w/Metal Clip  
P= w/Pags  
**Housing:**  
D= Housing  
**Terminal:**  
Blank

**Wafer:**  
Blank  
**Housing:**  
Blank  
**Terminal:**  
T= Tin plated

**No. of Positions**  
02~24

**MF30-DHP1**

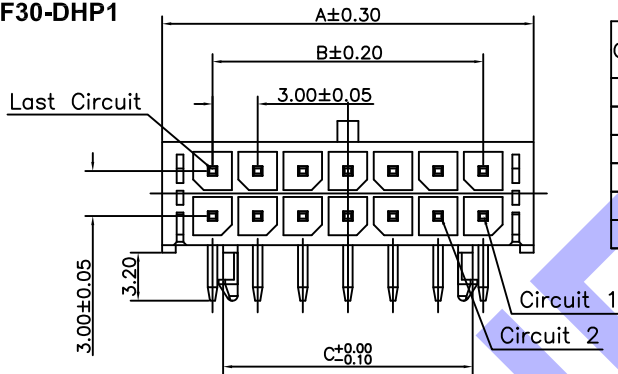

Circuits	Dimension			Circuits	Dimension		
	A	B	C		A	B	C
2	6.7	—	2.9	14	24.7	18.0	16.6
4	9.7	3.0	2.9	16	27.7	21.0	19.6
6	12.7	6.0	2.9	18	30.7	24.0	22.6
8	15.7	9.0	7.6	20	33.7	27.0	25.6
10	18.7	12.0	10.6	22	36.7	30.0	28.6
12	21.7	15.0	13.6	24	39.7	33.0	31.6

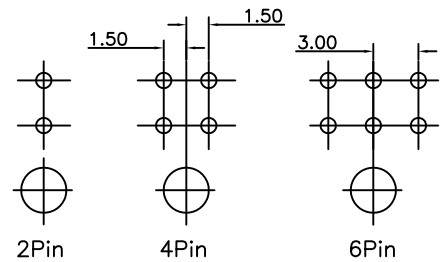
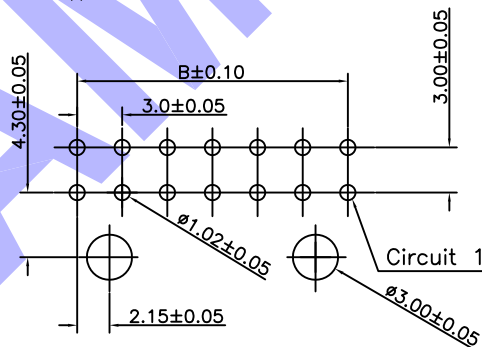
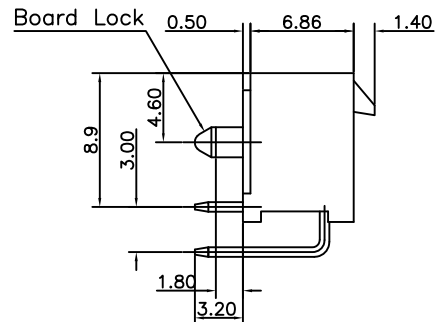
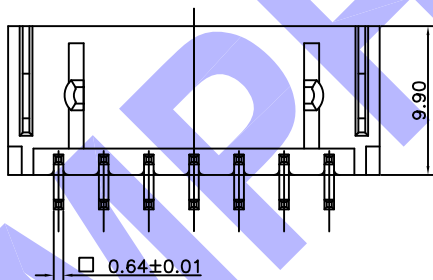

PCB Layout

## General Specification

### Materials and Finish:

**Insulator:** Glass-reinforce thermoplastic, UL 94V-0, Nylon 46, Color Black.  
**Contact:** Brass, Tin plated.

### Electrical:

**Contact Resistance:** 10 milliohms max. at 1A DC  
**Insulation Resistance:** 1000 MΩ min, at 500 V/DC.  
**Dielectric Withstanding Voltage:** 1500 V AC/RMS 60Hz for one minute.  
**Current Rating:** 5A AC, DC  
**Voltage Rating:** 250V AC/RMS 60Hz, DC

### Environment :

**Operating Temperature:** -25 degree C to +105 degree C

## MF30

## X

## X

## X

## 1

## X

## XX

**MF30 Series**  
3.0mm Pitch



**Type**  
S= SMT  
D= Dip  
H= Housing  
or Contact

**The body of wafer:**  
H= Horizontal  
V= Vertical  
**Housing:**  
M= Male  
F= Female  
**Terminal:**  
M= Male  
F= Female

**Wafer:**  
E= w/Ear tab  
C= w/Metal Clip  
P= w/Pags  
**Housing:**  
D= Housing  
**Terminal:**  
Blank

**Wafer:**  
Blank  
**Housing:**  
Blank  
**Terminal:**  
T= Tin plated

**No. of Positions**  
02~24

**MF30-DVP1**

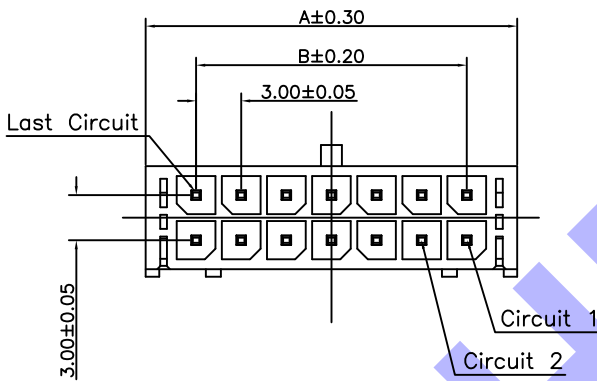

Circuits	Dimension		Circuits	Dimension	
	A	B		A	B
2	6.7	—	14	24.7	18.0
4	9.7	3.0	16	27.7	21.0
6	12.7	6.0	18	30.7	24.0
8	15.7	9.0	20	33.7	27.0
10	18.7	12.0	22	36.7	30.0
12	21.7	15.0	24	39.7	33.0

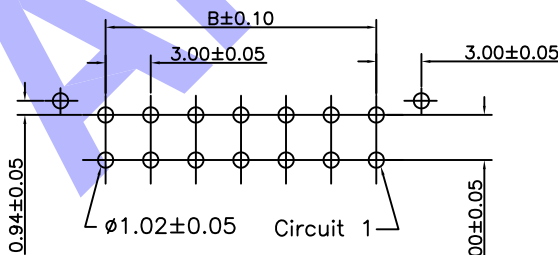
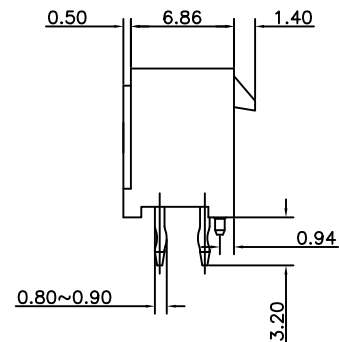
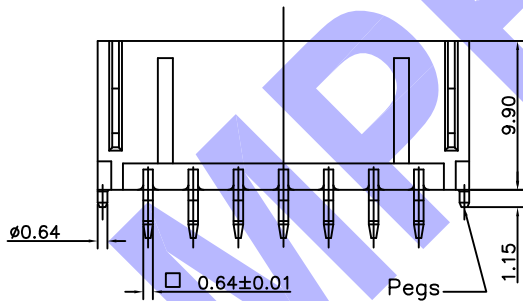

PCB Layout

## General Specification

### Materials and Finish :

**Insulator:** Glass-reinforce thermoplastic, UL 94V-0, Nylon 46, Color Black.

**Contact :** Brass, Tin plated.

### Electrical :

**Contact Resistance:** 10 mΩ max. at 1A DC

**Insulation Resistance:** 1000 MΩ min, at 500 V/DC.

**Dielectric Withstanding Voltage :** 1500 V AC/RMS 60Hz for one minute.

**Current Rating :** 5A AC, DC

**Voltage Rating :** 250V AC/RMS 60Hz, DC

### Environment :

**Operating Temperature:** -25 degree C to +105 degree C

## MF30

-

## X

## X

## X

## 1

## X

-

## XX

**MF30 Series**  
3.0mm Pitch



MF30-HFD1

**Type**  
S= SMT  
D= Dip  
H= Housing  
or Contact

**The body of wafer:**  
H= Horizontal  
V= Vertical  
**Housing:**  
M= Male  
F= Female  
**Terminal:**  
M= Male  
F= Female

**Wafer:**  
E= w/Ear tab  
C= w/Metal Clip  
P= w/Pags  
**Housing:**  
D= Housing  
**Terminal:**  
Blank

**Wafer:**  
Blank  
**Housing:**  
Blank  
**Terminal:**  
T= Tin plated

**No. of Positions**  
02~24

Poles	Dimension			Poles	Dimension		
	A	B	PCS/BAG		A	B	PCS/BAG
02	—	3.85	1,000	14	18.00	21.85	1,000
04	3.00	6.85	1,000	16	21.00	24.85	1,000
06	6.00	9.85	1,000	18	24.00	27.85	1,000
08	9.00	12.85	1,000	20	27.00	30.85	500
10	12.00	15.85	1,000	22	30.00	33.85	500
12	15.00	18.85	1,000	24	33.00	36.85	500

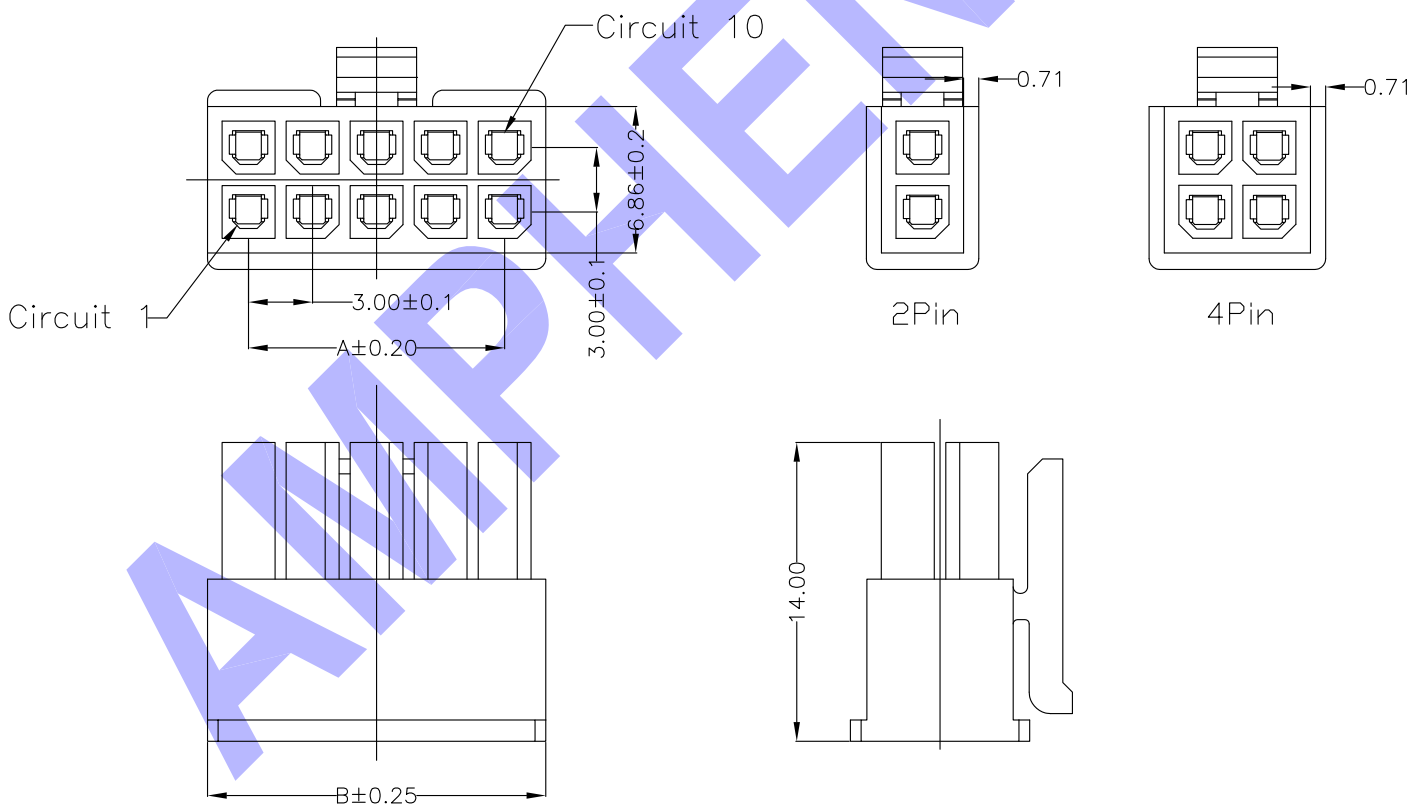

## General Specification

### Materials and Finish :

**Insulator:** Glass-reinforce thermoplastic, UL 94V-0, Nylon 66, Color Black.

### Electrical (after assembled with MF30-HF1T-XX):

**Contact Resistance:** 10 mΩ max. at 1A DC

**Insulation Resistance:** 1000 MΩ min, at 500 V/DC.

**Dielectric Withstanding Voltage :** 1500 V AC/RMS 60Hz for one minute.

**Current Rating :** 5A AC, DC

**Voltage Rating :** 250V AC/RMS 60Hz, DC

### Environment :

**Operating Temperature:** -25 degree C to +105 degree C

## MF30

## X

## X

## X

## 1

## X

## XX

**MF30 Series**  
3.0mm Pitch



MF30-HF1T

**Type**  
S= SMT  
D= Dip  
H= Housing  
or Contact

**The body of wafer:**  
H= Horizontal  
V= Vertical  
**Housing:**  
M= Male  
F= Female  
**Terminal:**  
M= Male  
F= Female

**Wafer:**  
E= w/Ear tab  
C= w/Metal Clip  
P= w/Pags  
**Housing:**  
D= Housing  
**Terminal:**  
Blank

**Wafer:**  
Blank  
**Housing:**  
Blank  
**Terminal:**  
T= Tin plated

**No. of Positions**  
02~24

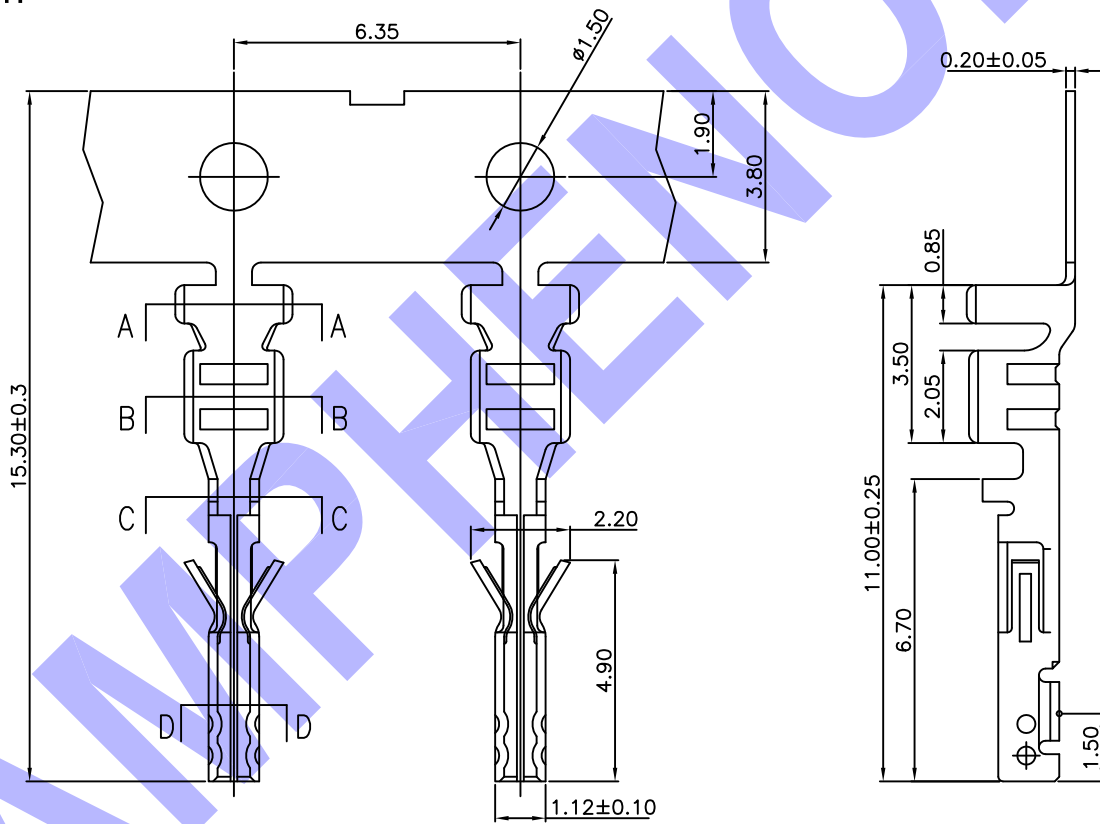

Part No.	M
MF30-HF1T	0.59
MF30-HF1T-A	0.54

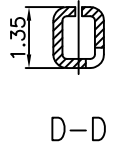
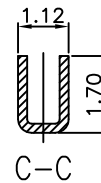
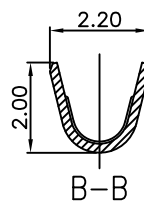
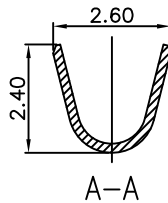
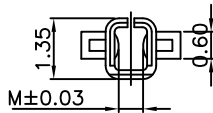

## General Specification

### Materials and Finish :

**Contact :** Phosphor Bronze  
**Finish:** Tin plated  
Application Wires: AWG# 20~24

### Electrical (after assembled with MF30-HFD1-XX):

**Contact Resistance:** 10 mΩ max. at 1A DC  
**Insulation Resistance:** 1000 MΩ min, at 500 V/DC.  
**Dielectric Withstanding Voltage :** 1500 V AC/RMS 60Hz for one minute.  
**Current Rating :** 5A AC, DC  
**Voltage Rating :** 250V AC/RMS 60Hz, DC

### Environment :

**Operating Temperature:** -25 degree C to +85 degree C

## MF30

## X

## X

## X

## 1

## X

## XX

**MF30 Series**  
3.0mm Pitch



**MF30-HMD1**

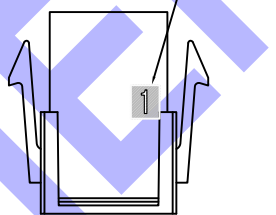
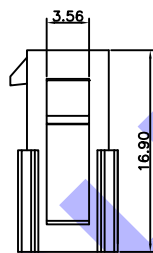
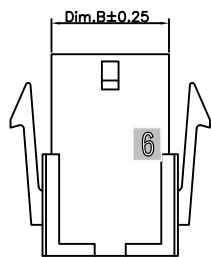
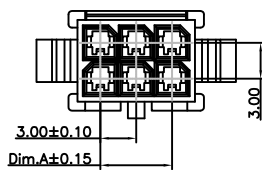

Circuits	Dim.A	Dim.B	Dim.C	Dim.D
2		3.85	4.21	7.90
4	3.00	6.85	7.21	10.90
6	6.00	9.85	10.21	13.89
8	9.00	12.85	13.21	16.89
10	12.00	15.85	16.21	19.89
12	15.00	18.85	19.21	22.89
14	18.00	21.82	22.21	25.88
16	21.00	24.85	25.21	28.88
18	24.00	27.85	28.21	31.88
20	27.00	30.85	31.21	34.87
22	30.00	33.85	34.21	37.87
24	33.00	36.85	37.21	40.87

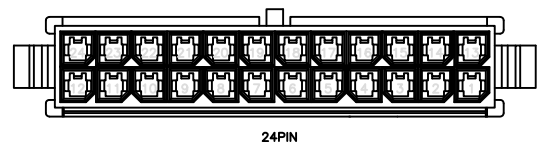
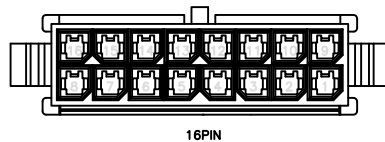
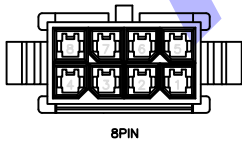
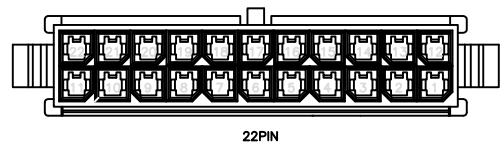
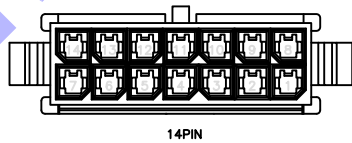
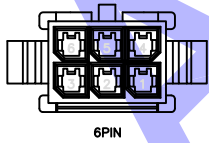
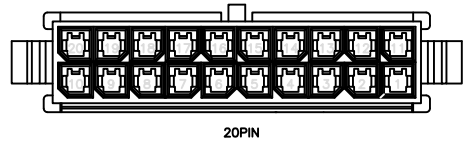
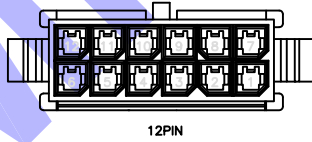
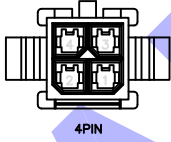
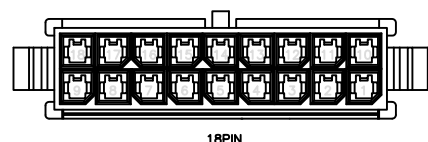
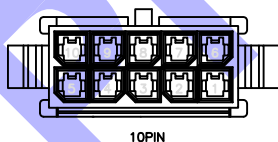
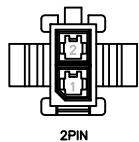

## General Specification

### Materials and Finish :

**Insulator:** Glass-reinforce thermoplastic, UL 94V-0, Nylon 66, Color Black.

### Electrical (after assembled with MF30-HM1T-XX):

**Contact Resistance:** 10 mΩ max. at 1A DC

**Insulation Resistance:** 1000 MΩ min, at 500 V/DC.

**Dielectric Withstanding Voltage :** 1500 V AC/RMS 60Hz for one minute.

**Current Rating :** 5A AC, DC

**Voltage Rating :** 250V AC/RMS 60Hz, DC

### Environment :

**Operating Temperature:** -25 degree C to +105 degree C



### MF30

### X

### X

### X

### 1

### X

### XX

**MF30 Series**  
3.0mm Pitch



**Type**  
S= SMT  
D= Dip  
H= Housing  
or Contact

**The body of wafer:**  
H= Horizontal  
V= Vertical  
**Housing:**  
M= Male  
F= Female  
**Terminal:**  
M= Male  
F= Female

**Wafer:**  
E= w/Ear tab  
C= w/Metal Clip  
P= w/Pags  
**Housing:**  
D= Housing  
**Terminal:**  
Blank

**Wafer:**  
Blank  
**Housing:**  
Blank  
**Terminal:**  
T= Tin plated

**No. of Positions**  
02~24

MF30-SHC1

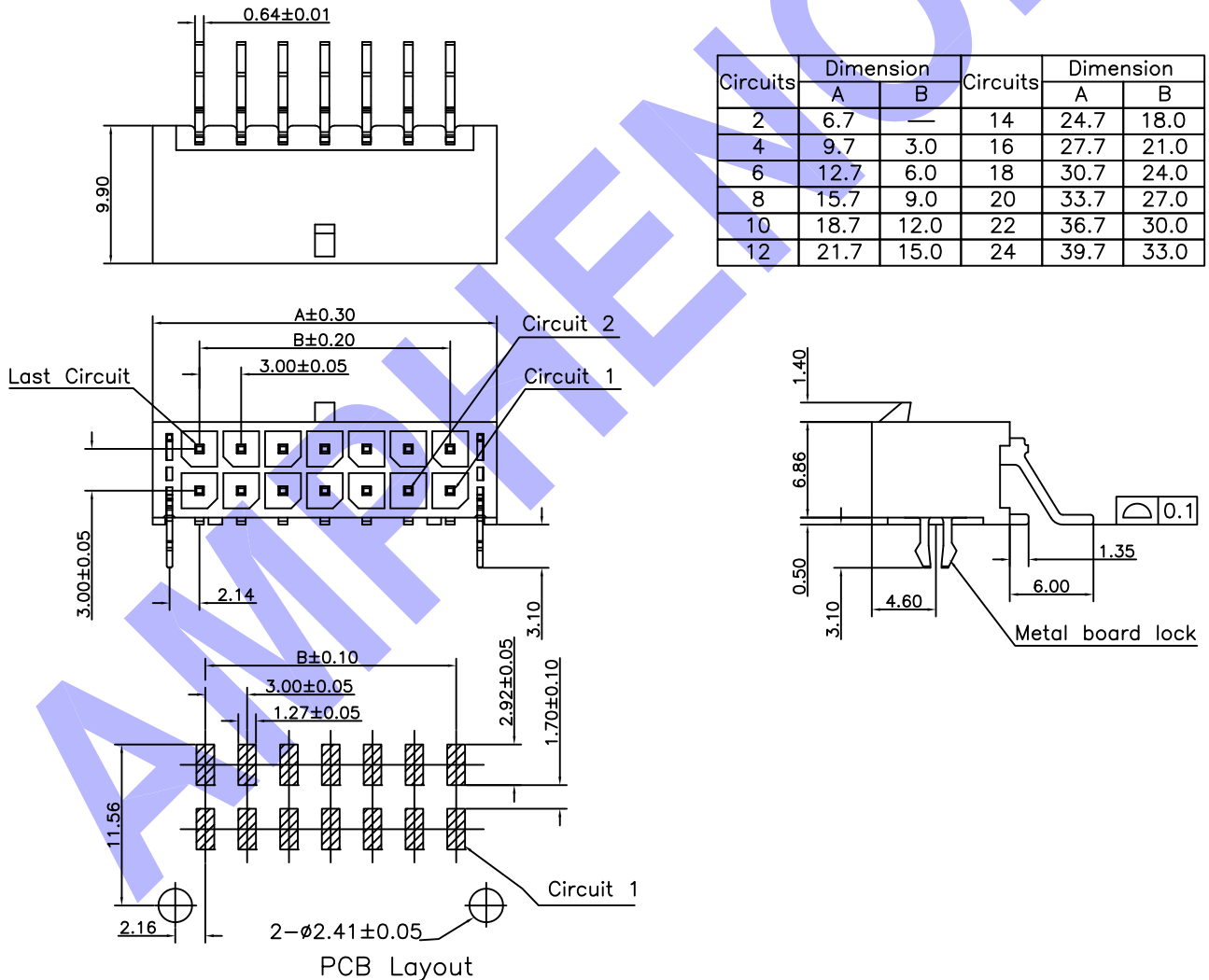

## General Specification

### Materials and Finish :

**Insulator:** Glass-reinforce thermoplastic, UL 94V-0, Nylon 46, Color Black.

**Contact :** Brass, Tin plated.

### Electrical (after assembled with MF30-HM1T-XX):

**Contact Resistance:** 10 mΩ max. at 1A DC

**Insulation Resistance:** 1000 MΩ min, at 500 V/DC.

**Dielectric Withstanding Voltage :** 1500 V AC/RMS 60Hz for one minute.

**Current Rating :** 5A AC, DC

**Voltage Rating :** 250V AC/RMS 60Hz, DC

### Environment :

**Operating Temperature:** -25 degree C to +105 degree C

## MF30

MF30 Series  
3.0mm Pitch



## X

**Type**  
S= SMT  
D= Dip  
H= Housing  
or Contact

## X

**The body of wafer:**  
H= Horizontal  
V= Vertical  
**Housing:**  
M= Male  
F= Female  
**Terminal:**  
M= Male  
F= Female

## X

**Wafer:**  
E= w/Ear tab  
C= w/Metal Clip  
P= w/Pags  
**Housing:**  
D= Housing  
**Terminal:**  
Blank

## 1

## X

**Wafer:**  
Blank  
**Housing:**  
Blank  
**Terminal:**  
T= Tin plated

## XX

**No. of Positions**  
02~24

MF30-SHE1

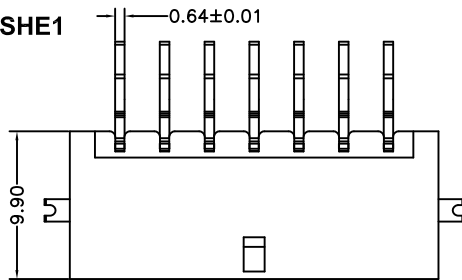

Circuits	Dimension		Circuits	Dimension	
	A	B		A	B
2	6.7	—	14	24.7	18.0
4	9.7	3.0	16	27.7	21.0
6	12.7	6.0	18	30.7	24.0
8	15.7	9.0	20	33.7	27.0
10	18.7	12.0	22	36.7	30.0
12	21.7	15.0	24	39.7	33.0

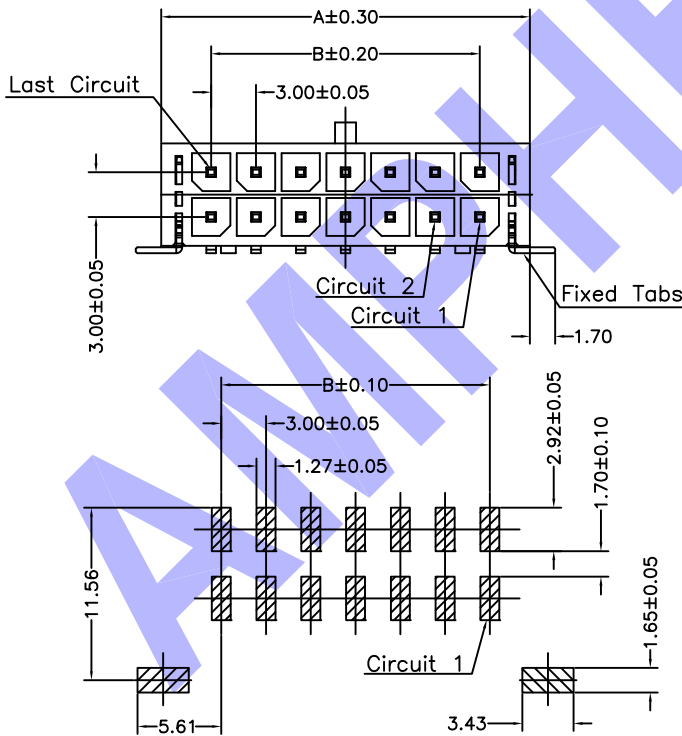

PCB Layout

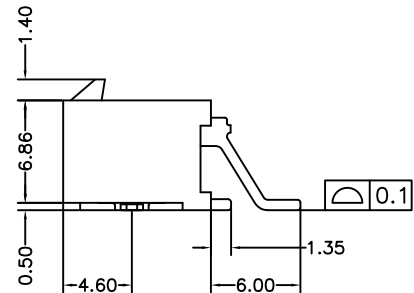

## General Specification

### Materials and Finish :

**Insulator:** Glass-reinforce thermoplastic, UL 94V-0, Nylon 46, Color Black.

**Contact :** Brass, Tin plated.

### Electrical :

**Contact Resistance:** 10 mΩ max. at 1A DC

**Insulation Resistance:** 1000 MΩ min, at 500 V/DC.

**Dielectric Withstanding Voltage :** 1500 V AC/RMS 60Hz for one minute.

**Current Rating :** 5A AC, DC

**Voltage Rating :** 250V AC/RMS 60Hz, DC

### Environment :

**Operating Temperature:** -25 degree C to +105 degree C





## MF30

MF30 Series  
3.0mm Pitch



MF30-SVC1

**X** **X** **X**

**Type**  
S= SMT  
D= Dip  
H= Housing  
or Contact

**The body of wafer:**  
H= Horizontal  
V= Vertical  
**Housing:**  
M= Male  
F= Female  
**Terminal:**  
M= Male  
F= Female

**Wafer:**  
E= w/Ear tab  
C= w/Metal Clip  
P= w/Pags  
**Housing:**  
D= Housing  
**Terminal:**  
Blank

1

**X**

**XX**

**Wafer:**  
Blank  
**Housing:**  
Blank  
**Terminal:**  
T= Tin plated

**No. of Positions**  
02~24

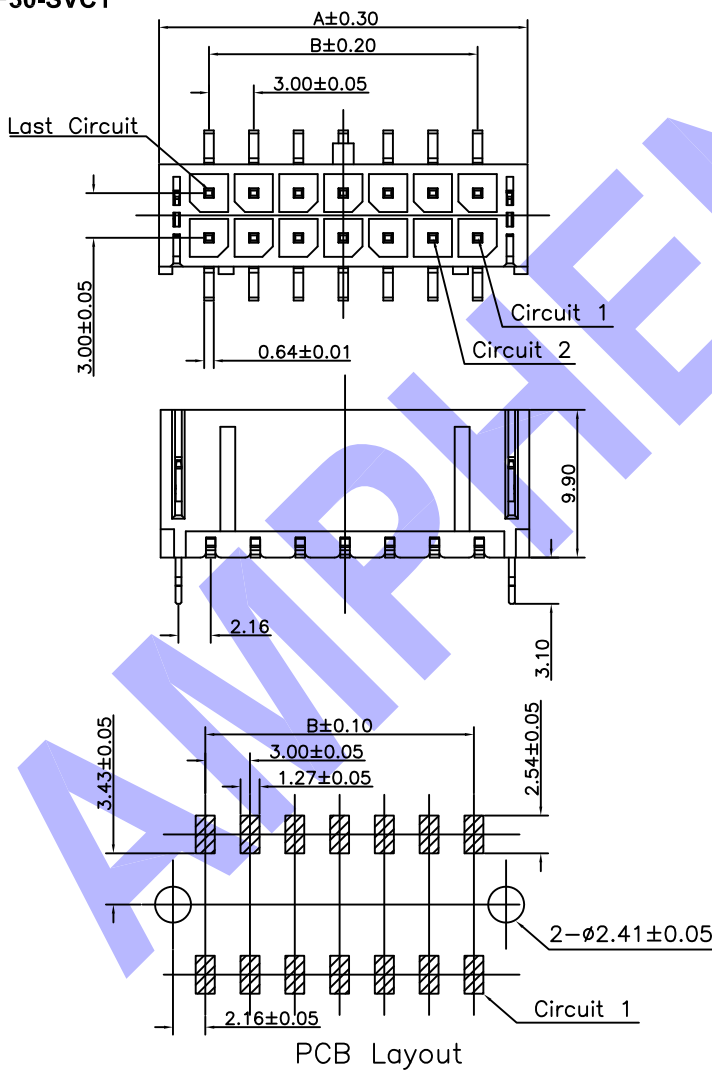

Circuits	Dimension		Circuits	Dimension	
	A	B		A	B
2	6.7	—	14	24.7	18.0
4	9.7	3.0	16	27.7	21.0
6	12.7	6.0	18	30.7	24.0
8	15.7	9.0	20	33.7	27.0
10	18.7	12.0	22	36.7	30.0
12	21.7	15.0	24	39.7	33.0

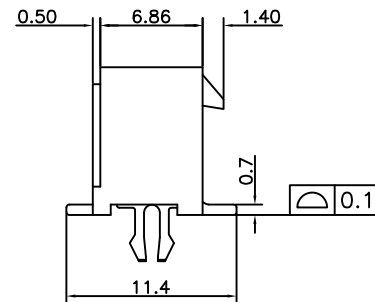

## General Specification

### Materials and Finish :

**Insulator:** Glass-reinforce thermoplastic, UL 94V-0, Nylon 46, Color Black.

**Contact :** Brass, Tin plated.

### Electrical :

**Contact Resistance:** 10 mΩ max. at 1A DC

**Insulation Resistance:** 1000 MΩ min, at 500 V/DC.

**Dielectric Withstanding Voltage :** 1500 V AC/RMS 60Hz for one minute.

**Current Rating :** 5A AC, DC

**Voltage Rating :** 250V AC/RMS 60Hz, DC

### Environment :

**Operating Temperature:** -25 degree C to +105 degree C

## MF30

MF30 Series  
3.0mm Pitch

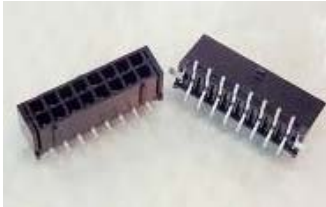

MF30-SVE1

**X** **X** **X**

**Type**  
S= SMT  
D= Dip  
H= Housing  
or Contact

**The body of wafer:**  
H= Horizontal  
V= Vertical  
**Housing:**  
M= Male  
F= Female  
**Terminal:**  
M= Male  
F= Female

**Wafer:**  
E= w/Ear tab  
C= w/Metal Clip  
P= w/Pags  
**Housing:**  
D= Housing  
**Terminal:**  
Blank

1

**X**

**Wafer:**  
Blank  
**Housing:**  
Blank  
**Terminal:**  
T= Tin plated

**XX**

**No. of Positions**  
02~24

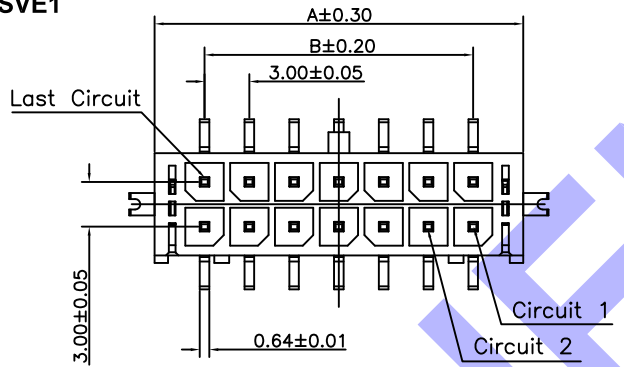

Circuits	Dimension		Circuits	Dimension	
	A	B		A	B
2	6.7	—	14	24.7	18.0
4	9.7	3.0	16	27.7	21.0
6	12.7	6.0	18	30.7	24.0
8	15.7	9.0	20	33.7	27.0
10	18.7	12.0	22	36.7	30.0
12	21.7	15.0	24	39.7	33.0

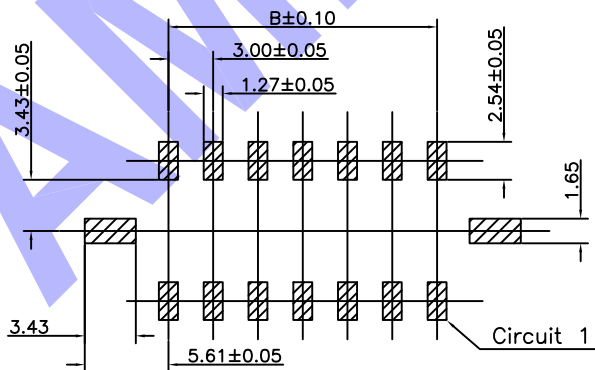
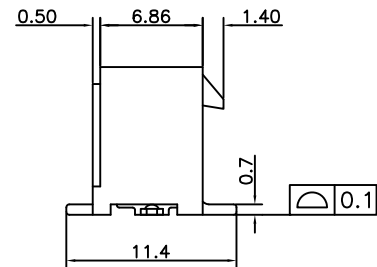
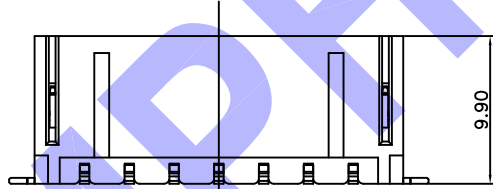

PCB Layout

## General Specification

### Materials and Finish :

**Insulator:** Glass-reinforce thermoplastic, UL 94V-0, Nylon 46, Color Black.

**Contact :** Brass, Tin plated.

### Electrical :

**Contact Resistance:** 10 mΩ max. at 1A DC

**Insulation Resistance:** 1000 MΩ min, at 500 V/DC.

**Dielectric Withstanding Voltage :** 1500 V AC/RMS 60Hz for one minute.

**Current Rating :** 5A AC, DC

**Voltage Rating :** 250V AC/RMS 60Hz, DC

### Environment :

**Operating Temperature:** -25 degree C to +105 degree C