

DIL SOCKETS „THROUGH HOLE“
ID: 002 MP(g) closed

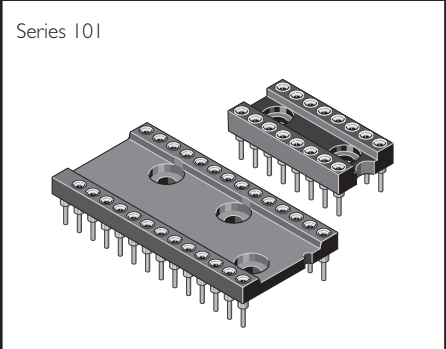

TECHNICAL DATA

Pitch	2,54 mm
Insulating Material	high temp. thermoplast UL94V-0
Contact Material	Brass/BeCu
Rated Current	1 Amp.
Rated Voltage	100 V _{RMS} /150 V _{DC}
Breakdown Voltage	min. 1000 V _{RMS}
Operating Temperature	-55°C bis +125°C
Maximum Soldering Temperature	260°C for 10 seconds

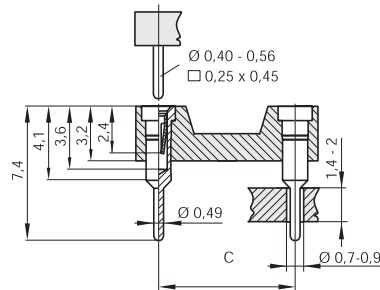
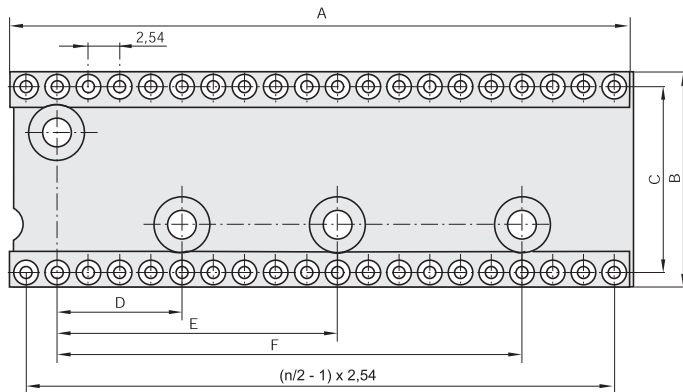

Code	Poles	A	B	C	D	E	F
06.3	6	7,60	10,08	7,62	-	-	-
08.3	8	10,08	10,08	7,62	-	-	-
14.3	14	17,70	10,08	7,62	10,16	-	-
16.3	16	20,24	10,08	7,62	12,70	-	-
18.3	18	22,78	10,08	7,62	15,24	-	-
20.3	20	25,32	10,08	7,62	17,78	-	-
24.3	24	30,40	10,08	7,62	22,86	-	-
24.6	24	30,40	17,70	15,24	10,16	22,86	-
28.6	28	35,48	17,70	15,24	10,16	22,86	-
32.6	32	40,56	17,70	15,24	10,16	22,86	-
40.6	40	50,72	17,70	15,24	10,16	22,86	38,10

All dimensions in mm.
 Other dimensions upon request.

MP(g) XX.Y SXX U

Code: see table

- XX: TG B = sleeve: Sn/clip: Au
- GG B = sleeve: Au/clip: Au
- TG B w = brass pin - for autom. assembly
- TG B OM = without center bar
- TG B 6FC = with 6-finger clip for lower insertion- and withdrawal forces
- TG B 8 = sleeve: Sn/clip: 0,75µm Au

U: RoHS-compliant with high temp. plastic