

## Hexagonal locknut

2xx MPOT

### Configuration

Hexagonal locknut	Brass CuZn39Pb3, nickel-plated
Internal thread	Pg as per DIN 40430

### Properties

	<ul style="list-style-type: none"> <li>• with cutting edges</li> <li>• for secure tightening of EMC-cable glands,</li> <li>• to cut through paint layers or powder coatings ensuring optimal contact for equipotential bonding,</li> <li>• increased vibration resistance</li> </ul>
Temperature range	-60°C +200°C

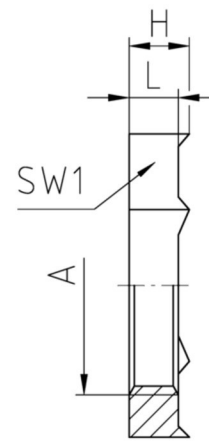
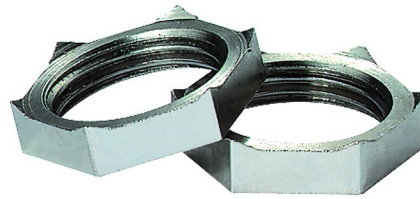

### Features

with cutting edges

A	L	SW1	H		Part No.
	mm	mm	mm	Piece	
Pg 7	3,7	15	4,7	100	207 MPOT
Pg 9	3,7	18	4,7	100	209 MPOT
Pg 11	3,7	21	4,7	100	211 MPOT
Pg 13,5	3,7	23	4,7	100	213 MPOT
Pg 16	3,7	26	4,7	100	216 MPOT
Pg 21	4,2	32	5,2	100	221 MPOT
Pg 29	4,7	41	5,7	100	229 MPOT
Pg 36	5	51	6	50	236 MPOT
Pg 42	5	60	6	50	242 MPOT
Pg 48	5,5	64	6,5	50	248 MPOT